

**CALIFORNIA ENERGY COMMISSION**

1516 NINTH STREET  
 SACRAMENTO, CA 95814-5512  
 www.energy.ca.gov



<b>DOCKET</b>	
<b>09-AFC-3</b>	
DATE	NOV 09 2010
RECD	NOV 10 2010

November 9, 2010

Dear Librarian:

**DOCUMENT HANDLING FOR THE MARIPOSA ENERGY PROJECT (09-AFC-3) and  
 POSTING OF PUBLIC NOTICE**

The enclosed Staff Assessment (SA) contains the California Energy Commission staff's engineering and environmental evaluation of the proposed Mariposa Energy Project. Please make this SA available for those who may wish to be informed about the project. We request that you not allow the SA or any of its contents to be removed from the library. To increase accessibility of the document, we ask, if possible, that you cross reference it as a general reference work under the title and author categories, as well as under such subjects as "Energy Commission," "electricity energy/generation," "power plant siting," or any other relevant subject. Please retain the enclosed letter to the public behind the front cover of the SA.

The Energy Commission's siting process is open to the public and incorporates the input of the public as well as local, state and federal agencies. To facilitate public participation in our review process, the Commission distributes copies of staff documents such as the SA to public libraries in communities near the proposed project, and in major cities throughout the state. As such, please retain a copy of the enclosed Notice of Availability / Notice of Public Workshop behind the front cover of the SA and also post a copy of the Public Notice in a place conspicuous and accessible to those members of the general public who visit the library.

Thank you for your cooperation. If you have any questions, please contact Craig Hoffman, Siting Project Manager, at (916) 654-4781 or at the address on this letterhead or by email to [choffman@energy.state.ca.us](mailto:choffman@energy.state.ca.us).

Sincerely,

Original Signed

TERRENCE O'BRIEN, Deputy Director  
 Siting, Transmission and Environmental  
 Protection Division

Enclosure

Mailed to list:  
 7288 - Library

PROOF OF SERVICE (REVISED 10/20/10) FILED WITH  
 ORIGINAL MAILED FROM SACRAMENTO ON 11/10/10

HA

**CALIFORNIA ENERGY COMMISSION**

1516 NINTH STREET  
SACRAMENTO, CA 95814-5512  
www.energy.ca.gov



November 9, 2010

**NOTICE OF AVAILABILITY  
STAFF ASSESSMENT FOR THE PROPOSED  
MARIPOSA ENERGY PROJECT  
(09-AFC-3)**

**NOTICE OF PUBLIC WORKSHOPS**

**Monday, November 29, 2010  
Beginning at 1:00 pm**

**Byron Bethany Irrigation District  
7995 Bruns Road,  
Byron, California, 94514  
Wheelchair Accessible  
(Map Attached)**

**To participate in the meeting by telephone,  
please call: 800-779-2609 (toll-free in the U.S. and Canada)  
Enter passcode: 53851**

TO: MEMBERS OF THE PUBLIC

This notice is to inform you of the availability of the Staff Assessment (SA) for the Mariposa Energy Project Application for Certification (09-AFC-3). The SA was published on **November 8, 2010**. The SA contains the California Energy Commission staff's engineering and environmental evaluation of the proposed Mariposa Energy Project.

**Purpose of the Public Workshop**

The Energy Commission staff will hold a workshop to discuss the SA and to further encourage public participation, regarding the proposed Mariposa Energy Project and the Energy Commission's permitting process. The workshop will provide an opportunity for agencies, the public and other interested parties to present questions and comments on the SA. All interested agencies and members of the public are invited to participate. **The workshop will be held on Monday, November 29, 2010 starting at 1:00 pm in Byron, California at the Byron Bethany Irrigation District headquarters.**

Based on the workshop dialogue, written comments received regarding the SA, and additional information that will be gathered, the Energy Commission staff will revise the SA where appropriate and issue a Supplemental Staff Assessment (SSA).

### **Public Comments**

The California Energy Commission encourages public and agency participation in the review of the Mariposa Energy Project Application for Certification (09-AFC-3). The public comment period for this SA is from **Tuesday November 9, 2010 to Thursday, December 9, 2010**. Written comments on the SA should be provided to Craig Hoffman, Siting Project Manager, no later than **5:00 p.m., Thursday, December 9, 2010** at the address on this letterhead or by email to [choffman@energy.state.ca.us](mailto:choffman@energy.state.ca.us). Technical or project schedule questions should be directed to Craig Hoffman at (916) 654-4781 or by email.

Following a 30-day public comment period on the Staff Assessment, a Supplemental Staff Assessment will be prepared and published based on Staff Assessment workshops and written comments. Staff may refine its analysis, correct errors, and finalize conditions of certification to reflect areas where agreements have been reached with the parties. The SSA will be a limited document representing revisions and additions rather than a document including each technical section.

The Staff Assessment and Supplemental Staff Assessment will serve as staff's formal written testimony in evidentiary hearings to be held by the Energy Commission Committee assigned to hear this case. The Committee will hold evidentiary hearings and will consider the testimonies presented by staff, applicant, interveners and comments from government agencies and the public prior to preparing the Presiding Member's Proposed Decision (PMPD), which will also have a 30-day comment period. The revised PMPD will then be considered by the full Energy Commission which will issue the final decision.

### **Summary of the proposed Mariposa Energy Project**

#### **Project Location**

The proposed project site is in northeastern Alameda County, in an unincorporated area designated for Large Parcel Agriculture by the East County Area Plan. The site is located approximately 7 miles northwest of Tracy, 7 miles east of Livermore, 6 miles south of Byron, and approximately 2.5 miles west of the community of Mountain House in San Joaquin County.

The facility would be located southeast of the intersection of Bruns Road and Kelso Road on a 10-acre portion of a 158-acre parcel (known as the Lee Property) immediately south of the Pacific Gas and Electric Company (PG&E) Bethany Compressor Station and 230-kilovolt (kV) PG&E Kelso Substation. The proposed power plant site is located in the southern portion of the Lee Property. The existing, unrelated 6.5 MW Byron Power Cogeneration Plant occupies 2 acres of the 158-acre parcel northeast of the MEP site. The remainder of the parcel is non-irrigated grazing land.

## **Project Description**

The MEP would be a natural gas-fired, simple cycle peaking facility with a generating capacity of 200-megawatts (MW). The project proposes to operate on average, 600 hours per year, but if licensed can run up to 4,000 hours per year. Primary equipment for the generating facility would include four General Electric (GE) LM6000 PC-Sprint natural gas-fired combustion turbine generators (CTG) and associated equipment. Power would be transmitted to the grid at 230-kV through a new 0.7-mile transmission line that would connect to the existing Kelso Substation. A new 580-foot natural gas pipeline would connect the project site to PG&E's Line 2, which is an existing high-pressure natural gas pipeline located northeast of the project site. Service and process water would be fresh irrigation water provided from a new connection to the Byron Bethany Irrigation District (BBID) via a new pump station and 1.8-mile pipeline. The MEP is proposing to utilize on average 35 acre feet of water per year. In the event of continuous and maximum permitted operation, the MEP would utilize 187 acre feet of water for 4,000 hours of operation. All domestic wastewater would be routed to an onsite septic system and either discharged to an onsite leach field or removed via truck for offsite disposal. Stormwater runoff would be detained onsite in an extended detention basin and released according to regulatory standards for stormwater quality control. Air emissions control systems would include a selective catalytic reduction (SCR) system for nitrogen oxides (NOx) control using 19 percent aqueous ammonia and an oxidation catalyst for carbon monoxide (CO) control.

Temporary construction facilities would include a 9.2-acre worker parking and laydown area immediately east of the project site, a 1-acre water supply pipeline parking and laydown area located at the BBID headquarters facility, to serve water pipeline construction needs, and a 0.6-acre laydown area along the transmission line route.

Construction of the generating facility, from site preparation and grading to commercial operation, is expected to take place from mid 2011 to July 2012.

The applicant has a power purchase agreement with PG&E.

## **Summary of the California Energy Commission Staff's Conclusions**

Based upon the information provided to date and the analysis completed to date for each technical section, staff has concluded that with implementation of staff's recommended mitigation measures described in the conditions of certification, all potential environmental impacts will be mitigated to a less than significant level with the exception of Biological Resources and Transmission System Engineering. The project analysis complies with the requirements of the California Environmental Quality Act (CEQA). For a detailed review of potentially significant impacts and the related mitigation measures, please refer to the analysis in the SA.

Staff also concludes that with implementation of staff's recommended mitigation measures described in the conditions of certification, the project would comply with all applicable

laws, ordinances, regulations, and standards (LORS), with the exception of **Biological Resources** and **Transmission System Engineering** where additional analysis is needed.

### **Energy Commission Licensing Authority**

The Energy Commission is responsible for reviewing and ultimately approving or denying all applications for construction and operation of thermal electric power plants, 50 MW and greater, proposed for construction in California. The Energy Commission's facility certification process carefully examines public health and safety, environmental impacts and engineering aspects of proposed power plants, and all related facilities such as electric transmission lines and natural gas and water pipelines. The Energy Commission is the lead agency under the California Environmental Quality Act (CEQA), and produces several environmental and decision documents rather than an Environmental Impact Report.

### **Public Resources, Contact Information and Additional Sources for Information**

If you desire information on how to participate in the Energy Commission's review of the proposed project, please contact Jennifer Jennings, the Energy Commission's Public Adviser, at (916) 654-4489 or toll free in California at (800) 822-6228, or by email at: [publicadviser@energy.state.ca.us](mailto:publicadviser@energy.state.ca.us).

To request special accommodations for those persons with disabilities, please contact Lourdes Quiroz, at [lquiroz@energy.state.ca.us](mailto:lquiroz@energy.state.ca.us) or by telephone (916) 654-5146. For those persons with limited English knowledge, request interpreter services by contacting the Project Manager, Craig Hoffman, at (916) 654-4781.

The status of the project, an electronic copy of the AFC and SA, copies of notices, and other relevant documents are also available on the Energy Commission's web site at: <http://www.energy.ca.gov/sitingcases/mariposa>.

News media inquiries should be directed to Assistant Director, Susanne Garfield, at (916) 654-4989, or by email at: [mediaoffice@energy.state.ca.us](mailto:mediaoffice@energy.state.ca.us).

The SA will be available for review at the following local libraries:

Mountain House Branch Library  
579 Wicklund Crossing  
Mountain House, CA 95391

Tracy Public Library  
20 E Eaton Ave  
Tracy, CA 95376

Livermore Public Library  
1188 S. Livermore Avenue  
Livermore, CA 94550

San Joaquin County Library  
605 North El Dorado Street  
Stockton, CA 95202

November 9, 2010

Page 5

Brentwood Library  
751 3<sup>rd</sup> St.  
Brentwood, CA 94513

Fremont Main Library  
2400 Stevenson Blvd.  
Fremont, CA 94538

Copies are also available at the Energy Commission's Library in Sacramento, the California State Library in Sacramento, and at public libraries in Eureka, San Francisco, Los Angeles, Fresno, and San Diego. In addition, this information has been shared with those public agencies that would normally have jurisdiction but for the Energy Commission's exclusive authority to certify sites and related facilities.

If you would like a paper copy or CD of the SA, please fill out the enclosed form and return it to California Energy Commission, Attention: Hilarie Anderson, Siting Project Assistant, at (916) 651-0479, or by e-mail at [handerson@energy.state.ca.us](mailto:handerson@energy.state.ca.us).

Sincerely,

Date:

---

TERRENCE O'BRIEN, Deputy Director  
Siting, Transmission and Environmental  
Protection Division

**Note: Please retain a copy of this Public Notice behind the front cover of the Staff Assessment (SA) and post a copy of the Public Notice in a place conspicuous and accessible to those members of the general public who visit the library. Thank You.**

**SA WORKSHOP FOR MARIPOSA ENERGY PROJECT (09-AFC-3)**

**NOTICE OF PUBLIC WORKSHOP**  
**Monday, November 29, 2010**  
**Starting at 1:00 pm**

**Byron Bethany Irrigation District**  
**7995 Bruns Road,**  
**Byron, California, 94514**

**(Wheelchair Accessible)**

**To participate in the meeting by telephone,**  
**please call: 800-779-2609 (toll-free in the U.S. and Canada)**  
**Enter passcode: 53851**

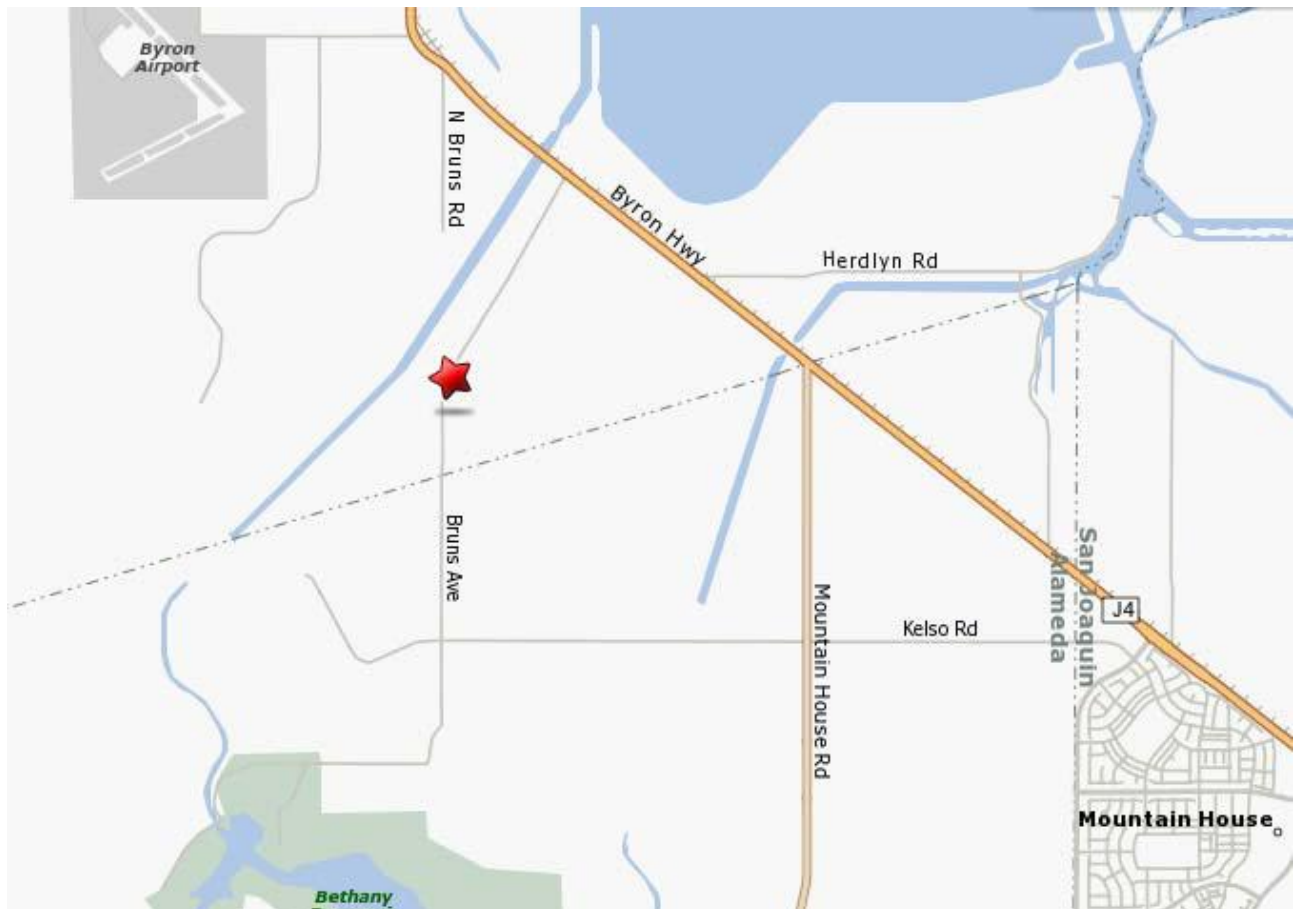



BEFORE THE ENERGY RESOURCES CONSERVATION AND DEVELOPMENT  
COMMISSION OF THE STATE OF CALIFORNIA  
1516 NINTH STREET, SACRAMENTO, CA 95814  
1-800-822-6228 – [WWW.ENERGY.CA.GOV](http://WWW.ENERGY.CA.GOV)

APPLICATION FOR CERTIFICATION  
FOR THE *MARIPOSA ENERGY PROJECT*  
(MEP)

*Docket No. 09-AFC-3*

**PROOF OF SERVICE**  
(Revised 10/20/2010)

**APPLICANT**

Bo Buchynsky  
Diamond Generating Corporation  
333 South Grand Avenue, #1570  
Los Angeles, California 90071  
[b.buchynsky@dgc-us.com](mailto:b.buchynsky@dgc-us.com)

**APPLICANT'S CONSULTANTS**

Doug Urry  
2485 Natomas Park Dr #600  
Sacramento, CA 95833-2975  
[Doug.Urry@CH2M.com](mailto:Doug.Urry@CH2M.com)

**COUNSEL FOR APPLICANT**

Gregg Wheatland  
Ellison, Schneider & Harris L.L.P.  
2600 Capitol Avenue, Suite 400  
Sacramento, CA 95816-5905  
[glw@eslawfirm.com](mailto:glw@eslawfirm.com)

**INTERESTED AGENCIES**

California ISO  
*E-mail Service Preferred*  
[e-recipient@caiso.com](mailto:e-recipient@caiso.com)

**INTERVENORS**

Mr. Robert Sarvey  
501 W. Grantline Road  
Tracy, California 95376  
[Sarveybob@aol.com](mailto:Sarveybob@aol.com)

\*California Pilots Association  
c/o Andy Wilson  
31438 Greenbrier Lane  
Hayward, CA 94544  
[andy\\_psi@sbcglobal.net](mailto:andy_psi@sbcglobal.net)

Rajesh Dighe  
395 W. Conejo Avenue  
Mountain House, California 95391  
[dighe.rajesh@gmail.com](mailto:dighe.rajesh@gmail.com)

Morgan K. Groover  
Development Director  
Mountain House Community  
Services District  
230 S. Sterling Drive, Suite 100  
Mountain House, CA 95391  
[mgroover@sjgov.org](mailto:mgroover@sjgov.org)

**ENERGY COMMISSION**

JEFFREY D. BYRON  
Commissioner and Presiding Member  
[jbyron@energy.state.ca.us](mailto:jbyron@energy.state.ca.us)

ROBERT B. WEISENMILLER  
Commissioner and Associate Member  
[rweisenm@energy.state.ca.us](mailto:rweisenm@energy.state.ca.us)

Kenneth Celli  
Hearing Officer  
[kcelli@energy.state.ca.us](mailto:kcelli@energy.state.ca.us)

Kristy Chew  
Advisor to Commissioner Byron  
E-Mail Service preferred  
[kchew@energy.state.ca.us](mailto:kchew@energy.state.ca.us)

Craig Hoffman  
Siting Project Manager  
[choffman@energy.state.ca.us](mailto:choffman@energy.state.ca.us)

Kerry Willis  
Staff Counsel  
[kwillis@energy.state.ca.us](mailto:kwillis@energy.state.ca.us)

Jennifer Jennings  
Public Adviser  
[publicadviser@energy.state.ca.us](mailto:publicadviser@energy.state.ca.us)



## DECLARATION OF SERVICE

I, Hilarie Anderson, declare that on November 10, 2010, I served and filed copies of the attached Notice of Availability & Notice of Public Workshop, Library Letter and Agency Letter. The original document, filed with the Docket Unit, is accompanied by a copy of the most recent Proof of Service list, located on the web page for this project at: [\[http://www.energy.ca.gov/sitingcases/mariposa/index.html\]](http://www.energy.ca.gov/sitingcases/mariposa/index.html).

The document has been sent to both the other parties in this proceeding (as shown on the Proof of Service list) and to the Commission's Docket Unit, in the following manner:

**(Check all that Apply)**

### FOR SERVICE TO ALL OTHER PARTIES:

- sent electronically to all email addresses on the Proof of Service list;  
 by personal delivery;  
 by delivering on this date, for mailing with the United States Postal Service with first-class postage thereon fully prepaid, to the name and address of the person served, for mailing that same day in the ordinary course of business; that the envelope was sealed and placed for collection and mailing on that date to those addresses **NOT** marked "email preferred."

**AND**

### FOR FILING WITH THE ENERGY COMMISSION:

- sending an original paper copy and one electronic copy, mailed and emailed respectively, to the address below (*preferred method*);

**OR**

- depositing in the mail an original and 12 paper copies, as follows:

**CALIFORNIA ENERGY COMMISSION**

Attn: Docket No. 09-AFC-3  
1516 Ninth Street, MS-4  
Sacramento, CA 95814-5512  
[docket@energy.state.ca.us](mailto:docket@energy.state.ca.us)

I declare under penalty of perjury that the foregoing is true and correct, that I am employed in the county where this mailing occurred, and that I am over the age of 18 years and not a party to the proceeding.

Original Signature in docket  
Hilarie Anderson