

DOCKET

09-AFC-5

DATE

RECD. JAN 26 2010

Surface Soil Sampling

The anticipated sample locations are shown on the attached Soil Sampling Plan and outlined in the attached soil sampling table. The sample locations were selected to give reasonable spatial coverage of the project site area. If present, soil contamination in the previously disturbed fallow agricultural areas is anticipated to be relatively shallow. Consequently, the focus of the proposed investigation for these areas is shallow soil.

Soil samples for the fallow agriculture areas (labeled 1 through 12) will be collected from each quarter of the quarter sections at a depth of 0 to 8 inches. These surface samples will be collected using a trowel or appropriate hand equipment. The fallow agriculture samples will be consolidated and submitted for laboratory analysis of possible pesticide and/or herbicide residue per USEPA 8081A & USEPA 8151A

Soil samples for the Phase I areas (labeled A through J) will be collected from the locations identified in the Phase I Environmental Site Assessment as showing evidence of surface staining from previous commercial and agricultural uses and locations of existing structures.

Two soil samples will be collected from each location showing evidence of surface staining, a surface sample at 0 to 4 inches and a deeper sample at 20 to 24 inches. The surface sample will be collected using a trowel or appropriate hand equipment. The deeper sample will be collected using a hand auger or other appropriate equipment as necessary. These samples will be submitted for laboratory analysis of possible hydrocarbon residue per USEPA 8015M. Material samples will be collected in the locations of existing structures to test for evidence of lead and asbestos per EPA 6020 & USEPA 600/M4-82-020.

Soil and Material Analysis

The proposed analytical testing parameters and methods for soil and material samples will be performed by an independent, approved laboratory. Soil and material samples will be submitted for a combination of laboratory analysis. Analysis will be determined following consultation with and at the direction of the County of San Bernardino Environmental Health Department and the San Bernardino County Department of Agriculture.

Mojave Solar Project – Soil Sampling Plan			
APN	PHASE I INFORMATION	SAMPLING PLAN	TEST METHOD(S)
0490-121-42	Previous Cattle Farming	(1-3) – Pesticides / Herbicides	USEPA 8081A / USEPA 8151A
	Existing Concrete Structure – Store	(A) – Lead / Asbestos	EPA 6020 / USEPA 600/M4-82-020
	Vent Pipes @ South Store Wall	(B) – Hydrocarbons	USEPA 8015M
	Previous Fuel Islands @ Store Front	(C) – Hydrocarbons	USEPA 8015M
	Previous UG Aviation Fuel Tank – 30' North of Store	(D) – Hydrocarbons	USEPA 8015M
	Previous AG Fuel Tanks – Rear of Store	(E) – Hydrocarbons	USEPA 8015M
	Existing Wood Structures – Various	(F) – Lead / Asbestos	EPA 6020 / USEPA 600/M4-82-020
0490-131-06	Wood Structures @ SW Corner – Vacant Homes	(G) – Lead / Asbestos	EPA 6020 / USEPA 600/M4-82-020
	Vacant – Fallow Agriculture	(6) – Pesticides / Herbicides	USEPA 8081A / USEPA 8151A
0490-131-07	Vacant – Fallow Agriculture	(5) – Pesticides / Herbicides	USEPA 8081A / USEPA 8151A
0490-131-08	Vacant – Fallow Agriculture	(4) – Pesticides / Herbicides	USEPA 8081A / USEPA 8151A
0490-131-11	Vacant – Fallow Agriculture	(7) – Pesticides / Herbicides	USEPA 8081A / USEPA 8151A
0490-131-12	Wood Structures @ South – Vacant Farm Buildings	(H) – Lead / Asbestos	EPA 6020 / USEPA 600/M4-82-020
		(7) – Pesticides / Herbicides	USEPA 8081A / USEPA 8151A
<i>0490-131-13</i>	<i>Not Part of Final Project Site</i>	<i>N/A</i>	
0490-131-15	Existing Desert	No Sampling Planned	
0490-131-16	Existing Desert	No Sampling Planned	
0490-161-08	Active Agriculture	(8) – Pesticides / Herbicides	USEPA 8081A / USEPA 8151A
0490-161-09	Active Agriculture	(8) – Pesticides / Herbicides	USEPA 8081A / USEPA 8151A
	Active Well @ NE Corner – Ryken Well	(I) – Hydrocarbons	USEPA 8015M
0490-161-10	Vacant – Fallow Agriculture	(9) – Pesticides / Herbicides	USEPA 8081A / USEPA 8151A
0490-161-11	Vacant – Fallow Agriculture	(10) – Pesticides / Herbicides	USEPA 8081A / USEPA 8151A
	Active Well @ NW Corner – Wetlands Well	(J) – Hydrocarbons	USEPA 8015M

0490-161-12	Vacant – Fallow Agriculture	(12) – Pesticides / Herbicides	USEPA 8081A / USEPA 8151A
0490-161-13	Vacant – Fallow Agriculture	(11) – Pesticides / Herbicides	USEPA 8081A / USEPA 8151A
<i>0490-171-09</i>	<i>Not Part of Final Project Site</i>	<i>N/A</i>	

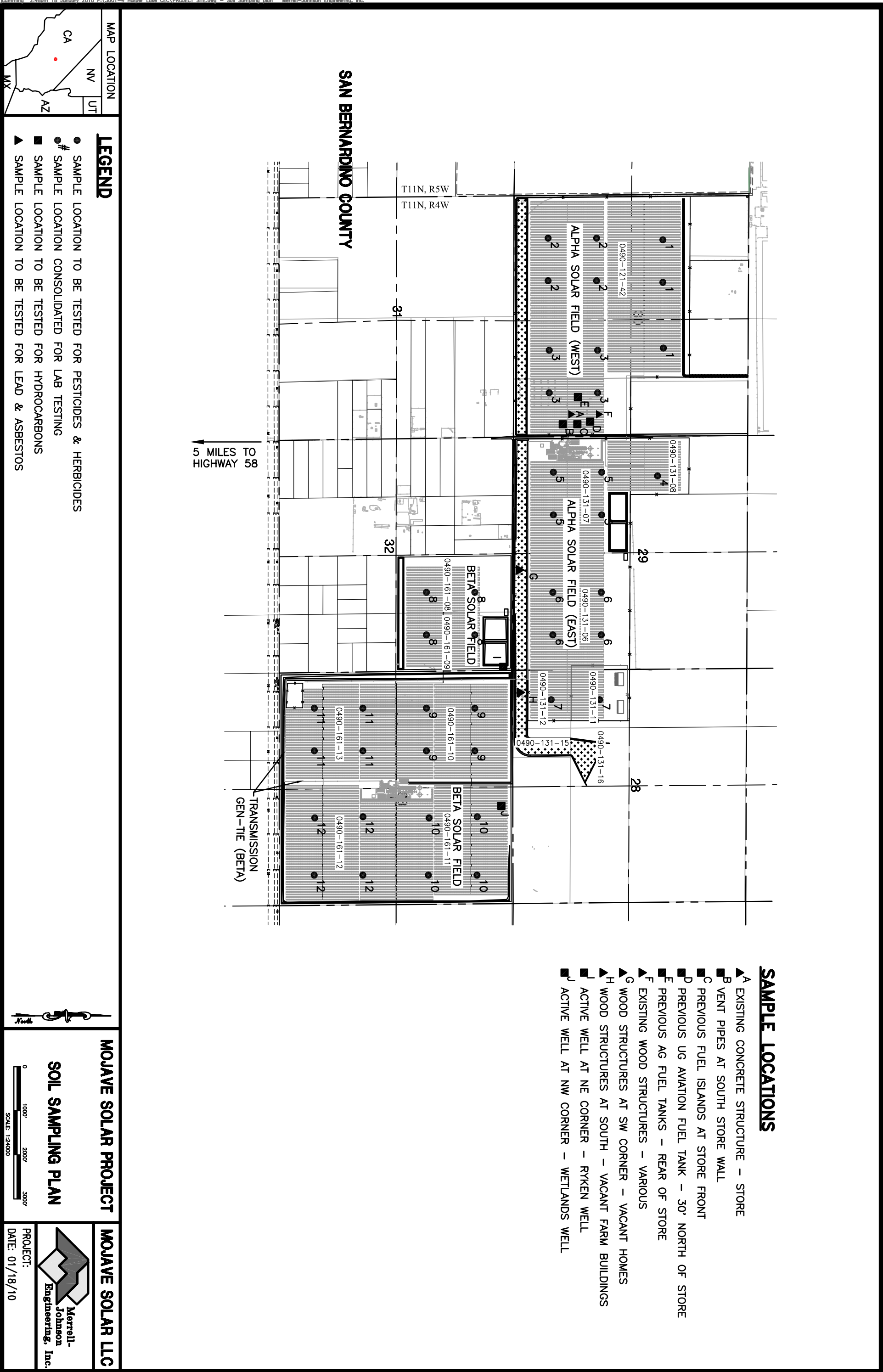

MAP LOCATION

LEGEND

- SAMPLE LOCATION TO BE TESTED FOR PESTICIDES & HERBICIDES
- # SAMPLE LOCATION CONSOLIDATED FOR LAB TESTING
- SAMPLE LOCATION TO BE TESTED FOR HYDROCARBONS
- ▲ SAMPLE LOCATION TO BE TESTED FOR LEAD & ASBESTOS

SAMPLE LOCATIONS

- ▲ EXISTING CONCRETE STRUCTURE - STORE
- VENT PIPES AT SOUTH STORE WALL
- PREVIOUS FUEL ISLANDS AT STORE FRONT
- PREVIOUS UG AVIATION FUEL TANK - 30' NORTH OF STORE
- PREVIOUS AG FUEL TANKS - REAR OF STORE
- ▲ EXISTING WOOD STRUCTURES - VARIOUS
- ▲ WOOD STRUCTURES AT SW CORNER - VACANT HOMES
- ▲ WOOD STRUCTURES AT SOUTH - VACANT FARM BUILDINGS
- ACTIVE WELL AT NE CORNER - RYKEN WELL
- ACTIVE WELL AT NW CORNER - WETLANDS WELL

MOJAVE SOLAR PROJECT

MOJAVE SOLAR LLC

SOIL SAMPLING PLAN



PROJECT:
DATE: 01/18/10

FOLD

FOLD

STATE OF CALIFORNIA

Energy Resources Conservation
and Development Commission

Application for Certification for the **ABENGOA**)
MOJAVE SOLAR POWER PLANT)
)
)
_____)

Docket No. 09-AFC-5

PROOF OF SERVICE

I, Karen A. Mitchell, declare that on January 26, 2010, I served the attached *Soil Sampling Plan* via electronic mail and United States Mail to all parties on the attached service list.

I declare under the penalty of perjury that the foregoing is true and correct.



Karen A. Mitchell



BEFORE THE ENERGY RESOURCES CONSERVATION AND DEVELOPMENT
COMMISSION OF THE STATE OF CALIFORNIA
1516 NINTH STREET, SACRAMENTO, CA 95814
1-800-822-6228 – WWW.ENERGY.CA.GOV

**APPLICATION FOR CERTIFICATION
FOR THE ABENGOA MOJAVE
SOLAR POWER PLANT**

Docket No. 09-AFC-5

***PROOF OF SERVICE
(Revised 1/11/2010)***

APPLICANT

Emiliano Garcia Sanz
General Manager
Abengoa Solar Inc.
11500 West 13th Avenue
Lakewood, CO 80215
emiliano.garcia@solar.abengoa.com

Scott D. Frier
Chief Operating Officer
Abengoa Solar Inc.
13911 Park Ave., Ste. 206
Victorville, CA 92392
scott.frier@solar.abengoa.com

Tandy McMannes
2030 Addison Street, Suite 420
Berkeley, CA 94704
tandy.mcmannes@solar.abengoa.com

APPLICANT'S CONSULTANTS

Frederick H. Redell, PE
Engineering Manager
Abengoa Solar, Inc.
11500 West 13th Avenue
Lakewood, CO 80215
fredredell@solar.abengoa.com

COUNSEL FOR APPLICANT

Christopher T. Ellison
Ellison, Schneider & Harris
2600 Capitol Ave.
Sacramento, CA 95816
cte@eslawfirm.com

INTERESTED AGENCIES

California ISO
e-recipient@caiso.com

INTERVENORS

California Unions for Reliable Energy ("CURE")
Tanya A. Gulesserian
Marc D. Joseph
Elizabeth Klebaner
Adams Broadwell Joseph & Cardozo
601 Gateway Boulevard, Suite 1000
South San Francisco, CA 94080
E-mail Preferred
tgulesserian@adamsbroadwell.com
eklebaner@adamsbroadwell.com

***Luz Solar Partners Ltd., VIII
Luz Solar Partners Ltd., IX
Jennifer Schwartz
700 Universe Blvd
Juno Beach, FL 33408
jennifer.schwartz@nexteraenergy.com**

ENERGY COMMISSION

JAMES D. BOYD
Vice Chairman and Associate Member
jboyd@energy.state.ca.us

Paul Kramer
Hearing Officer
pkramer@energy.state.ca.us

Craig Hoffman
Project Manager
choffman@energy.state.ca.us

Christine Hammond
Staff Counsel
chammond@energy.state.ca.us

Public Adviser's Office
publicadviser@energy.state.ca.us