

California State
OFFICE OF HISTORIC PRESERVATION

Department of Parks and Recreation

P.O. Box 942896

Sacramento, CA 94296-0001

(916) 653-6624 fax: (916) 653-9824

calshpo@ahp.parks.ca.gov

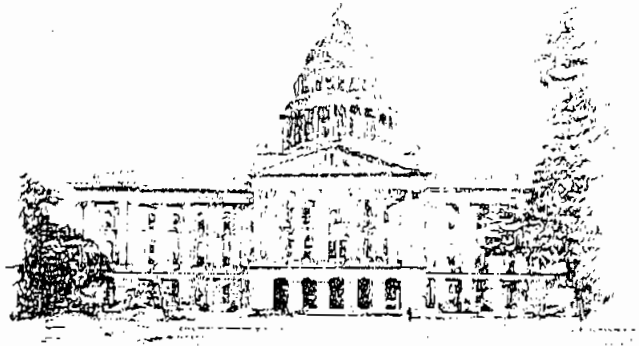

Fax

Date: 7/21/06

To: James Partridge

Cover + 1 pp.

Organization:	
FAX: <u>916 654-4421</u>	Phone: <u>-4169</u>
>>from:	
Re:	

- Urgent
 For Review
 Please Comment
 Please Reply
 Information

• Comments:



Agency: Office of Historic Preservation

We, the following individuals, have read the "Confidentiality Agreement among Federal and California State Agencies for the Programmatic Environmental Impact Statement for Energy Corridors on Federal Lands in the 11 Western States," dated February 24, 2006, and agree to the terms and conditions of the Agreement.

Signature: Stephen D. Mikesell Date: 7/21/06
Name: Stephen D. Mikesell
Title: Deputy State Historic Preservation Officer
Office of Historic Preservation

GALATI & BLEK LLP
Counselors & Advocates

Plaza Towers
555 Capitol Mall
Suite 600
Sacramento, CA 95814

DOCKET 05-AFC-3
DATE JUL 31 2006
RECD. AUG 3 2006

July 31, 2006

Mr. B.B. Blevins
Executive Director
California Energy Commission
1516 Ninth Street
Sacramento, CA 95814

Attorneys
Scott A. Galati
Scott W. Blek

Of Counsel
Jennifer Costanza

Lobbyists
Scott A. Galati
Sandra A. Carey

OFFICES ALSO IN
GLENDALE, CA

**Subject: Supplemental Request for Confidential Designation
Confidential Cultural Resources Report
Sun Valley Energy Project (05-AFC-3)**

Dear Mr. Blevins,

Valle del Sol Energy, LLC (VSE), a wholly-owned subsidiary of Edison Mission Energy, is the owner of the Sun Valley Energy Project (SVEP). VSE requested Confidential Designation of a Confidential Cultural Resources Report submitted in response to Data Request 49. The Commission granted that request on May 9, 2006. VSE files this Supplemental Request For Confidentiality for materials that should have been included in that Cultural Resources Report but were inadvertently omitted.

VSE requests this information be designated confidential as well under 20 CCR 2505 (a)(4).

I certify under penalty of perjury that the information contained in this Application for Confidential Designation is true, correct and complete to the best of my knowledge. I am authorized to make this application and certification on behalf of Valle del Sol Energy.



Scott A. Galati
Counsel for Valle del Sol Energy, LLC

EASTERN INFORMATION CENTER
CALIFORNIA HISTORICAL RESOURCES INFORMATION SYSTEM
Department of Anthropology, University of California, Riverside, CA 92521-0418
(951) 827-5745 - Fax (951) 827-5409 - eickw@ucr.edu
Inyo, Mono, and Riverside Counties

August 26, 2005
RS #3494

Clint J. Helton
CH2M Hill
3 Hutton Centre Drive Suite 200
Santa Ana, CA 92707

Re: Cultural Resource Records Search for the Sun Valley Energy Project

Dear Mr. Helton:

We received your request on August 24 , 2005 for a cultural resource records search for the proposed Sun Valley Energy Project located in Section 14, T. 5S, R. 3W, SBBM, near the city of Sun City area of Riverside County. We have reviewed our site records, maps, and manuscripts against the location map you provided.

Our records indicate that seven cultural resource studies have been conducted within a half-mile radius of your project area. One of these studies involved a portion of the project area; a copy of this report is included for your reference. These reports are listed on the attachment entitled "Archeological Reports" and are available upon request at 15¢/page plus \$30/hour. The KEYWORD section of each citation lists the geographic area, quad name, listing of trinomials (when identified), report number in our manuscript files (RI #), and the number of pages per report.

No cultural resource properties have been recorded within the boundaries of the project area. Our records indicate that six properties have been recorded within a half-mile radius of the project area. Copies of the records are included for your reference.

The above information is reflected on the enclosed map. Areas that have been surveyed are highlighted in yellow. Numbers marked in blue ink refer to the report number in our manuscript files (RI #). Cultural resource properties are marked in red; numbers in black refer to Trinomial designations, those in green to Primary Number designations. National Register properties are indicated in light blue.

Clint J. Helton
August 26, 2005
Page 2

Additional sources of information consulted are identified below. Note that not all sites or properties are listed on the Office of Historic Preservation (OHP) Archaeological Determinations of Eligibility or Directory of Properties in the Historic Property Data File. Only those sites or properties that have been reviewed by the OHP are listed.

National Register of Historic Places (07/29/05): no listed properties are located within the boundaries of the project area.

Office of Historic Preservation, Archaeological Determinations of Eligibility (03/07/05): no listed sites are located within the boundaries of the project area.

Office of Historic Preservation, Directory of Properties in the Historic Property Data File (03/07/05): no listed properties are located within the boundaries of the project area.

A copy of the relevant portion of the 1901 USGS Elsinore 30' topographic map is included for your reference.

As the Information Center for Riverside County, it is necessary that we receive a copy of all cultural resource reports and site information pertaining to this county in order to maintain our map and manuscript files. Confidential information provided with this records search regarding the location of cultural resources outside the boundaries of your project area should not be included in reports addressing the project area.

Sincerely,

A handwritten signature in black ink, appearing to read "Chris Rivera", with a long horizontal flourish extending to the right.

Chris Rivera
Information Officer

Enclosures

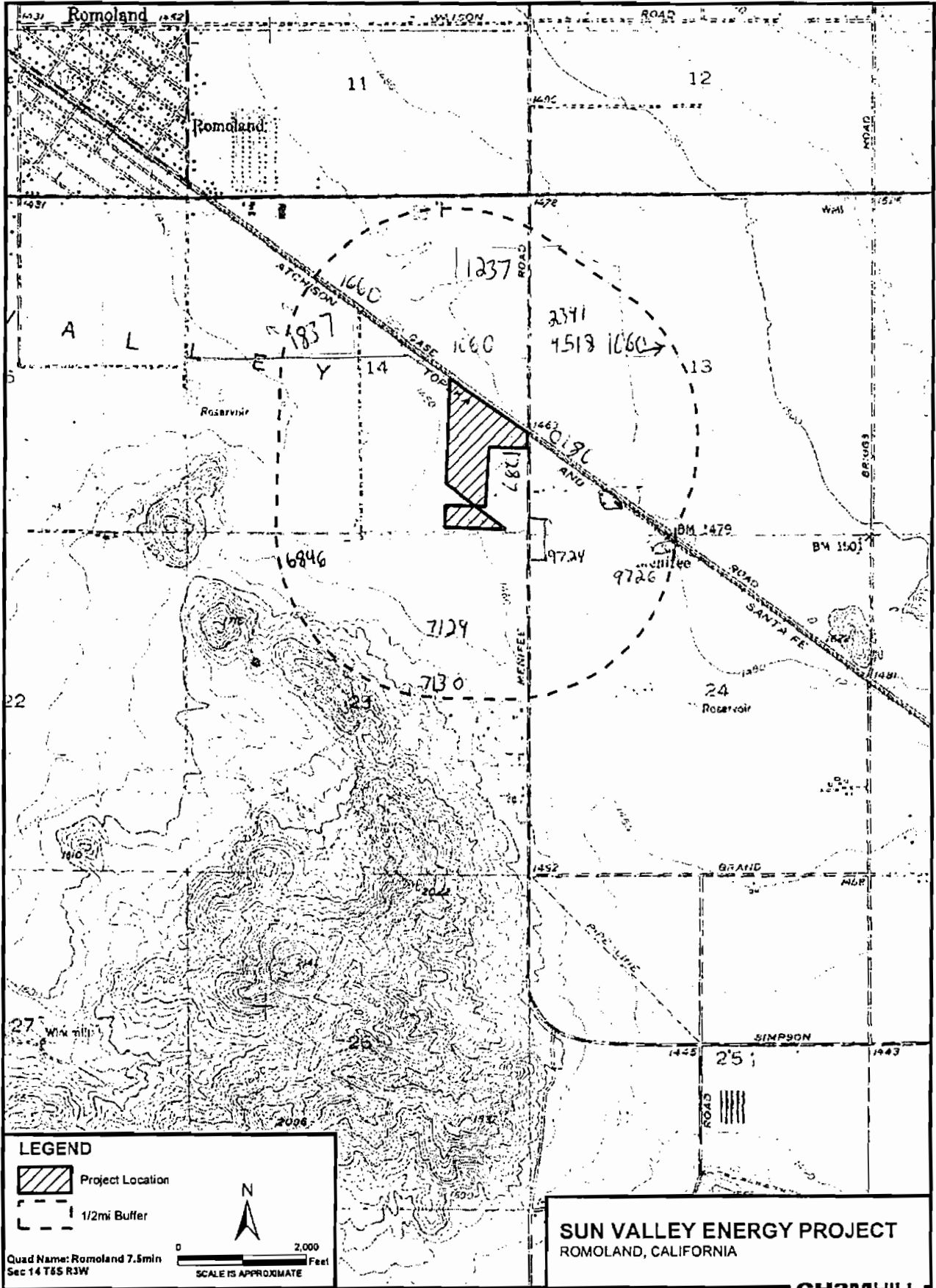

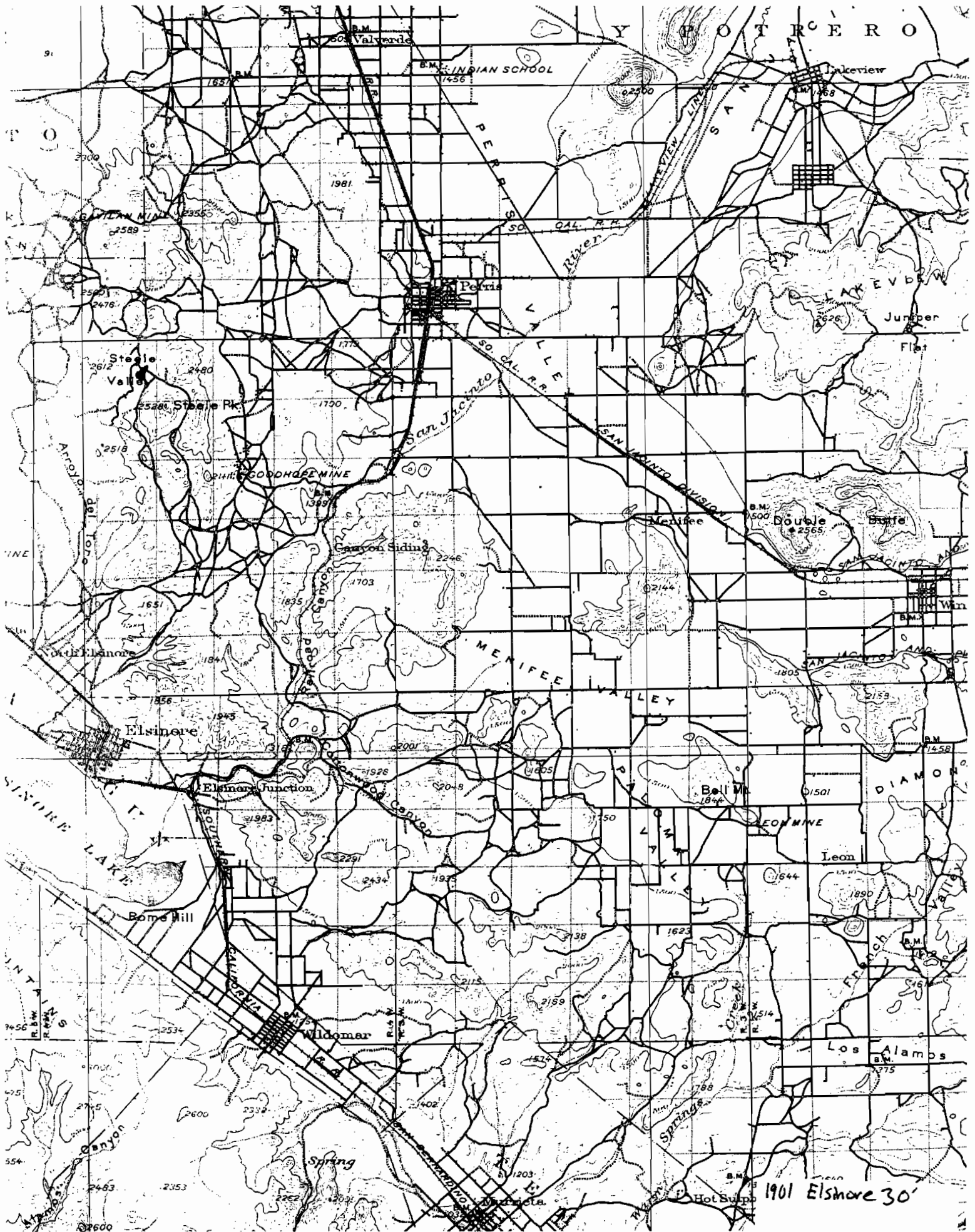

1901 Elshore 30'