





DOCKETED

Docket Number:	23-OPT-01
Project Title:	Fountain Wind Project
TN #:	251365
Document Title:	FtnWind_OMBldgViewshed_July28
Description:	N/A
Filer:	Caitlin Barns
Organization:	Stantec Consulting Services, Inc.
Submitter Role:	Applicant Consultant
Submission Date:	7/28/2023 1:38:40 PM
Docketed Date:	7/28/2023

V:\1956\active\Task Owner and other Non-BC\1956_Jobs\185703743\03_data\gis_cadd\gis\mxd\Views\shed\2023\OandM_Viewshed_Visibility.aprx Revised: 2023-07-28 By: gcarpenter



- Legend**
-  O&M Building
 -  Potential O&M Building Visibility
 -  Access Road
 -  Batch Plant

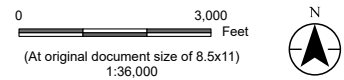

Project Location
Shasta County
California

Prepared by GC on 2023-07-26
Reviewed by JH on 2023-07-26

Client/Project
Fountain Wind LLC
Fountain Wind Project

203723159

Figure No.
1

Title
Viewshed Analysis – Operations & Maintenance Building

- Notes**
1. Coordinate System: NAD 1983 StatePlane California I FIPS 0401 Feet
 2. Data Sources: USGS, Stantec
 3. Background: ESRI World Topographic Base Map