

DOCKETED

Docket Number:	17-IEPR-09
Project Title:	Climate Adaptation and Resiliency
TN #:	220884
Document Title:	Cimate Impacts on Disadvantaged Communities: Role of Energy Sector
Description:	8.29.2017 Presentation by Amee Raval of Asian Pacific Environmental Network
Filer:	Raquel Kravitz
Organization:	California Energy Commission
Submitter Role:	Commission Staff
Submission Date:	8/25/2017 10:23:20 AM
Docketed Date:	8/25/2017

DOCKETED

Docket Number:	17-IEPR-09
Project Title:	Climate Adaptation and Resiliency
TN #:	220881-8
Document Title:	Cimate Impacts on Disadvantaged Communities: Role of Energy Sector
Description:	8.29.2017 Presentation by Amee Raval of Asian Pacific Environmental Network
Filer:	Raquel Kravitz
Organization:	California Energy Commission
Submitter Role:	Commission Staff
Submission Date:	8/25/2017 10:23:20 AM
Docketed Date:	8/25/2017



Climate Impacts on Disadvantaged Communities: Role of Energy Sector

*Community Perspectives: Best
Practices and Remaining Needs*

Amee Raval

Policy & Research Associate

amee@apen4ej.org

www.apen4ej.org



APEN ASIAN PACIFIC
ENVIRONMENTAL
NETWORK

Asian Pacific Environmental Network



APEN ASIAN PACIFIC
ENVIRONMENTAL
NETWORK

APEN CORE STRATEGIES

COMMUNITY BASED LEADERSHIP

APEN Academy – Leadership Steering Committee – Leaders Retreat

Chevron Campaign – Solar Demonstration Projects – Transit Oriented Development –
Richmond Our Power Convening



APEN

ASIAN PACIFIC
ENVIRONMENTAL
NETWORK

APEN CORE STRATEGIES

BUILDING POLITICAL POWER STATEWIDE

API Voter Registration – Candidates Forums – Voter Engagement Program

AAPIs for Civic Empowerment – API Progressive Base



APEN ASIAN PACIFIC
ENVIRONMENTAL
NETWORK

APEN CORE STRATEGIES

COMMUNITY SOLUTIONS IN STATE POLICY

SB 350 Barriers Study

AB 693: Multifamily Affordable Housing Solar Program

AB 2722: Transformative Climate Communities

AB 523: Equity in Clean Energy Funds



APEN

ASIAN PACIFIC
ENVIRONMENTAL
NETWORK

Three Key Trends

- Economic Inequality
- Environmental and Climate Crisis
- Emerging Innovations in Clean Energy

In understanding their interconnectedness, we can use the opportunities from clean energy technologies to spur a new kind of economy that is both based on low carbon energy and addresses the widening gap



APEN ASIAN PACIFIC
ENVIRONMENTAL
NETWORK

Energy Needs in EJ Communities

- Low-Income Californians:
 - 70% Renters
 - 47% Multifamily Affordable Housing
 - 54% Linguistically Isolated
- Energy Burden & Insecurity
- Vulnerable to Utility Disconnections
- High Need Communities
 - Homeless
 - Dependent on Medical Equipment
 - Large Families
 - Proximity to Risky Energy Infrastructure



APEN ASIAN PACIFIC
ENVIRONMENTAL
NETWORK

Low-income communities and communities of color are disproportionately impacted by climate polluters.

Communities within 2.5 miles of a greenhouse gas facility have:

22% higher proportion of people of color
21% higher proportion of low-income people

The more emitting facilities, the higher % people of color:

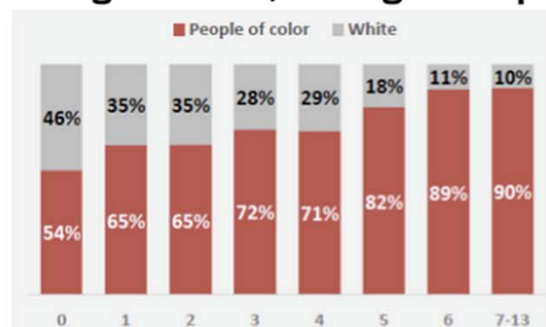

Number of GHG facilities within 2.5 miles

Climate solutions must start with most impacted communities!

Cushing, L. J., Wander, M., Morello-Frosch, R., Pastor, M., Zhu, A., & Sadd, J. (2016). A Preliminary Environmental Equity Assessment of California's Cap-and-Trade Program. *Report. Program for Environmental and Regional Equity, University of Southern California Dornsife.*



APEN ASIAN PACIFIC
ENVIRONMENTAL
NETWORK

Climate Justice & Resilience

Adaptation is the process of responding to the impending or inevitable consequences of the climate disruption already set in motion that cannot be avoided or reversed.

- Physical Threats and Infrastructure

Resilience describes the capacity of a system (whether a community or an economy) to maintain an intact core identity in the face of change

- Land Use & Community Development
- Social Cohesion
- Public Health



APEN

ASIAN PACIFIC
ENVIRONMENTAL
NETWORK

Climate Resilience & Energy

- Distinct vulnerability of EJ communities to surges and power outages
- Risks posed by proximity to fossil fuel infrastructure
- Rising costs of utility bills and other economic impacts



APEN

ASIAN PACIFIC
ENVIRONMENTAL
NETWORK

RICHMOND JUST TRANSITION STRATEGIES

THE EXTRACTIVE ECONOMY



ORGANIZE TO END THE BAD

- Stop crude-by-rail
- Stop tar sands & cut refinery emissions
- Stop health care cuts
- Stop petcoke and coal-by-rail

DRAW DOWN MONEY AND POWER

ORGANIZE A MOVEMENT OF MOVEMENTS

- Reach voters in every election
- Educate people about just transition
- Strengthen the REJC
- Partner with c4s

CHANGE THE RULES

City Initiatives

- Establish a city renewable energy & efficiency standard
- Create municipal clean energy bonds
- Develop MCE target of locally generated renewable energy
- Create procurement agreements prioritize cooperatives & just transition projects
- Require local sourcing of food
- Community ownership of public lands
- Support job training programs
- Connect to state & national policy and advocacy

CHANGE THE STORY

- Host annual Our Power Solutions Festival
- Develop leadership & provide political education
- Community-led media and storytelling

STARVE AND STOP DIVEST FROM THEIR POWER

MOVE MONEY & RESOURCES

- Connect UC Divestment Campaign with Richmond work
- Implement SB 535 GHG Reduction Fund
- Create national reinvestment cooperative
- Support Richmond's Revolving Loan Fund

FEED AND GROW INVEST IN OUR POWER



BUILD THE NEW

- Develop local just transition projects (e.g. energy coop, regional food hub)
- Establish Green Zones
- Develop Richmond Cooperative Incubator
- Ensure community governance & local jobs in MCE's Chevron Solar Project
- Create community-owned infrastructure

Building Resilience: Emergency Management

- Laotian Organizing Project (LOP) in Richmond
- Historic Campaign: Multilingual Warning System (2001)



March 25, 1999 Chevron oil refinery accident



LOP youth and seniors rally for a multilingual emergency phone alert system outside an apartment complex near Chevron's refinery

Campaign involved activating

LOP staff made presentations to churches, adult education classes, Laotian ethnic associations, and maintained lists



APEN

ASIAN PACIFIC
ENVIRONMENTAL
NETWORK

Building Resilience: Emergency Management

- Key Lessons
 - Development of emergency warning systems
 - Targeted outreach to vulnerable communities
 - Identify threats from energy infrastructure in light of extreme weather events

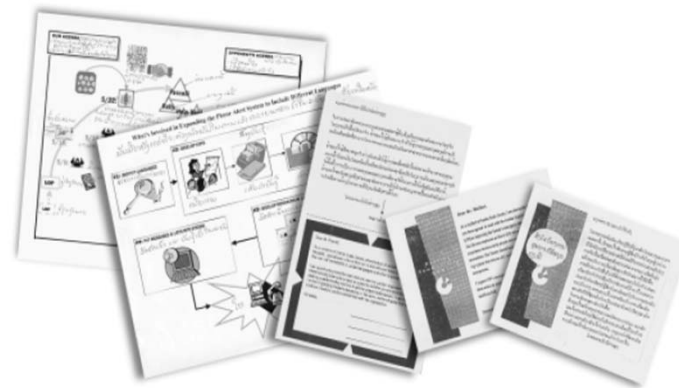

APEN

ASIAN PACIFIC
ENVIRONMENTAL
NETWORK

Building Resilience: Energy Efficiency

- EJ communities live in older buildings and use inefficient appliances
- Contributes to higher energy use
- High-performance buildings more likely to maintain temperatures
- Vulnerable communities include elderly and those with medical conditions
- Energy efficient buildings can:
 - Allows residents/tenants to shelter in place longer
 - Reduces annual energy spending
 - Reduces overall net emissions



APEN ASIAN PACIFIC
ENVIRONMENTAL
NETWORK

Building Resilience: Microgrids

- Bridging 'green divide'
- Prioritize critical facilities that serve vulnerable communities
- Allows communities to disconnect from grid during power outage and maintain power supply
- Allows facilities receiving backup power to double as shelter for displaced residents
- Increases cost savings



Remaining Needs

- Analyze economic and health impacts of changes in the energy sector from climate change
- Build the evidence base to connect climate resilience:
 - High energy burden, energy insecurity, and utility disconnections
 - Access to energy upgrades, clean energy technologies, and workforce opportunities
- Strengthen metrics to track multiple benefits i.e. energy affordability, reliability, health and safety
- Improve coordination and leveraged funding for energy upgrades and climate resilience efforts
- Continue to strengthen community engagement

Guidance for State Agencies

- Support EJ community needs through data, research, and accessible information
- Extend participation to all stages of decision-making
- Prioritize the protection of essential facilities that provide health care, food, and emergency shelter
- Center anti-displacement and housing affordability
- Ensure climate and energy projects promote health and avoid harms



APEN

ASIAN PACIFIC
ENVIRONMENTAL
NETWORK

Thank You!



**TRANSFORMATIVE
CLIMATE COMMUNITY**

Building Neighborhood-led Climate Equity



APEN

ASIAN PACIFIC
ENVIRONMENTAL
NETWORK