

DOCKETED

Docket Number:	22-SPPE-02
Project Title:	San Jose Data Center 04
TN #:	255773
Document Title:	Revised Figure DR 48 Attachment PD DR-48
Description:	N/A
Filer:	Scott Galati
Organization:	DayZenLLC
Submitter Role:	Applicant Representative
Submission Date:	4/17/2024 5:05:22 PM
Docketed Date:	4/18/2024

OWNER



ARCHITECT

SHEEHAN NAGLE HARTRAY ARCHITECTS
130 East Randolph
Suite 3100
Chicago, IL 60601
312.633.2900

CIVIL & LANDSCAPE

CIVIL ENGINEER
LANDSCAPE ARCHITECT
HMH
1570 Oakland Road
San Jose, CA 95131
Tel 408.487.2200

STRUCTURAL

STRUCTURAL ENGINEER
Thornton Tomasetti
120 Broadway
New York, NY 10271
Tel 917.661.7800



MEP ENGINEER
233 S Wacker Dr, Ste
5300
Chicago, IL 60606
Tel 312.372.1200



SECURITY ENGINEER
ZBETA
600 1st Ave.
Suite 102, PMB 2087
Seattle, WA 98104

No.	Description	Date
1	IFP	02/16/24

SJC04 DATA CENTER

2515 Orchard Pkwy
San Jose, CA 95131

SITE PLAN

4.0

SCALE: Scale as Noted

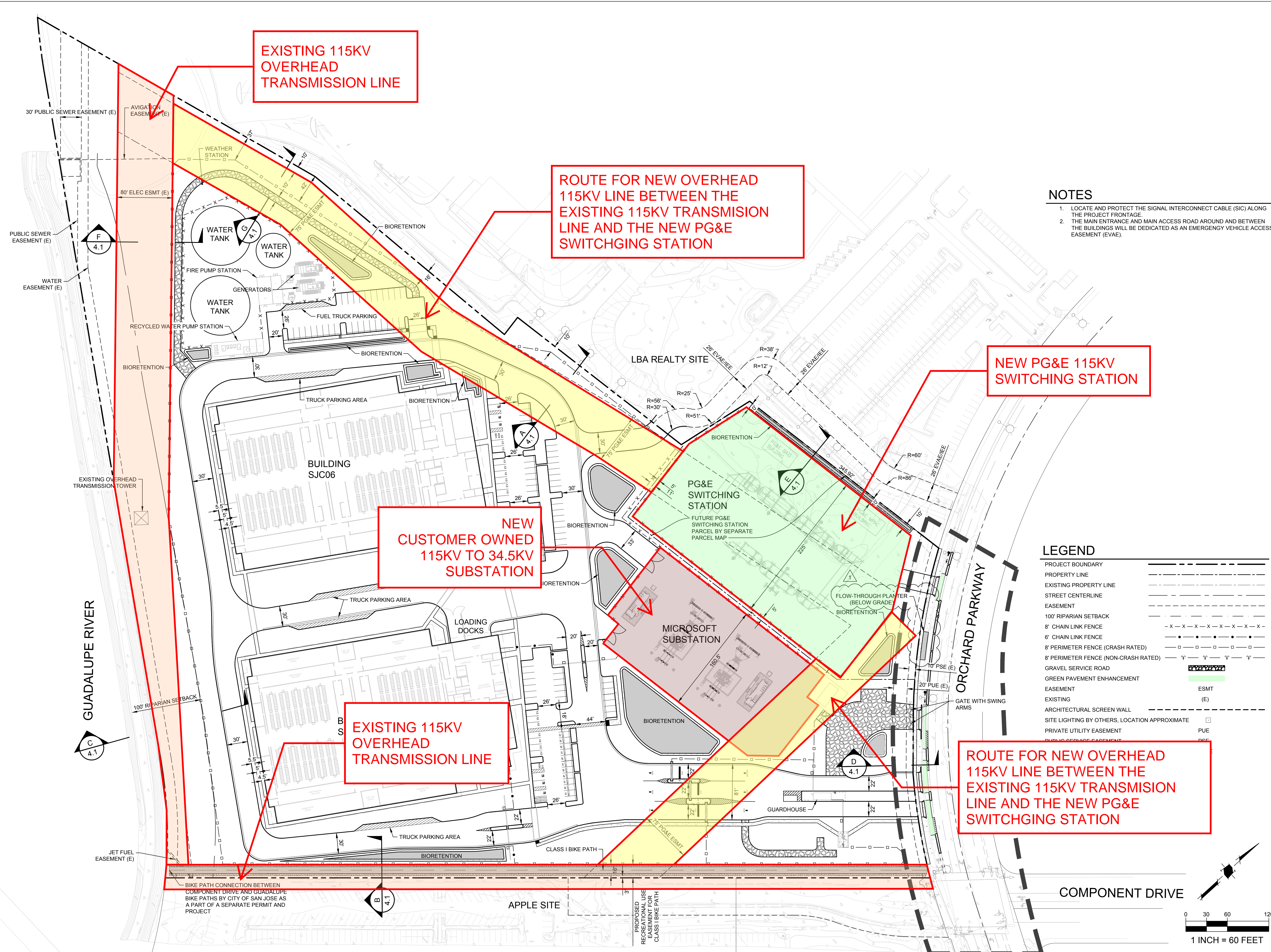

NOTES

1. LOCATE AND PROTECT THE SIGNAL INTERCONNECT CABLE (SIC) ALONG THE PROJECT FRONTAGE.
2. THE MAIN ENTRANCE AND MAIN ACCESS ROAD AROUND AND BETWEEN THE BUILDINGS WILL BE DEDICATED AS AN EMERGENCY VEHICLE ACCESS EASEMENT (EVAE).

LEGEND

PROJECT BOUNDARY	---
PROPERTY LINE	---
EXISTING PROPERTY LINE	---
STREET CENTERLINE	---
EASEMENT	---
100' RIPARIAN SETBACK	---
8' CHAIN LINK FENCE	-X-X-X-X-X-X-X-X-
6' CHAIN LINK FENCE	-X-X-X-X-X-X-X-X-
8' PERIMETER FENCE (CRASH RATED)	-O-O-O-O-O-O-O-O-
8' PERIMETER FENCE (NON-CRASH RATED)	-Y-Y-Y-Y-Y-Y-Y-Y-
GRAVEL SERVICE ROAD	---
GREEN PAVEMENT ENHANCEMENT	---
EASEMENT	ESMT
EXISTING	(E)
ARCHITECTURAL SCREEN WALL	---
SITE LIGHTING BY OTHERS, LOCATION APPROXIMATE	□
PRIVATE UTILITY EASEMENT	PUE
PUBLIC UTILITY EASEMENT	PUE

