

DOCKETED

Docket Number:	21-SPPE-01
Project Title:	CA3 Backup Generating Facility-Vantage
TN #:	238029
Document Title:	CA3BGF Landscape Plan
Description:	N/A
Filer:	Scott Galati
Organization:	DayZenLLC
Submitter Role:	Applicant Representative
Submission Date:	5/28/2021 9:54:06 AM
Docketed Date:	5/28/2021

PLANT NOTES:

- THE CONTRACTOR SHALL VERIFY PLANT QUANTITIES FROM THE PLANTING PLAN. QUANTITIES SHOWN IN THE LEGEND ARE FOR CONVENIENCE ONLY.
- NOTIFY THE LANDSCAPE ARCHITECT IMMEDIATELY IN THE EVENT OF ANY DISCREPANCIES BETWEEN ACTUAL SITE CONDITIONS AND THE PLANTING PLAN.
- PLANT GROUNDCOVER IN SHRUB AREAS AS NOTED, USE TRIANGULAR SPACING.
- SEE DETAIL AND SPECIFICATION SHEETS FOR ADDITIONAL INFORMATION.
- THERE WILL BE NO MATERIALS OR PLANT MATERIALS SUBSTITUTIONS WITHOUT APPROVAL OF THE OWNER OR THE LANDSCAPE ARCHITECT.
- ALL SLOPES PLANTED WITH GROUND COVER NOT TO EXCEED A 2:1 SLOPE.
- PROVIDE POSITIVE DRAINAGE AWAY FROM ALL BUILDINGS (2:1 MIN)
- IN THE EVENT OF ANY DISCREPANCIES BETWEEN THIS PLAN AND ACTUAL SITE CONDITIONS, THE LANDSCAPE ARCHITECT IS TO BE NOTIFIED IMMEDIATELY.
- ENTIRE SITE IS TO BE ROUGH GRADED BY THE GRADING CONTRACTOR TO WITHIN 3/10TH FOOT OF FINISH GRADE. LANDSCAPE CONTRACTOR IS TO FINE GRADE ALL LANDSCAPE AREAS.
- ALL SITE UTILITIES ARE TO BE PROTECTED DURING CONSTRUCTION. IN THE EVENT OF DISCREPANCIES BETWEEN THE PLANS AND UTILITIES THE CONTRACTOR SHALL NOTIFY THE LANDSCAPE ARCHITECT. ANY DAMAGE TO UTILITIES, STRUCTURES, OR OTHER FEATURES TO REMAIN, AND CAUSED BY THE LANDSCAPE CONTRACTOR SHALL BE REPLACED OR REPAIRED BY THE CONTRACTOR AT NO EXPENSE TO THE OWNER.
- THE WORK IN THESE DRAWINGS AND SPECIFICATIONS MAY RUN CONCURRENTLY WITH WORK BY OTHERS. THE LANDSCAPE CONTRACTOR SHALL COORDINATE THE WORK WITH OTHER CONTRACTORS.
- PRIOR TO ANY DIGGING OR TRENCHING, CALL UNDERGROUND SERVICE ALERT: 1-800-227-2600

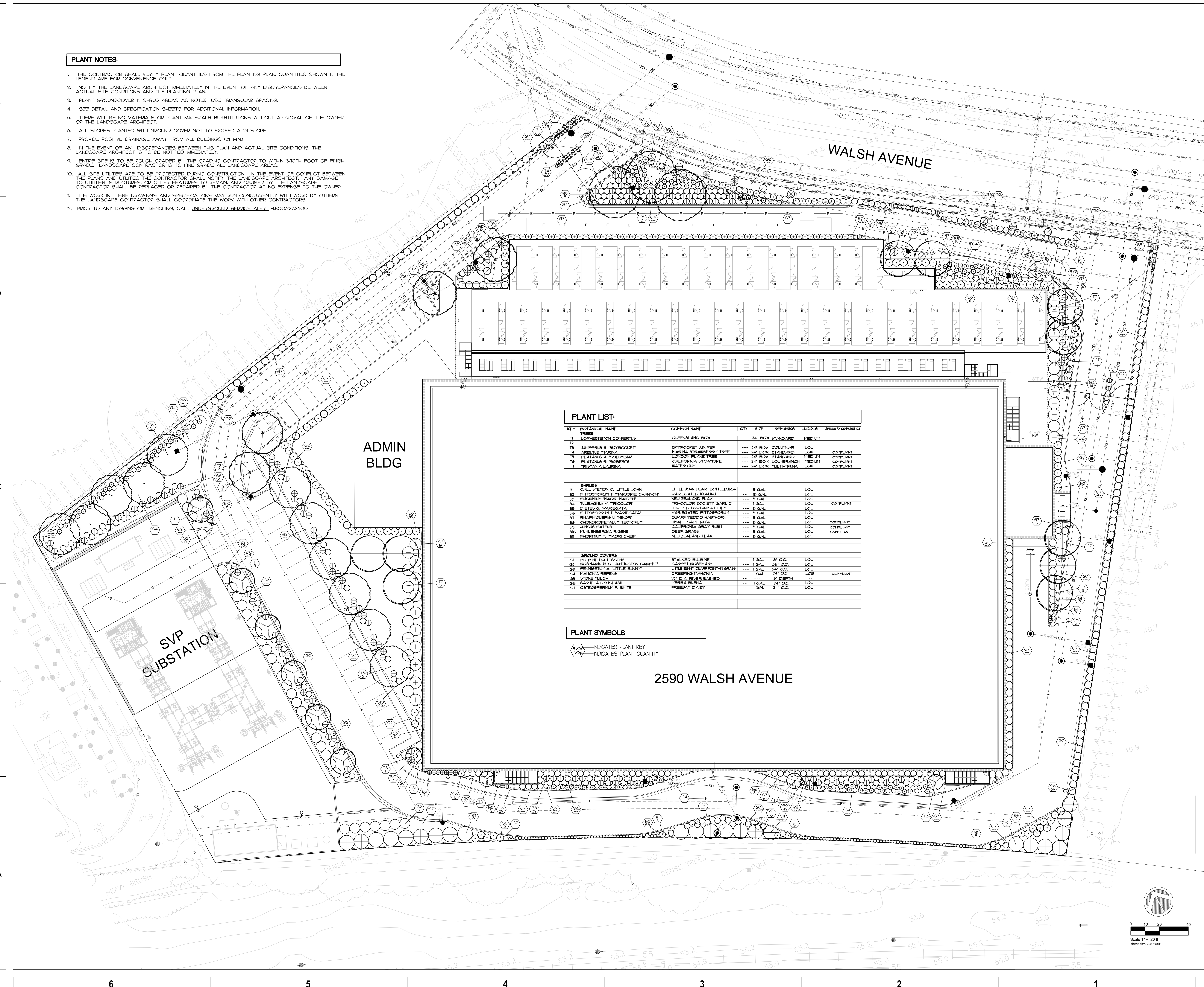

PLANT LIST:

KEY	BOTANICAL NAME	COMMON NAME	QTY.	SIZE	REMARKS	SUCCOLS	INDEX	COMPLIANT
TREES								
T1	LOPHOSTEMON CONFERTUS	QUEENSLAND BOX	24'	BOX	STANDARD	MEDIUM		
T2	---	---	---	---	---	---		
T3	JANIBESUS S. 'SKYROCKET'	SKYROCKET JANIPER	24'	BOX	COLUMNAR	LOW		COMPLIANT
T4	ARBUSULUS MARINA	MARINA STRAWBERRY TREE	24'	BOX	STANDARD	LOW		COMPLIANT
T5	PLATANUS A. 'COLUPIA'	LONDON PLANE TREE	24'	BOX	STANDARD	MEDIUM		COMPLIANT
T6	PLATANUS R. 'ROBERTS'	CALIFORNIA SYCAMORE	24'	BOX	LOW-RANCH	MEDIUM		COMPLIANT
T7	TRISTANIA LAURINA	WATER GUM	24'	BOX	MULTI-TRUNK	LOW		COMPLIANT
SHRUBS								
S1	GALLISTRON C. 'LITTLE JOHN'	LITTLE JOHN DWARF BOTTLEBRUSH	5	GAL.		LOW		
S2	PITTOPORIUM T. 'MARJORIE CHANNON'	VARIEGATED KORUJA	5	GAL.		LOW		
S3	PHORRHUM T. 'MACR. MAIDEN'	NEW ZEALAND FLAX	5	GAL.		LOW		
S4	TILBAGHIA V. 'TRICOLOR'	TRI-COLOR SOCIETY GARLIC	1	GAL.		LOW		COMPLIANT
S5	DIETES G. 'VARIEGATA'	STRIPED KORUJA LILY	5	GAL.		LOW		
S6	PITTOPORIUM T. 'VARIEGATA'	VARIEGATED PITTOPORIUM	5	GAL.		LOW		
S7	DIAPHOROBIS U. 'MINOR'	DWARF REDDIP HAZELHORN	5	GAL.		LOW		
S8	CHONDROPETALUM TECTORIUM	SMALL CAPE RUSH	5	GAL.		LOW		COMPLIANT
S9	JANOUS PATENS	CALIFORNIA GRAY RUSH	5	GAL.		LOW		COMPLIANT
S10	PHLEGENBERGIA ROGENS	DEER GRASS	5	GAL.		LOW		COMPLIANT
S11	PHORRHUM T. 'MACR. CHEIF'	NEW ZEALAND FLAX	5	GAL.		LOW		
GROUND COVERS								
G1	BULBINE FRUTESCENS	STALKED BULBINE	1	GAL.	18" O.C.	LOW		
G2	POSYDANUS O. 'MANTONIA CARPET'	CARPET MOSBERRY	1	GAL.	24" O.C.	LOW		
G3	HEMIBETULA A. 'LITTLE BUNNY'	LITTLE BUNNY DWARF FOUNTAIN GRASS	1	GAL.	24" O.C.	LOW		
G4	MAHONIA REPENS	CREeping MAHONIA	1	GAL.	24" O.C.	LOW		COMPLIANT
G5	BYONE FULCH	10' DIA. RIVER WASHED	---	---	3" DEPTH	---		
G6	BARUEJA DOUGLASSII	YERBA BUENA	1	GAL.	24" O.C.	LOW		
G7	OSTEOSPERMUM F. 'WHITE'	FREEWAY DAISY	1	GAL.	24" O.C.	LOW		

PLANT SYMBOLS

- INDICATES PLANT KEY
- INDICATES PLANT QUANTITY

2590 WALSH AVENUE

OWNER



ARCHITECT

SHEEHAN NAGLE HARTWAY ARCHITECTS

130 East Randolph, Suite 3100
Chicago, IL 60601
o: 312.633.2900
CHICAGO | LONDON

MEP ENGINEER



KW
Mission Critical Engineering
40 E. Rio Sarado
Palo Alto, CA 94301
650.356.3144



CUPERTINO ELECTRIC
1132 NORTH 7TH STREET
SAN JOSE, CA 95112
(408) 808-8000
C-10 LIC. NO. 174837

STRUCTURAL ENGINEER

CIVIL ENGINEER

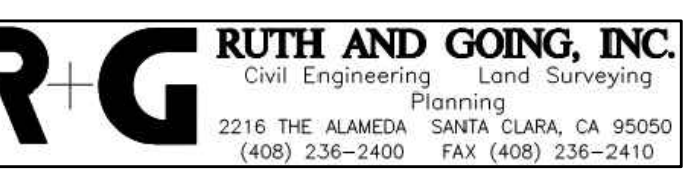

RUTH AND GOING, INC.
Civil Engineering and Surveying
2216 THE ALAMOND SANTA CLARA, CA 95050
(408) 238-2400 FAX: (408) 232-2410

LANDSCAPE ARCHITECT



REED ASSOCIATES LANDSCAPE ARCHITECTURE
477 SOUTH TAAFFE STREET
SUNNYVALE, CALIFORNIA 94086
408-881-9020 PH: 408-881-9022 FX: FAX: 408-881-9020

PROGRESS SET
NOT FOR CONSTRUCTION

No.	Description	Date

VANTAGE CA31
2590 WALSH AVENUE
SANTA CLARA, CA 95051

MASTERPLAN

PRELIMINARY
PLANTING PLAN

L1.0

SCALE: AS NOTED

© 2018 SHEEHAN NAGLE HARTWAY ARCHITECTS, LTD.

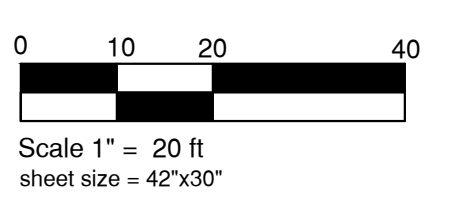

6 5 4 3 2 1

E

D

C

B

A

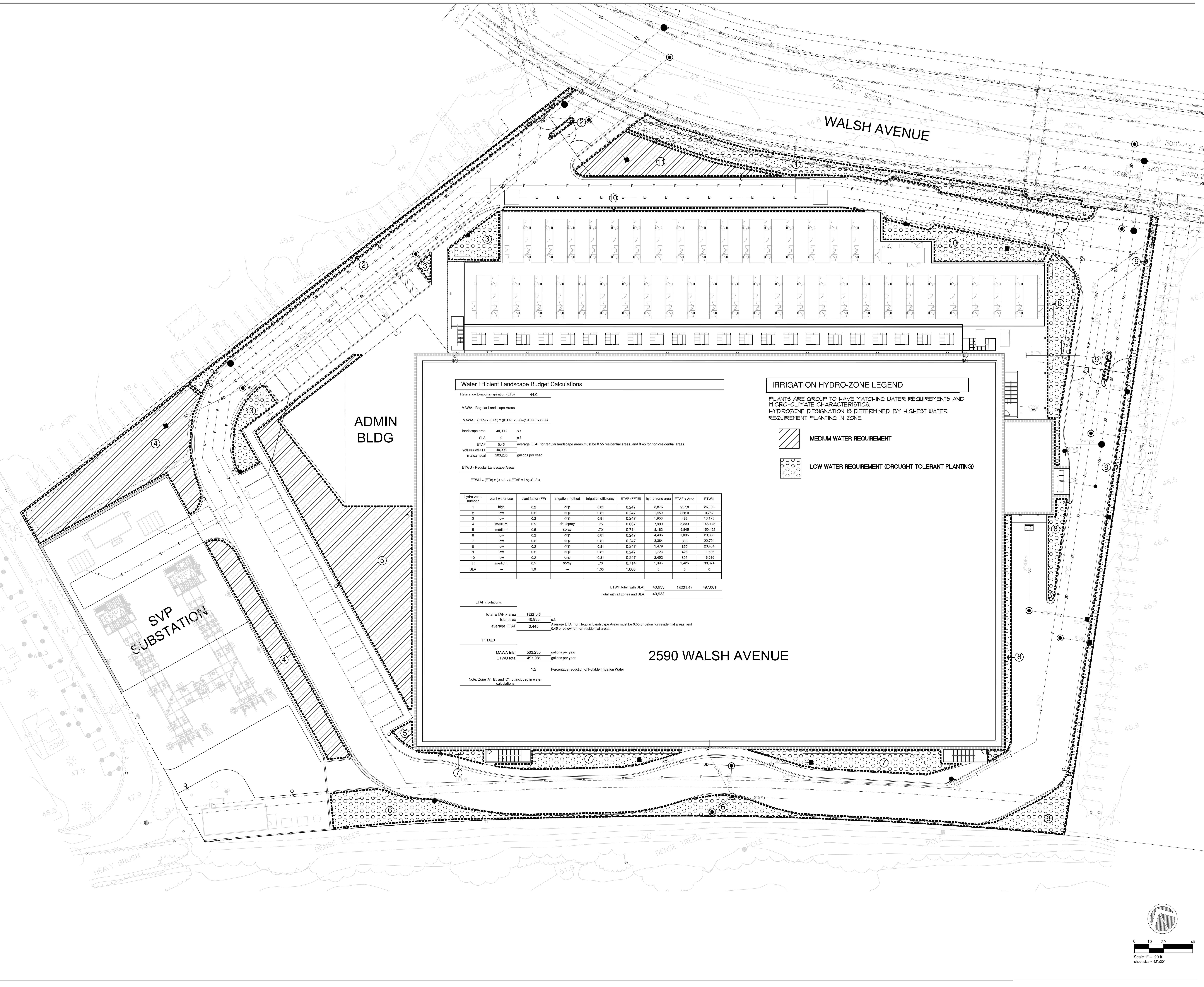

Water Efficient Landscape Budget Calculations

Reference Evapotranspiration (ET₀) 44.0

MWA - Regular Landscape Areas
 $MWA = (ET_0) \times (0.62) \times ((ETAF \times LA) + (ETAF \times SLA))$
 landscape area 40,933 s.f.
 SLA 0 s.f.
 ETAF 0.445 average ETAF for regular landscape areas must be 0.55 for residential areas, and 0.45 for non-residential areas.
 total area with SLA 40,933
 mwa total 903,230 gallons per year

ETWU - Regular Landscape Areas
 $ETWU = (ET_0) \times (0.62) \times ((ETAF \times LA) + (ETAF \times SLA))$

hydro-zone number	plant water use	plant factor (PF)	irrigation method	irrigation efficiency	ETAF (PF/IE)	hydro-zone area	ETAF x Area	ETWU
1	high	0.2	drip	0.81	0.247	3,876	957.0	26,109
2	low	0.2	drip	0.81	0.247	1,450	358.0	9,767
3	low	0.2	drip	0.81	0.247	1,956	483	13,176
4	medium	0.5	drip/spray	75	0.667	7,999	5,333	145,475
5	medium	0.5	spray	70	0.714	8,163	5,845	159,452
6	low	0.2	drip	0.81	0.247	4,436	1,095	29,880
7	low	0.2	drip	0.81	0.247	3,384	836	22,794
8	low	0.2	drip	0.81	0.247	3,879	959	26,434
9	low	0.2	drip	0.81	0.247	1,723	425	11,606
10	low	0.2	drip	0.81	0.247	2,452	605	16,516
11	medium	0.5	spray	70	0.714	1,995	1,425	38,874
SLA	---	1.0	---	1.00	1.000	0	0	0

ETWU total (with SLA) 40,933 18221.43 497,081
 Total with all zones and SLA 40,933

ETAF calculations
 total ETAF x area 18221.43
 total area 40,933 s.f.
 average ETAF 0.445 Average ETAF for Regular Landscape Areas must be 0.55 or below for residential areas, and 0.45 or below for non-residential areas.

TOTALS
 MWA total 903,230 gallons per year
 ETWU total 497,081 gallons per year
 1.2 Percentage reduction of Potable Irrigation Water

Note: Zone 'A', 'B', and 'C' not included in water calculations.

IRRIGATION HYDRO-ZONE LEGEND

PLANTS ARE GROUP TO HAVE MATCHING WATER REQUIREMENTS AND MICRO-CLIMATE CHARACTERISTICS. HYDROZONE DESIGNATION IS DETERMINED BY HIGHEST WATER REQUIREMENT PLANTING IN ZONE.

- MEDIUM WATER REQUIREMENT
- LOW WATER REQUIREMENT (DROUGHT TOLERANT PLANTING)

ADMIN BLDG

2590 WALSH AVENUE

SVP SUBSTATION

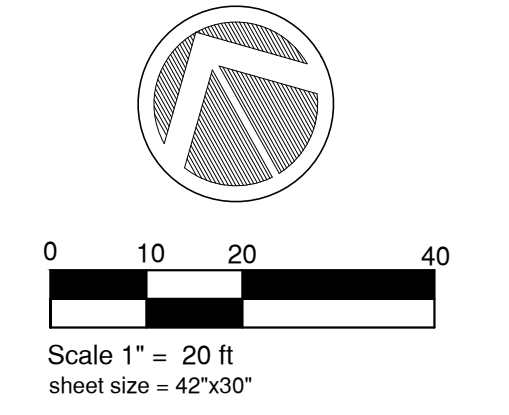

OWNER
VANTAGE DATA CENTERS

ARCHITECT
SHEEHAN NAGLE HARTWAY ARCHITECTS
 130 East Randolph, Suite 3100
 Chicago, IL 60601
 t: 312.633.2900
 CHICAGO | LONDON

MEP ENGINEER
KW
 Mission Critical Engineering
 40 E. Ro Saudo Parkway, 4th Floor
 602.568.3144

STRUCTURAL ENGINEER
E CUPERTINO ELECTRIC
 1132 NORTH 7TH STREET
 SAN JOSE, CA 95112
 (408) 808-8000
 C-10 LIC. NO. 174637

CIVIL ENGINEER
R G RUTH AND GOING, INC.
 Civil Engineering Land Surveying
 2218 THE ALAMOND SANTA CLARA, CA 95050
 (408) 236-2400 FAX: (408) 236-2410

LANDSCAPE ARCHITECT
REED ASSOCIATES
 LANDSCAPE ARCHITECTURE
 477 SOUTH TAAFFE STREET
 SUNNYVALE, CALIFORNIA 94086
 408.481.9020 PH 408.481.9022 FX /R/LA/NET

PROGRESS SET
 NOT FOR CONSTRUCTION

No.	Description	Date

VANTAGE CA31
 2590 WALSH AVENUE
 SANTA CLARA, CA 95051

MASTERPLAN

Landscape
 Hydrozone Plan

L2.0

SCALE: AS NOTED
 © 2018 SHEEHAN NAGLE HARTWAY ARCHITECTS, LTD.