

**DOCKETED**

<b>Docket Number:</b>	21-SPPE-01
<b>Project Title:</b>	CA3 Backup Generating Facility-Vantage
<b>TN #:</b>	238030
<b>Document Title:</b>	CA3BGF Revised General Arrangement and Site Layout Plan
<b>Description:</b>	N/A
<b>Filer:</b>	Scott Galati
<b>Organization:</b>	DayZenLLC
<b>Submitter Role:</b>	Applicant Representative
<b>Submission Date:</b>	5/28/2021 9:54:06 AM
<b>Docketed Date:</b>	5/28/2021



E  
D  
C  
B  
A

2590 WALSH AVENUE  
 TOTAL BUILDING AREA : 469,467 SF  
 TOTAL SITE AREA : 291,616 SF  
 FAR : 1.61

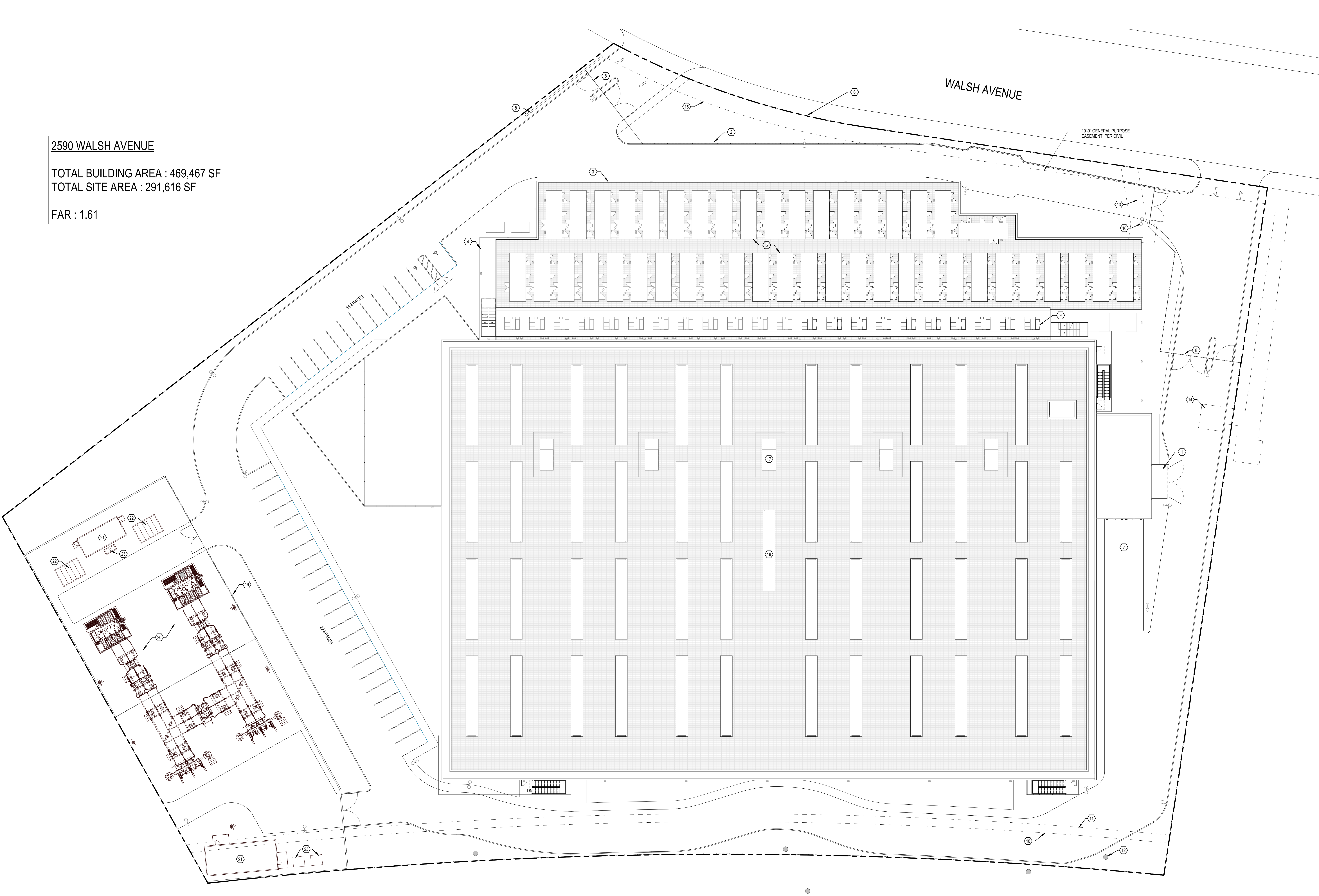

1 ARCHITECTURAL SITE PLAN  
 3/64" = 1'-0"

**GENERAL NOTES**

**SHEET NOTES**  
 NOTE: NOT ALL SHEET NOTES BELOW MAY BE USED ON THIS SHEET

1	TRASH ENCLOSURE
2	FENCING TO BE PROVIDED AS REQUIRED BY PLANNING APPROVAL
3	25' TALL GENERATOR YARD SCREEN
4	15' TALL GENERATOR YARD SCREEN
5	GENERATOR YARD
6	PROPERTY LINE
7	LOADING DOCK
8	SECURITY GATE
9	ELECTRICAL GEAR
10	20' GENERAL PURPOSE EASEMENT
11	5' WIRE CLEARANCE EASEMENT
12	EXISTING ELECTRICAL POLE, TYP.
13	UNDERGROUND ELECTRIC EASEMENT
14	ELECTRIC UTILITY EASEMENT
15	10' GENERAL PURPOSE EASEMENT
16	OFFICE LIGHTING, SEE ELECTRICAL DRAWINGS
17	AIR HANDLING UNIT, TYP.
18	ROOFTOP CHILLER, TYP.
19	SUBSTATION SCREEN WALL
20	SUBSTATION
21	CONTROL ENCLOSURE
22	MEDIUM VOLTAGE BOARD
23	TRANSFORMER

OWNER  
**VANTAGE DATA CENTERS**

---

ARCHITECT  
**SHEEHAN NAGLE HARTRAY ARCH TECTS** 130 East Randolph, Suite 3100  
 Chicago, IL 60601  
 © 312.633.2900 CHICAGO | LONDON

---

MEP ENGINEER  
**KW KW** Mission Critical Engineering  
 40 E. Rio Salado Parkway, 4th Floor  
 602.568.3144

---

**CUPERTINO ELECTRIC**  
 1152 NORTH 7TH STREET  
 SAN JOSE, CA 95112  
 (408) 808-8000  
 C-10 LIC. NO. 174637

---

STRUCTURAL ENGINEER

---

CIVIL ENGINEER  
**R+G RUTH AND GOING, INC.**  
 Civil Engineering - Land Surveying - Planning  
 2216 THE ALAMEDA SANTA CLARA, CA 95050  
 (408) 238-2900 Fax: (408) 238-9410

---

LANDSCAPE ARCHITECT  
**REED ASSOCIATES**  
 LANDSCAPE ARCHITECTURE

PROGRESS SET  
 NOT FOR CONSTRUCTION

No.	Description	Date

**VANTAGE CA31**  
 2590 WALSH AVENUE  
 SANTA CLARA, CA 95051

ARCHITECTURAL SITE PLAN

**A0.0**

