



500 Capitol Mall, Suite 1600
Sacramento, CA 95814
main 916.447.0700
fax 916.447.4781
www.stoel.com

June 19, 2013

MELISSA A. FOSTER
Direct (916) 319-4673
mafooster@stoel.com

VIA HAND DELIVERY AND U.S. MAIL

Ms. Felicia Miller, Siting Project Manager
California Energy Commission
1516 Ninth Street
Sacramento, California 95814



Re: Huntington Beach Energy Project (12-AFC-02)
Applicant's Responses to Staff's Informal Requests (Visual Resources)

Dear Ms. Miller:

On behalf of Applicant AES Southland Development, LLC, please find enclosed herewith for docketing an original and five (5) paper copies and five (5) disks of Applicant's Responses to Staff's Email Requests 1 through 3 (Visual Resources), which include revisions to certain Key Observation Point renderings. Because the size of the response document exceeds 5MB, a disk will be served to all those identified on the enclosed Proof of Service.

Should you have any questions regarding these materials, please do not hesitate to contact Robert Mason or me.

Respectfully submitted,

Melissa A. Foster

MAF:jmw
Enclosures
cc: See Proof of Service List



**BEFORE THE ENERGY RESOURCES CONSERVATION AND DEVELOPMENT
COMMISSION OF THE STATE OF CALIFORNIA
1516 NINTH STREET, SACRAMENTO, CA 95814
1-800-822-6228 – WWW.ENERGY.CA.GOV**

***APPLICATION FOR CERTIFICATION FOR THE
HUNTINGTON BEACH ENERGY PROJECT***

Docket No. 12-AFC-02

**PROOF OF SERVICE
(Revised 03/26/2013)**

SERVICE LIST:

APPLICANT

AES Southland Development, LLC
Stephen O'Kane
Jennifer Didlo
690 Studebaker Road
Long Beach, CA 90803
stephen.okane@aes.com
jennifer.didlo@aes.com

APPLICANT'S CONSULTANTS

CH2MHill
Robert Mason
Project Manager
6 Hutton Centre Drive, Suite 700
Santa Ana, CA 92707
robert.mason@CH2M.com

APPLICANT'S COUNSEL

Melissa A. Foster
Stoel Rives, LLP
500 Capitol Mall, Suite 1600
Sacramento, CA 95814
mafoster@stoel.com

INTERVENOR

Jason Pyle
9071 Kapaa Drive
Huntington Beach, CA 92646
jasonpyle@me.com

INTERESTED AGENCIES

California ISO
e-recipient@caiso.com

INTERESTED AGENCIES (Cont'd.)

California Coastal Commission
Tom Luster
45 Fremont Street, Suite 2000
San Francisco, CA 94105-2219
tluster@coastal.ca.gov

California State Parks
Huntington State Beach
Brian Ketterer
21601 Pacific Coast Highway
Huntington Beach, CA 92646
bketterer@parks.ca.gov

City of Huntington Beach
Planning & Building Department
Jane James
Scott Hess
Aaron Klemm
2000 Main Street, 3rd floor
Huntington Beach, CA 92648
jjames@surfcity-hb.org
shess@surfcity-hb.org
aaron.klemm@surfcity-hb.org

City of Huntington Beach
City Council
Cathy Fikes
Johanna Stephenson
2000 Main Street, 4th floor
Huntington Beach, CA 92648
cfikes@surfcity-hb.org
johanna.stephenson@surfcity-hb.org.

INTERESTED AGENCIES (Cont'd.)

Santa Ana Regional
Water Quality Board
Gary Stewart
3737 Main Street, Suite 500
Riverside, CA 92501-3339
gstewart@waterboards.ca.gov

Huntington Beach
Wetlands Conservancy
Jack Kirkorn, Director
21900 Pacific Coast Highway
Huntington Beach, CA 92646
jfk0480@aol.com

ENERGY COMMISSION STAFF

Felicia Miller
Project Manager
felicia.miller@energy.ca.gov

Kevin W. Bell
Staff Counsel
kevin.w.bell@energy.ca.gov

**ENERGY COMMISSION –
PUBLIC ADVISER**

Blake Roberts
Assistant Public Adviser
publicadviser@energy.ca.gov

COMMISSION DOCKET UNIT

California Energy Commission –
Docket Unit
Attn: Docket No. 12-AFC-02
1516 Ninth Street, MS-4
Sacramento, CA 95814-5512
docket@energy.ca.gov

*indicates change

73705109.1 0043653-00005

**OTHER ENERGY COMMISSION
PARTICIPANTS (LISTED FOR
CONVENIENCE ONLY):**

After docketing, the Docket Unit will provide a copy to the persons listed below. Do not send copies of documents to these persons unless specifically directed to do so.

ANDREW McALLISTER
Commissioner and Presiding Member

KAREN DOUGLAS
Commissioner and Associate Member

Susan Cochran
Hearing Adviser

Hazel Miranda
Adviser to Commissioner McAllister

Patrick Saxton
Adviser to Commissioner McAllister

Galen Lemei
Adviser to Commissioner Douglas

Jennifer Nelson
Adviser to Commissioner Douglas

Eileen Allen
Commissioners' Technical
Adviser for Facility Siting

DECLARATION OF SERVICE

I, Judith M. Warmuth, declare that on June 19, 2013, I served and filed copies of the attached Applicant's Response to Staff's Informal Request (Visual Resources) dated June 19, 2013. This document is accompanied by the most recent Proof of Service, which I copied from the web page for this project at:
http://www.energy.ca.gov/sitingcases/huntington_beach_energy/index.html.

The document has been sent to the other parties on the Service List above in the following manner:

(Check one)

For service to all other parties and filing with the Docket Unit at the Energy Commission:

- ☒ I e-mailed the letter (only) to all e-mail addresses on the Service List above, I directed our staff to hand deliver the disk and letter to the Docket Unit at the Energy Commission, and I personally deposited the disk in the First Class U.S. mail with first class postage to all Service List parties; **OR**
- ☐ Instead of e-mailing the document, I personally delivered it or deposited it in the US mail with first class postage to all of the persons on the Service List for whom a mailing address is given.

I declare under penalty of perjury under the laws of the State of California that the foregoing is true and correct, and that I am over the age of 18 years.

Dated: June 19, 2013

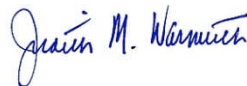

Judith M. Warmuth

Huntington Beach Energy Project

(12-AFC-02)

Staff's Verbal and Email Requests 1-3 (Visual Resources)

Submitted to
California Energy Commission

Prepared by
AES Southland Development, LLC

With Assistance from

CH2MHILL®

2485 Natomas Park Drive
Suite 600
Sacramento, CA 95833

June 19, 2013

Contents

| Section | Page |
|------------------------|--|
| Introduction | 1 |
| Visual Resources | 2 |
| | |
| Figures | |
| 5.13-5R1 | KOP 1 (Revised) View Toward Project from Huntington Beach State Park |
| 5.13-8R1 | KOP 4 (Revised) View Toward Project from Magnolia Street |
| 5.13-9R1 | KOP 5 (Revised) View Toward Project from Huntington-By-The-Sea RV Park |
| SER-3 | Site Plan Indicating Vegetation to be Retained, Removed, and Replaced |

Introduction

Attached are AES Southland Development, LLC's (AES or the Applicant) responses to the California Energy Commission (CEC) Staff's two additional Requests (Informal Data Requests) regarding Visual Resources, one received verbally during a March 22, 2013, telephone call from CEC Project Manager Felicia Miller to Robert Mason, CH2M HILL, Applicant's consultant representative), and the second provided via email on April 22, 2013, regarding the Huntington Beach Energy Project (HBEP) (12-AFC-02) Application for Certification (AFC).

The responses are presented in the same order as CEC Staff presented them and are keyed to the Staff Email Request (SER) numbers. New or revised graphics or tables are numbered in reference to the SER number. For example, the first table used in response to SER 107 would be numbered Table SER107-1. The first figure used in response to SER 107 would be Figure SER107-1, and so on.

Additional tables, figures, or documents submitted in response to a data request (for example, supporting data or stand-alone documents such as plans, folding graphics, etc.) are found at the end of the section and may not be sequentially numbered.

Visual Resources

STAFF'S VERBAL AND EMAIL REQUESTS (INFORMAL DATA REQUESTS)

1. A verbal request (March 22, 2013, telephone call) from Felicia Miller to the Applicant's consultant representative (Robert Mason, CH2M HILL) stated that KOP 5 does not show the air-cooled condenser, and requested a revised KOP 5 to be provided.

Response: As requested, Figure 5.13-9R1 (Revised) has been updated to include the air cooled condenser. The revised KOP 5 viewpoint was established slightly west of the original KOP 5 viewpoint, and inside the front gate of the Huntington-By-The-Sea recreational vehicle park, to permit a more widely encompassing view of the site to be documented. The Revised KOP 5 view uses two photo frames that were spliced together to create a panoramic view that encompasses a portion of the existing power plant facility as well as areas of the site where the HRSGs and air cooled condensers for HBEP Block 2 will be located.

2. An email request (April 22, 2013) from Felicia Miller to the Applicant's consultant representative (Robert Mason, CH2M HILL) requested revision of at least two of the visual simulations, including KOP 1 from Huntington State Beach and KOP 5 from the Huntington By-The-Sea RV and Mobile Home Park. Staff anticipates receiving a revised visual simulation for KOP 5 that shows 1) the previously requested complete field of view for that viewpoint, and 2) the effect of removing landscape plantings that would be evident from this viewpoint. Staff also indicated a revised visual simulation for KOP 4 from Magnolia Street would also be useful because it appears to staff that some of the lower HBEP structures could possibly be screened by existing vegetation that would be removed.

Response: Attached are revised Figures 5.13-5R1, 5.13-8R1, and 5.13-9R1 that present the three revised visual simulations requested for KOPs 1, 4, and 5. These simulations represent the existing views toward the Project and as the Project would appear with five years of landscape growth. These simulations reflect the implementation of landscaping that is planned to replace existing landscaping that must be removed during HBEP construction and to enhance the existing landscaping. The landscaping has been designed with the objective of providing screening of lower project elements and creating a perimeter for the site that has a visually attractive relationship with its surroundings. The landscape scheme includes extension of the existing perimeter wall around the site's west, south, and east sides, and planting of large-size palm trees to create immediate visual effects.

Figure 5.13-5R1 includes a photo of the existing view toward the project site from KOP 1 - Huntington Beach State Park and a simulation of the same view as it would appear 5 years after development (including installation of the landscaping). Figure 5.13-8R1 presents the existing and the simulated 5 years after development (including installation of the landscaping) views from KOP 4 - Magnolia Street. Figure 5.13-9R1 presents a view from a revised KOP 5 - Huntington-By-The-Sea recreational vehicle park (including installation of the landscaping). In response to staff's verbal request received on March 22, 2013, the new KOP 5 viewpoint was established slightly west of the original KOP 5 viewpoint, and inside the front gate of the Huntington-By-The-Sea recreational vehicle park, to permit a more widely encompassing view of the site to be documented. The revised KOP 5 view uses two photo frames that were spliced together to create a panoramic view that encompasses a portion of the existing power plant facility as well as areas of the site where the HRSGs and air-cooled condensers for HBEP Block 2 will be located.

3. In an email request (April 22, 2013) from Felicia Miller to the Applicant's consultant representative (Robert Mason, CH2M HILL) Staff observed that the preliminary grading plan identifies only portions of existing landscaped areas at the site. Staff requests plan views accurately defining both landscaped areas that would be left undisturbed and landscaped areas that would be graded out of the site.

Response:

Figure SER 3-1 presents the HBEP grading plan that was included in the AFC, and the grading plan has been annotated in color in Figure SER 3-1 to identify the areas where existing vegetation on the site will remain, where existing vegetation will be removed and subsequently replaced, and where existing vegetation will be removed and will not be able to be replaced due to the configuration of HBEP Blocks 1 and 2. It should be noted this annotated grading plan does not address the landscaping that will be added in some areas where there presently is no landscaping. It also does not reflect the landscape border on the east (Magnolia Marsh) perimeter of the site (where the existing vegetation is reaching the end of their normal lifespan) that will be replaced and widened as part of HBEP.



A. Existing View



B. Simulated view depicting appearance five years after completion of project development

Figure 5.13-5R1
KOP 1 (Revised) - View Toward Project
from Huntington Beach State Park
 AES Huntington Beach Energy Project
 Huntington Beach, California



A. Existing View



B. Simulated view depicting appearance five years after completion of project development

Figure 5.13-8R1
KOP 4 (Revised) - View Toward
Project from Magnolia Street
 AES Huntington Beach Energy Project
Huntington Beach, California



A. Existing View



B. Simulated view depicting appearance five years after completion of project development

Figure 5.13-9R1
KOP 5 (Revised) - View Toward Project
from Huntington-By-The-Sea RV Park
 AES Huntington Beach Energy Project
 Huntington Beach, California

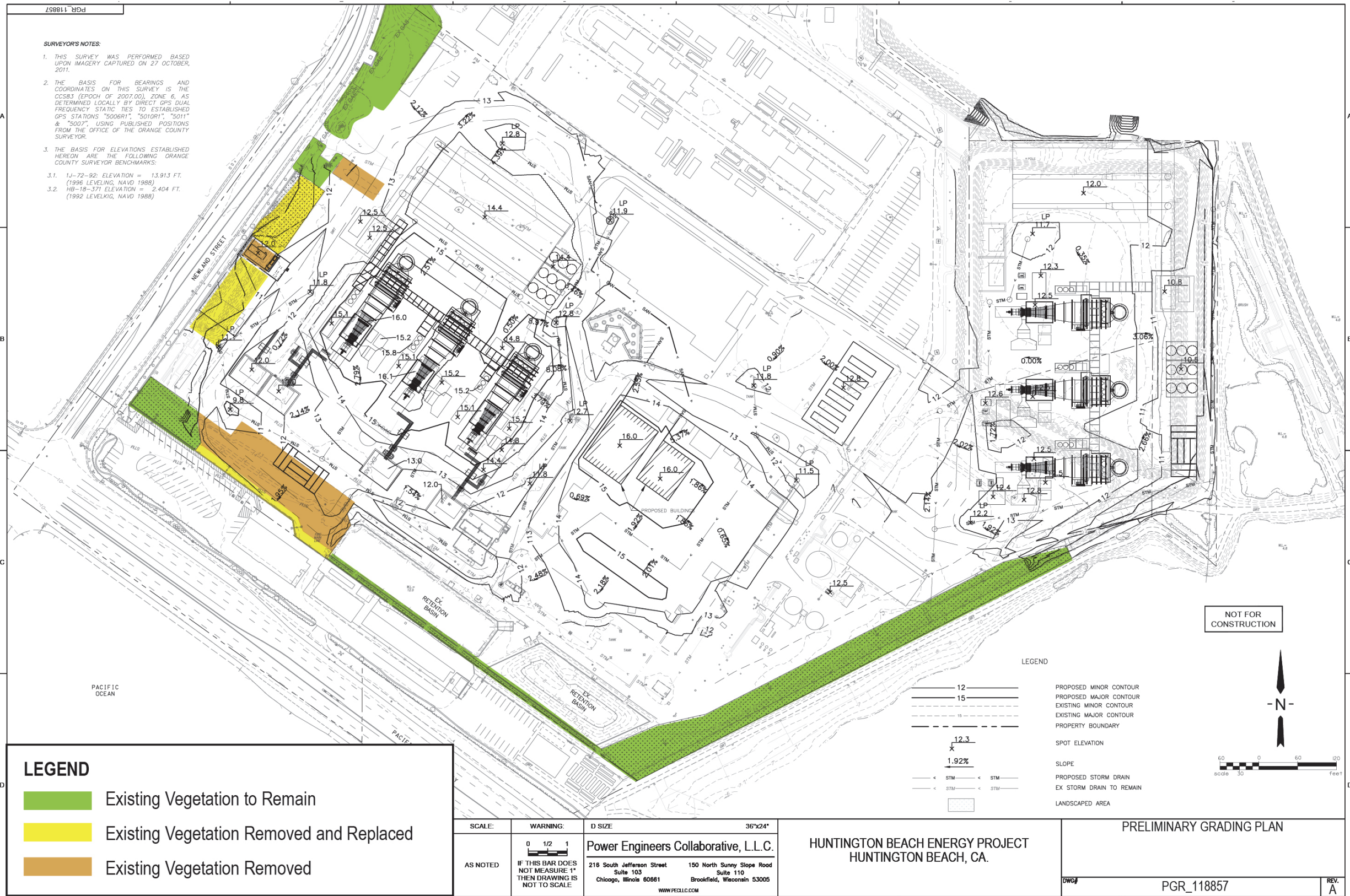

This plan has been modified for illustrative purposes by CH2M HILL, May 22, 2013.

Figure SER-3-1
Site Plan Indicating Vegetation to be Retained, Removed, and Replaced
AES Huntington Beach Energy Project
Huntington Beach, California