



July 2, 2010
DPG 10-158

Ms. Angelique Juarez-Garcia
Compliance Project Manager
California Energy Commission
1516 9th Street, MS-2000
Sacramento, CA 95814-5512

DOCKET	
01-AFC-19C	
DATE	JUL 02 2010
RECD.	JUL 06 2010

**Subject: Cosumnes Power Plant (01-AFC-19)
Proposed Gate Reorientation**

Dear Ms. Juarez-Garcia,

This letter is to inform you of the Cosumnes Power Plant's desire to move the east (main) entry gate approximately 130 feet north of its current location in order to enhance public safety and the safety of visitors waiting permission to enter CPP. The current entry protocol requires all visitors and delivery vehicles (including UPS, FedEx, chemical suppliers, etc.) to communicate via intercom with control room personnel in order to gain entry to CPP after identification is visually verified. In addition, larger delivery vehicles, particularly those conveying materials, products and chemicals must wait for manifest and vehicle inspection prior to escorted entry. This occasionally exposes vehicles to traffic on Clay East Road while awaiting access. Plant personnel suggested the proactive safety measure of simply moving the gate inward along the existing plant entrance road as shown in the attached sketch. A new fence segment would be installed, but the existing fence would also remain in place to define the current plant boundary and maintain security. This enhancement should provide adequate space and maneuverability to prevent visitors and their vehicles from being exposed to cross traffic.

SMUD is hoping that after your review, you will agree that this will enhance safety of those visiting the plant and the general public, and that the activity is minor enough that it can be handled via letter and performed without amendment. Please contact me at (916) 732-7101 if you have any questions or require further information.

Sincerely,

Kevin Hudson, P.E.
Project Development Manager

Attachment

cc: Ross Gould

UNIT DESIGNATIONS

- 1 COMMON
- 2 STEAM TURBINE, GENERATOR & ASSOCIATED EQUIPMENT
- 3 H.V.H.V. CT & ASSOCIATED EQUIPMENT
- 4 H.V.H.V. CT & ASSOCIATED EQUIPMENT

- ELEVATIONS**
- TOP OF CONCRETE = 154'-0"
 - FINISH GRADE = 153'-0"
 - COMPRESSOR AREA = 157'-0"

- SYMBOLGY**
- NEW FIELD LINE/VARIOUS THICKNESSES
 - FUTURE FIELD BOUND
 - FENCE EXIST LINE
 - MAINTENANCE/ACCESS AREA (PARALLEL LINE)
 - ORIGIN/END CENTERLINE (DOTTED LINE)

LEGEND (CONT)

- 1. ELECTRICAL SWITCHYARD AREA
- 2. SWITCHYARD CONTROL BUILDING
- 3. COND. WATER TREAT. TOWER/STORAGE
- 4. EXHAUST TRANSFORMER
- 5. EXHAUST TRANSFORMER
- 6. EXHAUST TRANSFORMER
- 7. EXHAUST TRANSFORMER
- 8. EXHAUST TRANSFORMER
- 9. EXHAUST TRANSFORMER
- 10. EXHAUST TRANSFORMER
- 11. EXHAUST TRANSFORMER
- 12. EXHAUST TRANSFORMER
- 13. EXHAUST TRANSFORMER
- 14. EXHAUST TRANSFORMER
- 15. EXHAUST TRANSFORMER
- 16. EXHAUST TRANSFORMER
- 17. EXHAUST TRANSFORMER
- 18. EXHAUST TRANSFORMER
- 19. EXHAUST TRANSFORMER
- 20. EXHAUST TRANSFORMER
- 21. EXHAUST TRANSFORMER
- 22. EXHAUST TRANSFORMER
- 23. EXHAUST TRANSFORMER
- 24. EXHAUST TRANSFORMER
- 25. EXHAUST TRANSFORMER
- 26. EXHAUST TRANSFORMER
- 27. EXHAUST TRANSFORMER
- 28. EXHAUST TRANSFORMER
- 29. EXHAUST TRANSFORMER
- 30. EXHAUST TRANSFORMER
- 31. EXHAUST TRANSFORMER
- 32. EXHAUST TRANSFORMER
- 33. EXHAUST TRANSFORMER
- 34. EXHAUST TRANSFORMER
- 35. EXHAUST TRANSFORMER
- 36. EXHAUST TRANSFORMER
- 37. EXHAUST TRANSFORMER
- 38. EXHAUST TRANSFORMER
- 39. EXHAUST TRANSFORMER
- 40. EXHAUST TRANSFORMER
- 41. EXHAUST TRANSFORMER
- 42. EXHAUST TRANSFORMER
- 43. EXHAUST TRANSFORMER
- 44. EXHAUST TRANSFORMER
- 45. EXHAUST TRANSFORMER
- 46. EXHAUST TRANSFORMER
- 47. EXHAUST TRANSFORMER
- 48. EXHAUST TRANSFORMER
- 49. EXHAUST TRANSFORMER
- 50. EXHAUST TRANSFORMER

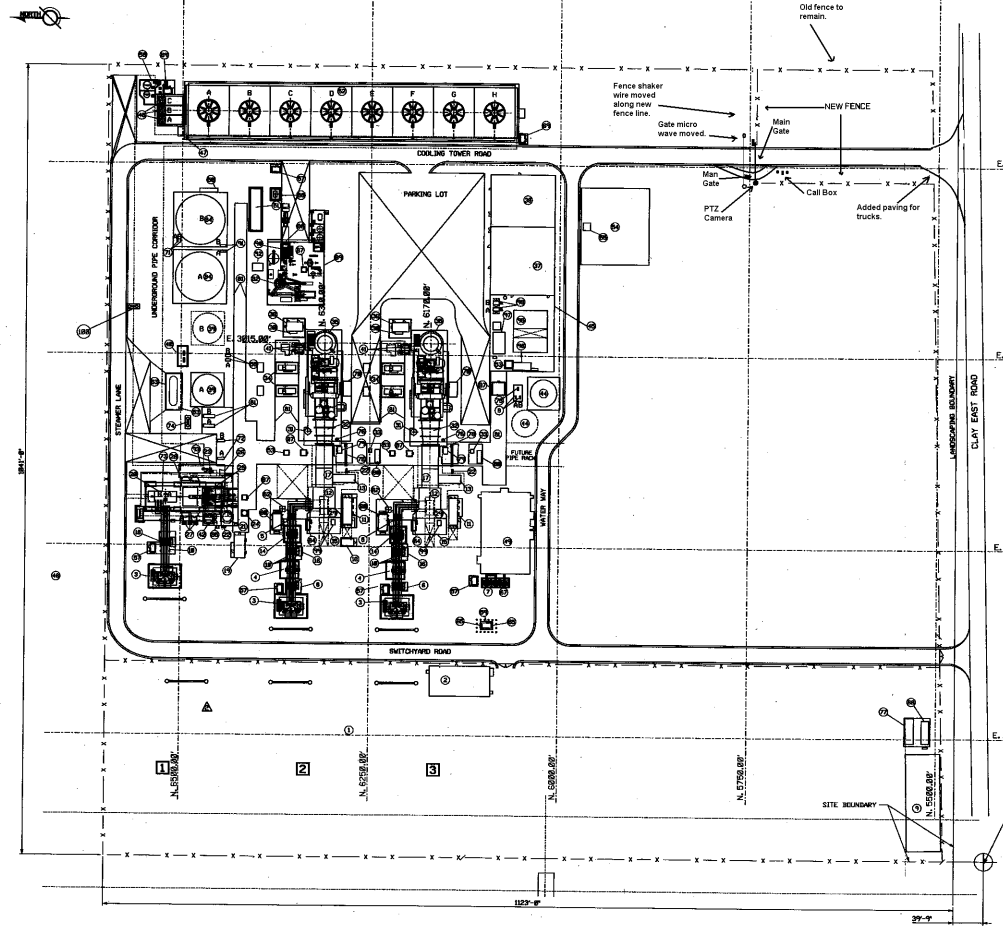

Sacramento Municipal
Utility District
APPROVED
Consumer Power Plant
Chief Building Official

PLANT GRID CSPE GRID
N. 5436.18' N. 1,095,476.18'
E. 2336.66' E. 6,812,336.66'
CALIFORNIA STATE PLANE COORDINATES GRID



NO.	DATE	BY	REVISION
1	12/20/03	JL	ISSUE FOR PERMITTING
2	01/20/04	JL	REVISED PER COMMENTS
3	02/10/04	JL	REVISED PER COMMENTS
4	03/10/04	JL	REVISED PER COMMENTS
5	04/10/04	JL	REVISED PER COMMENTS
6	05/10/04	JL	REVISED PER COMMENTS
7	06/10/04	JL	REVISED PER COMMENTS
8	07/10/04	JL	REVISED PER COMMENTS
9	08/10/04	JL	REVISED PER COMMENTS
10	09/10/04	JL	REVISED PER COMMENTS
11	10/10/04	JL	REVISED PER COMMENTS
12	11/10/04	JL	REVISED PER COMMENTS
13	12/10/04	JL	REVISED PER COMMENTS
14	01/10/05	JL	REVISED PER COMMENTS
15	02/10/05	JL	REVISED PER COMMENTS
16	03/10/05	JL	REVISED PER COMMENTS
17	04/10/05	JL	REVISED PER COMMENTS
18	05/10/05	JL	REVISED PER COMMENTS
19	06/10/05	JL	REVISED PER COMMENTS
20	07/10/05	JL	REVISED PER COMMENTS
21	08/10/05	JL	REVISED PER COMMENTS
22	09/10/05	JL	REVISED PER COMMENTS
23	10/10/05	JL	REVISED PER COMMENTS
24	11/10/05	JL	REVISED PER COMMENTS
25	12/10/05	JL	REVISED PER COMMENTS
26	01/10/06	JL	REVISED PER COMMENTS
27	02/10/06	JL	REVISED PER COMMENTS
28	03/10/06	JL	REVISED PER COMMENTS
29	04/10/06	JL	REVISED PER COMMENTS
30	05/10/06	JL	REVISED PER COMMENTS
31	06/10/06	JL	REVISED PER COMMENTS
32	07/10/06	JL	REVISED PER COMMENTS
33	08/10/06	JL	REVISED PER COMMENTS
34	09/10/06	JL	REVISED PER COMMENTS
35	10/10/06	JL	REVISED PER COMMENTS
36	11/10/06	JL	REVISED PER COMMENTS
37	12/10/06	JL	REVISED PER COMMENTS
38	01/10/07	JL	REVISED PER COMMENTS
39	02/10/07	JL	REVISED PER COMMENTS
40	03/10/07	JL	REVISED PER COMMENTS
41	04/10/07	JL	REVISED PER COMMENTS
42	05/10/07	JL	REVISED PER COMMENTS
43	06/10/07	JL	REVISED PER COMMENTS
44	07/10/07	JL	REVISED PER COMMENTS
45	08/10/07	JL	REVISED PER COMMENTS
46	09/10/07	JL	REVISED PER COMMENTS
47	10/10/07	JL	REVISED PER COMMENTS
48	11/10/07	JL	REVISED PER COMMENTS
49	12/10/07	JL	REVISED PER COMMENTS
50	01/10/08	JL	REVISED PER COMMENTS
51	02/10/08	JL	REVISED PER COMMENTS
52	03/10/08	JL	REVISED PER COMMENTS
53	04/10/08	JL	REVISED PER COMMENTS
54	05/10/08	JL	REVISED PER COMMENTS
55	06/10/08	JL	REVISED PER COMMENTS
56	07/10/08	JL	REVISED PER COMMENTS
57	08/10/08	JL	REVISED PER COMMENTS
58	09/10/08	JL	REVISED PER COMMENTS
59	10/10/08	JL	REVISED PER COMMENTS
60	11/10/08	JL	REVISED PER COMMENTS
61	12/10/08	JL	REVISED PER COMMENTS
62	01/10/09	JL	REVISED PER COMMENTS
63	02/10/09	JL	REVISED PER COMMENTS
64	03/10/09	JL	REVISED PER COMMENTS
65	04/10/09	JL	REVISED PER COMMENTS
66	05/10/09	JL	REVISED PER COMMENTS
67	06/10/09	JL	REVISED PER COMMENTS
68	07/10/09	JL	REVISED PER COMMENTS
69	08/10/09	JL	REVISED PER COMMENTS
70	09/10/09	JL	REVISED PER COMMENTS
71	10/10/09	JL	REVISED PER COMMENTS
72	11/10/09	JL	REVISED PER COMMENTS
73	12/10/09	JL	REVISED PER COMMENTS
74	01/10/10	JL	REVISED PER COMMENTS
75	02/10/10	JL	REVISED PER COMMENTS
76	03/10/10	JL	REVISED PER COMMENTS
77	04/10/10	JL	REVISED PER COMMENTS
78	05/10/10	JL	REVISED PER COMMENTS
79	06/10/10	JL	REVISED PER COMMENTS
80	07/10/10	JL	REVISED PER COMMENTS
81	08/10/10	JL	REVISED PER COMMENTS
82	09/10/10	JL	REVISED PER COMMENTS
83	10/10/10	JL	REVISED PER COMMENTS
84	11/10/10	JL	REVISED PER COMMENTS
85	12/10/10	JL	REVISED PER COMMENTS
86	01/10/11	JL	REVISED PER COMMENTS
87	02/10/11	JL	REVISED PER COMMENTS
88	03/10/11	JL	REVISED PER COMMENTS
89	04/10/11	JL	REVISED PER COMMENTS
90	05/10/11	JL	REVISED PER COMMENTS
91	06/10/11	JL	REVISED PER COMMENTS
92	07/10/11	JL	REVISED PER COMMENTS
93	08/10/11	JL	REVISED PER COMMENTS
94	09/10/11	JL	REVISED PER COMMENTS
95	10/10/11	JL	REVISED PER COMMENTS
96	11/10/11	JL	REVISED PER COMMENTS
97	12/10/11	JL	REVISED PER COMMENTS
98	01/10/12	JL	REVISED PER COMMENTS
99	02/10/12	JL	REVISED PER COMMENTS
100	03/10/12	JL	REVISED PER COMMENTS

SMUD
SACRAMENTO MUNICIPAL UTILITY DISTRICT

**CONSUMER POWER PLANT
EQUIPMENT ARRANGEMENT
LAYOUT**

DATE: 12/20/03
SCALE: AS SHOWN
PROJECT NO.: 0010325-100.100
SHEET NO.: 01/3