



September 17, 2010

Mr. Christopher Meyer  
CEC Project Manager  
Attn: Docket No. 08-AFC-13  
California Energy Commission  
1516 Ninth Street  
Sacramento, CA 95814-5512

**DOCKET**

**08-AFC-13**

DATE SEP 17 2010

RECD. SEP 17 2010

RE: Calico Solar (formerly Solar One) Project (08-AFC-13)  
Applicant's Submittal of Map and GIS Layers from 2007 and 2008 Surveys and Complete  
URS Survey Data Pertaining to Desert Tortoise

Dear Mr. Meyer:

Tessera Solar hereby submits a map and GIS layers from 2007 and 2008 Desert Tortoise surveys and a complete set of URS GIS data pertaining to Desert Tortoise. I certify under penalty of perjury that the foregoing is true, correct, and complete to the best of my knowledge.

Sincerely,

Felicia L. Bellows  
Vice President of Development

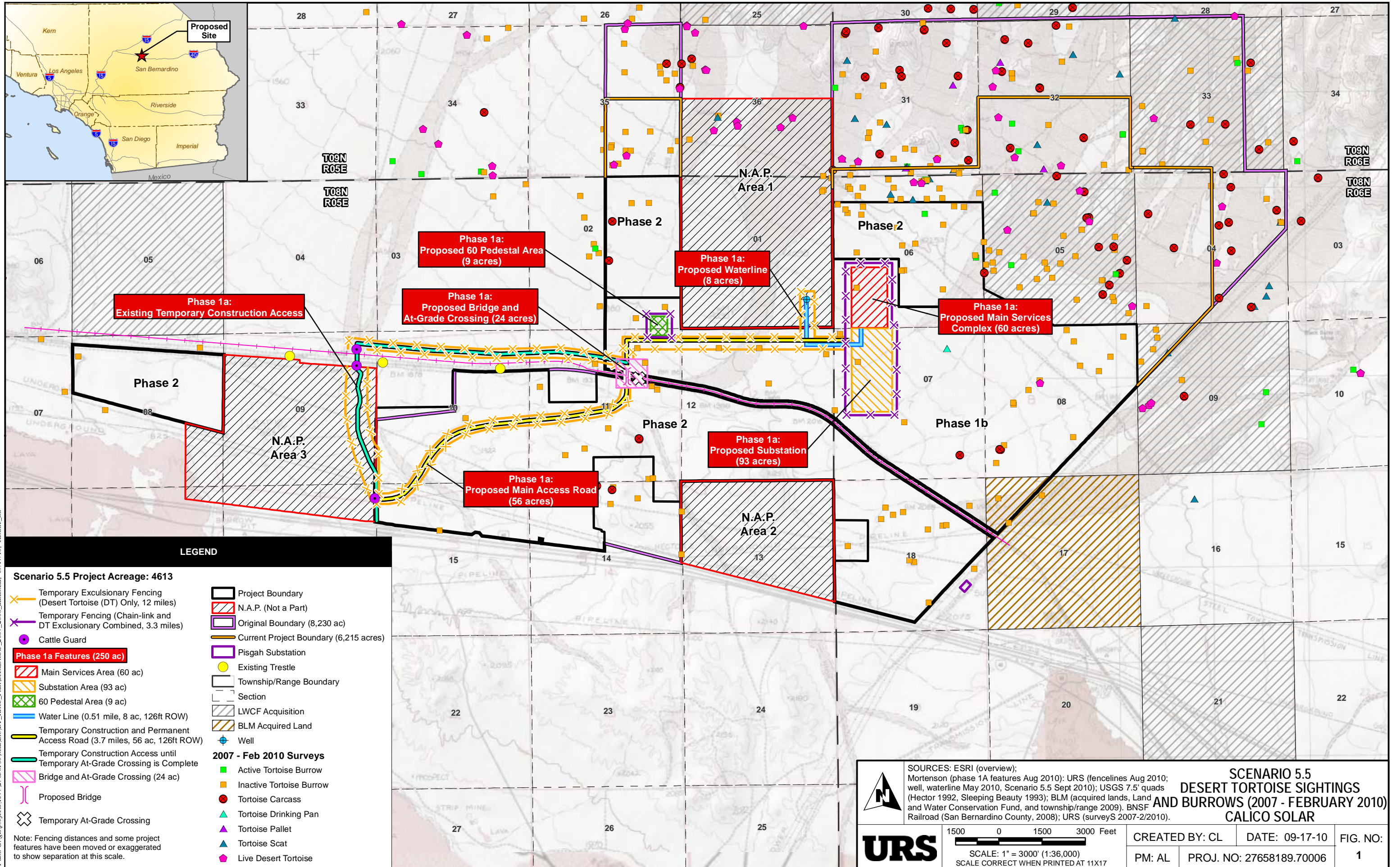

Path: G:\gis\projects\157276581\00\mxd\Bio\DT\_Reloc\_Plan\Scenario5.5\_2007\_2008\_data.mxd, 09/17/10, comille\_lill

**LEGEND**

**Scenario 5.5 Project Acreage: 4613**

- Temporary Exclusionary Fencing (Desert Tortoise (DT) Only, 12 miles)
- Temporary Fencing (Chain-link and DT Exclusionary Combined, 3.3 miles)
- Cattle Guard

**Phase 1a Features (250 ac)**

- Main Services Area (60 ac)
- Substation Area (93 ac)
- 60 Pedestal Area (9 ac)
- Water Line (0.51 mile, 8 ac, 126ft ROW)
- Temporary Construction and Permanent Access Road (3.7 miles, 56 ac, 126ft ROW)
- Temporary Construction Access until Temporary At-Grade Crossing is Complete
- Bridge and At-Grade Crossing (24 ac)
- Proposed Bridge
- Temporary At-Grade Crossing

- Project Boundary
- N.A.P. (Not a Part)
- Original Boundary (8,230 ac)
- Current Project Boundary (6,215 acres)
- Pisgah Substation
- Existing Trestle
- Township/Range Boundary
- Section
- LWCF Acquisition
- BLM Acquired Land
- Well

**2007 - Feb 2010 Surveys**

- Active Tortoise Burrow
- Inactive Tortoise Burrow
- Tortoise Carcass
- Tortoise Drinking Pan
- Tortoise Pallet
- Tortoise Scat
- Live Desert Tortoise

Note: Fencing distances and some project features have been moved or exaggerated to show separation at this scale.

**SCENARIO 5.5  
DESERT TORTOISE SIGHTINGS  
AND BURROWS (2007 - FEBRUARY 2010)  
CALICO SOLAR**

SOURCES: ESRI (overview); Mortenson (phase 1A features Aug 2010); URS (fencelines Aug 2010; well, waterline May 2010, Scenario 5.5 Sept 2010); USGS 7.5' quads (Hector 1992, Sleeping Beauty 1993); BLM (acquired lands, Land and Water Conservation Fund, and township/range 2009). BNSF Railroad (San Bernardino County, 2008); URS (surveyS 2007-2/2010).

1500 0 1500 3000 Feet  
 SCALE: 1" = 3000' (1:36,000)  
 SCALE CORRECT WHEN PRINTED AT 11X17

CREATED BY: CL DATE: 09-17-10 FIG. NO:  
 PM: AL PROJ. NO: 27658189.70006 1

**URS**



**BEFORE THE ENERGY RESOURCES CONSERVATION AND DEVELOPMENT  
COMMISSION OF THE STATE OF CALIFORNIA  
1516 NINTH STREET, SACRAMENTO, CA 95814  
1-800-822-6228 – WWW.ENERGY.CA.GOV**

**APPLICATION FOR CERTIFICATION**

**Docket No. 08-AFC-13**

***For the CALICO SOLAR (Formerly SES Solar One)***

**PROOF OF SERVICE  
(Revised 8/9/10)**

**APPLICANT**

Felicia Bellows  
Vice President of Development  
& Project Manager  
Tessera Solar  
4800 North Scottsdale Road,  
#5500  
Scottsdale, AZ 85251  
[felicia.bellows@tesseractosolar.com](mailto:felicia.bellows@tesseractosolar.com)

**INTERESTED AGENCIES**

California ISO  
[e-recipient@caiso.com](mailto:e-recipient@caiso.com)  
  
Jim Stobaugh  
BLM – Nevada State Office  
P.O. Box 12000  
Reno, NV 89520  
[jim\\_stobaugh@blm.gov](mailto:jim_stobaugh@blm.gov)

California Unions for Reliable  
Energy (CURE)  
c/o: Loulena A. Miles,  
Marc D. Joseph  
Adams Broadwell Joseph  
& Cardozo  
601 Gateway Boulevard, Ste. 1000  
South San Francisco, CA 94080  
[lmiles@adamsbroadwell.com](mailto:lmiles@adamsbroadwell.com)

**CONSULTANT**

Angela Leiba  
AFC Project Manager  
URS Corporation  
1615 Murray Canyon Rd.,  
#1000  
San Diego, CA 92108  
[angela\\_leiba@URSCorp.com](mailto:angela_leiba@URSCorp.com)

Rich Rotte, Project Manager  
Bureau of Land Management  
Barstow Field Office  
2601 Barstow Road  
Barstow, CA 92311  
[richard\\_rotte@blm.gov](mailto:richard_rotte@blm.gov)

Defenders of Wildlife  
Joshua Basofin  
1303 J Street, Suite 270  
Sacramento, California 95814  
*e-mail service preferred*  
[jbasofin@defenders.org](mailto:jbasofin@defenders.org)

**APPLICANT'S COUNSEL**

Allan J. Thompson  
Attorney at Law  
21 C Orinda Way #314  
Orinda, CA 94563  
[allanori@comcast.net](mailto:allanori@comcast.net)

Becky Jones  
California Department of  
Fish & Game  
36431 41st Street East  
Palmdale, CA 93552  
[dfgpalm@adelphia.net](mailto:dfgpalm@adelphia.net)

Society for the Conservation of  
Bighorn Sheep  
Bob Burke & Gary Thomas  
P.O. Box 1407  
Yermo, CA 92398  
[cameracoordinator@sheepsociety.com](mailto:cameracoordinator@sheepsociety.com)

Ella Foley Gannon, Partner  
Bingham McCutchen, LLP  
Three Embarcadero Center  
San Francisco, CA 94111  
[ella.gannon@bingham.com](mailto:ella.gannon@bingham.com)

**INTERVENORS**

County of San Bernardino  
Ruth E. Stringer,  
County Counsel  
Bart W. Brizzee,  
Deputy County Counsel  
385 N. Arrowhead Avenue,  
4<sup>th</sup> Floor  
San Bernardino, CA 92415-  
[bbrizzee@cc.sbcounty.gov](mailto:bbrizzee@cc.sbcounty.gov)

Basin and Range Watch  
Laura Cunningham &  
Kevin Emmerich  
P.O. Box 70  
Beatty, NV 89003  
[atomicoadranch@netzero.net](mailto:atomicoadranch@netzero.net)

## INTERVENORS CONT.

Patrick C. Jackson  
600 N. Darwood Avenue  
San Dimas, CA 91773  
*e-mail service preferred*  
[ochsjack@earthlink.net](mailto:ochsjack@earthlink.net)

Gloria D. Smith, Senior Attorney  
**\*Travis Ritchie**  
Sierra Club  
85 Second Street, Second floor  
San Francisco, CA 94105  
[gloria.smith@sierraclub.org](mailto:gloria.smith@sierraclub.org)  
[travis.ritchie@sierraclub.org](mailto:travis.ritchie@sierraclub.org)

Newberry Community  
Service District  
Wayne W. Weierbach  
P.O. Box 206  
Newberry Springs, CA 92365  
[newberryCSD@gmail.com](mailto:newberryCSD@gmail.com)

Cynthia Lea Burch  
Steven A. Lamb  
Anne Alexander  
Katten Muchin Rosenman LLP  
2029 Century Park East,  
Ste. 2700  
Los Angeles, CA 90067-3012  
[Cynthia.burch@kattenlaw.com](mailto:Cynthia.burch@kattenlaw.com)  
[Steven.lamb@kattenlaw.com](mailto:Steven.lamb@kattenlaw.com)  
[Anne.alexander@kattenlaw.com](mailto:Anne.alexander@kattenlaw.com)

## ENERGY COMMISSION

ANTHONY EGGERT  
Commissioner and Presiding Member  
[aeggert@energy.state.ca.us](mailto:aeggert@energy.state.ca.us)

JEFFREY D. BYRON  
Commissioner and Associate Member  
[jbyron@energy.state.ca.us](mailto:jbyron@energy.state.ca.us)

Paul Kramer  
Hearing Officer  
[pkramer@energy.state.ca.us](mailto:pkramer@energy.state.ca.us)

Lorraine White, Adviser to  
Commissioner Eggert  
*e-mail service preferred*  
[lwhite@energy.state.ca.us](mailto:lwhite@energy.state.ca.us)

Kristy Chew, Adviser to  
Commissioner Byron  
*e-mail service preferred*  
[kchew@energy.state.ca.us](mailto:kchew@energy.state.ca.us)

Caryn Holmes  
Staff Counsel  
[cholmes@energy.state.ca.us](mailto:cholmes@energy.state.ca.us)

Steve Adams  
Co-Staff Counsel  
[sadams@energy.state.ca.us](mailto:sadams@energy.state.ca.us)

Christopher Meyer  
Project Manager  
[cmeyer@energy.state.ca.us](mailto:cmeyer@energy.state.ca.us)

Jennifer Jennings  
Public Adviser  
*e-mail service preferred*  
[publicadviser@energy.state.ca.us](mailto:publicadviser@energy.state.ca.us)

DECLARATION OF SERVICE

I, Darin Neufeld, declare that on September 17, 2010, I served and filed copies of the attached Applicant's Submittal of Map and GIS Layers from 2007 and 2008 Surveys and Complete URS Survey Data Pertaining to Desert Tortoise. The original document, filed with the Docket Unit, is accompanied by a copy of the most recent Proof of Service list, located on the web page for this project at: [[www.energy.ca.gov/sitingcases/solarone](http://www.energy.ca.gov/sitingcases/solarone)].

The documents have been sent to both the other parties in this proceeding (as shown on the Proof of Service list) and to the Commission's Docket Unit, in the following manner:

*(Check all that Apply)*

FOR SERVICE TO ALL OTHER PARTIES:

- sent electronically to all email addresses on the Proof of Service list;
- by personal delivery;
- by delivering on this date, for mailing with the United States Postal Service with first-class postage thereon fully prepaid, to the name and address of the person served, for mailing that same day in the ordinary course of business; that the envelope was sealed and placed for collection and mailing on that date to those addresses **NOT** marked "email preferred."

**AND**

FOR FILING WITH THE ENERGY COMMISSION:

- sending an original paper copy and one electronic copy, mailed and emailed respectively, to the address below (*preferred method*);

**OR**

- depositing in the mail an original and 12 paper copies, as follows:

**CALIFORNIA ENERGY COMMISSION**

Attn: Docket No. 08-AFC-13  
1516 Ninth Street, MS-4  
Sacramento, CA 95814-5512  
[docket@energy.state.ca.us](mailto:docket@energy.state.ca.us)

I declare under penalty of perjury that the foregoing is true and correct, that I am employed in the county where this mailing occurred, and that I am over the age of 18 years and not a party to the proceeding.

\_\_\_\_\_  
Original Signed By  
Darin Neufeld