

August 16, 2010

Mr. Christopher Meyer
CEC Project Manager
Attn: Docket No. 08-AFC-13
California Energy Commission
1516 Ninth Street
Sacramento, CA 95814-5512

DOCKET	
08-AFC-13	
DATE	<u>AUG 16 2010</u>
RECD.	<u>AUG 16 2010</u>

RE: Calico Solar (formerly Solar One) Project (08-AFC-13)
Applicant's Detention Basin Specifications and Figures

Dear Mr. Meyer:

Tessera Solar hereby submits the Applicant's Detention Basin Specifications and Detention Basin, Base Map and Drainage Figures. These figures provide additional information that was requested during the evidentiary hearing for the Calico Solar Project during August 4-6, 2010.

The sixteen detention basins are placed within the floodplains of 16 of the major washes flowing on to the site. The purpose of the basins is to attenuate the peak volume of the offsite flows from the washes prior to the flows crossing the SunCatcher field. The attenuation will lower the flow rate and height in the existing natural washes, resulting in flood control. The majority of the sediment and the flow volume will still flow within the existing natural channels; however some sediment will be deposited within the basins and some increased infiltration and evaporation will occur due to the holding of water in the basins. The basins are designed to drain either through the outlet structures, evaporation or infiltration. The basins are to capture some sediment to lower the maintenance of the SunCatcher field due to sediment deposits.

I certify under penalty of perjury that the foregoing is true, correct, and complete to the best of my knowledge.

Sincerely,



Felicia L. Bellows
Vice President of Development

This page intentionally left blank



Calico Solar
Debris Basin Quantities
8/16/2010



Debris Basin	Basin Storage Volume (Acre-ft)	Basin Dimensions (ft)			Basin Earthwork Volume (Cu. Yd.)			Disturbance Area (Acres)	
		Width	Length	Depth	Cut	Fill	Net		
100-1*	24.50	375	375	10.00	56,052	2,107	-53,944	Cut	4.20
100-2*	30.50	300	550	10.00	79,006	2,693	-76,313	Cut	5.37
100-3*	39.00	350	575	10.00	82,962	5,019	-77,943	Cut	6.30
101-1*	50.00	425	675	10.00	177,746	1,143	-176,603	Cut	8.86
101-2*	50.00	425	550	10.00	157,823	4,906	-152,917	Cut	8.81
101-3*	47.35	325	750	10.00	112,702	5,100	-107,602	Cut	8.06
101-4*	50.25	450	750	10.00	132,643	4,401	-128,243	Cut	8.44
102-1	49.60	400	445	15.00	170,270	1,946	-168,324	Cut	7.48
102-2	49.60	400	445	15.00	138,319	3,956	-134,363	Cut	7.05
102-3	50.00	360	500	15.00	123,094	4,685	-118,409	Cut	6.61
102-4	50.00	360	500	15.00	122,434	3,577	-118,857	Cut	6.45
102-5	50.00	360	500	15.00	115,741	5,009	-110,732	Cut	6.56
102-6	50.00	360	500	15.00	131,212	5,766	-125,446	Cut	7.16
102-7	50.00	360	500	15.00	137,336	5,263	-132,073	Cut	7.12
102-8	49.60	400	445	15.00	154,081	3,141	-150,940	Cut	6.98
103-1*	47.50	300	850	10.00	142,122	2,907	-139,214	Cut	8.45

*Basin shapes are irregular in geometry due to topography, the dimensions shown are general in nature. The basin volumes shown are actual calculated volumes.

Notes:

1. Depths shown for basins are calculated from the top of basin berm to the bottom of basin.
 2. Under the California Water Code, Division 3, Part 1, Chapter 1 on page 2, these detention basins do not fall under the definition of dams as they fall under the following exclusion:
 - 6003. Any such barrier which is or will be not in excess of 6 feet, regardless of storage capacity, or which has or will have a storage capacity not in excess of 15 acre-feet, regardless of height, shall not be considered a dam.
- The basins are designed to have a water impoundment depth of three feet in height from the natural bed of the stream or watercourse at the downstream toe of the barrier. The barrier is five feet in height from the natural bed of the stream or watercourse at the downstream toe and is under the six foot height restriction for Safety of Dams jurisdiction.

This page intentionally left blank



Westwood

Westwood Professional Services, Inc.
7699 Anagram Drive
Eden Prairie, MN 55344

PHONE 952-937-5150
FAX 952-937-5822
TOLL FREE 1-888-937-5150

www.westwoodps.com

Designed: ADC

Checked: DDB

Drawn: ADC

Record Drawing by/date:

Revisions:
DATE DESCRIPTION

Prepared for:

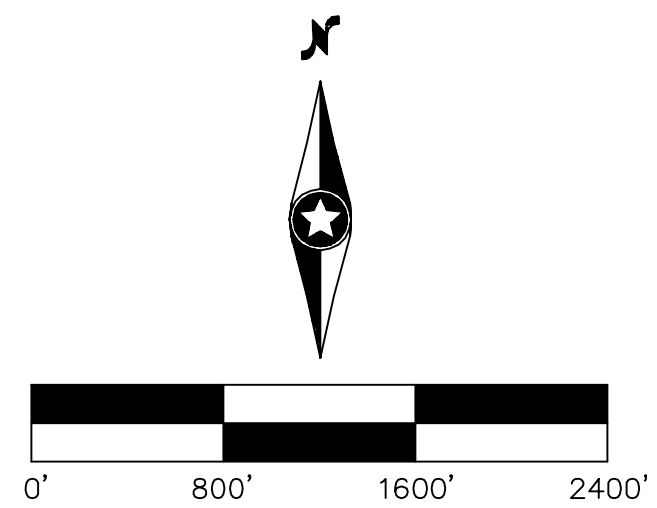

Calico Solar
San Bernardino County,
California

**Overall Debris Basin
Layout**

NOT FOR CONSTRUCTION

Date: 08/04/10
Sheet: 1 OF 1

This page intentionally left blank

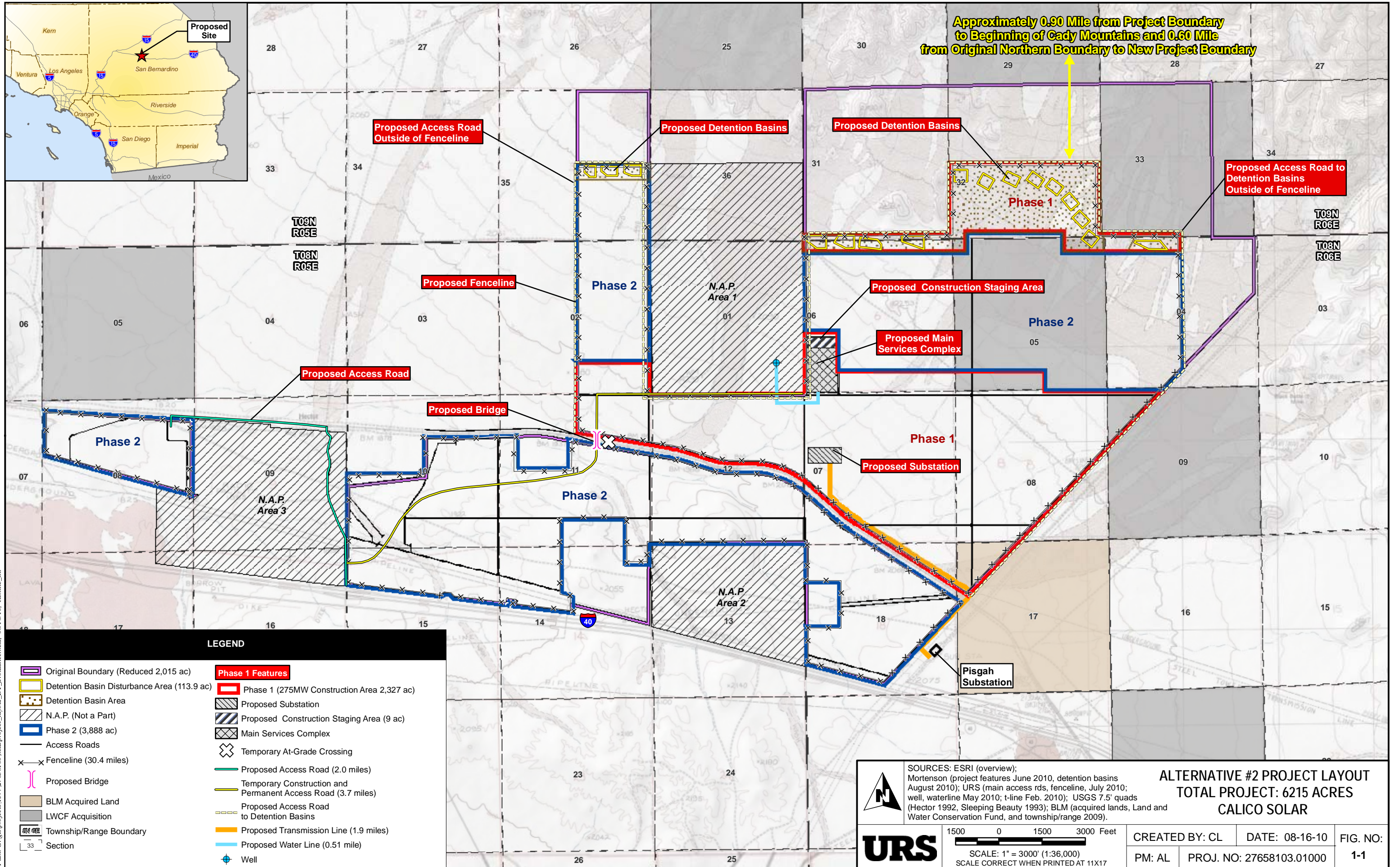

Approximately 0.90 Mile from Project Boundary to Beginning of Cady Mountains and 0.60 Mile from Original Northern Boundary to New Project Boundary

LEGEND

Original Boundary (Reduced 2,015 ac)	Phase 1 Features
Detention Basin Disturbance Area (113.9 ac)	Phase 1 (275MW Construction Area 2,327 ac)
Detention Basin Area	Proposed Substation
N.A.P. (Not a Part)	Proposed Construction Staging Area (9 ac)
Phase 2 (3,888 ac)	Main Services Complex
Access Roads	Temporary At-Grade Crossing
Fenceline (30.4 miles)	Proposed Access Road (2.0 miles)
Proposed Bridge	Temporary Construction and Permanent Access Road (3.7 miles)
BLM Acquired Land	Proposed Access Road to Detention Basins
LWCF Acquisition	Proposed Transmission Line (1.9 miles)
Township/Range Boundary	Proposed Water Line (0.51 mile)
Section	Well

ALTERNATIVE #2 PROJECT LAYOUT
TOTAL PROJECT: 6215 ACRES
CALICO SOLAR

SOURCES: ESRI (overview); Mortenson (project features June 2010, detention basins August 2010); URS (main access rds, fenceline, July 2010; well, waterline May 2010; t-line Feb. 2010); USGS 7.5' quads (Hector 1992, Sleeping Beauty 1993); BLM (acquired lands, Land and Water Conservation Fund, and township/range 2009).

CREATED BY: CL DATE: 08-16-10 FIG. NO: 1-1
 PM: AL PROJ. NO: 27658103.01000

URS

1500 0 1500 3000 Feet
 SCALE: 1" = 3000' (1:36,000)
 SCALE CORRECT WHEN PRINTED AT 11X17

Path: G:\projects\157276581\00\mxd\project_layout_DT_avoidance.mxd_08/16/10_camilie_lill

This page intentionally left blank

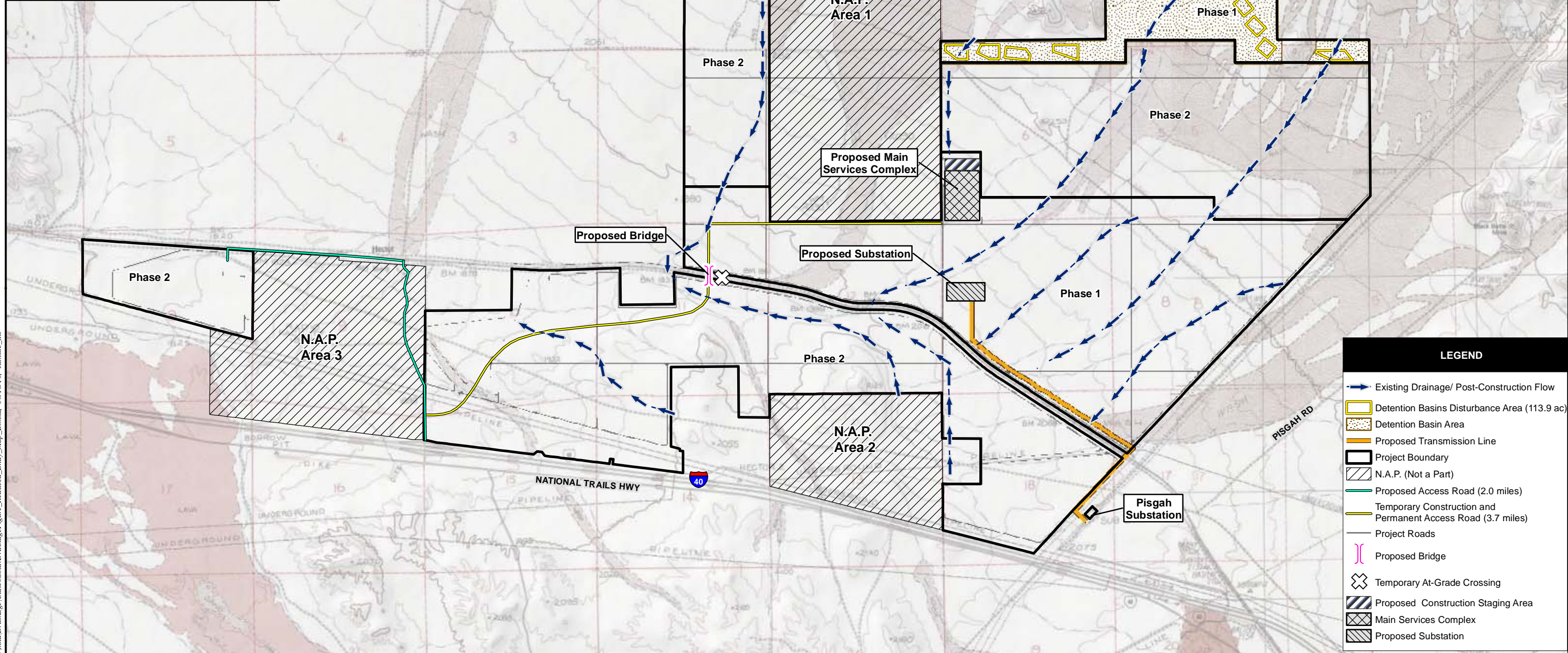

LEGEND	
	Existing Drainage/ Post-Construction Flow
	Detention Basins Disturbance Area (113.9 ac)
	Detention Basin Area
	Proposed Transmission Line
	Project Boundary
	N.A.P. (Not a Part)
	Proposed Access Road (2.0 miles)
	Temporary Construction and Permanent Access Road (3.7 miles)
	Project Roads
	Proposed Bridge
	Temporary At-Grade Crossing
	Proposed Construction Staging Area
	Main Services Complex
	Proposed Substation

SOURCES:
 Mortenson, Inc (project features June 2010, detention basins August 2010); URS (main access rds July 2010, t-line Feb. 2010); Tessera Solar (existing drainage, post-construction flow); USGS 7.5' quads (Hector 1992, Sleeping Beauty 1993).

**DRAINAGE LAYOUT
 CALICO SOLAR PROJECT**

UR S
 SCALE: 1" = 3000' (1:36,000)
 SCALE CORRECT WHEN PRINTED AT 11X17

CREATED BY: JS	DATE: 8-16-10	FIG. NO:
PM: AL	PROJ. NO: 27658103.02000	1B

Path: G:\s\projects\1577276581\00\mxd\Drainage\CalticoSolarDrainageFigure_Reduced_Body_Map_B.mxd, 08/16/10, camille_jill

This page intentionally left blank



**BEFORE THE ENERGY RESOURCES CONSERVATION AND DEVELOPMENT
COMMISSION OF THE STATE OF CALIFORNIA
1516 NINTH STREET, SACRAMENTO, CA 95814
1-800-822-6228 – WWW.ENERGY.CA.GOV**

APPLICATION FOR CERTIFICATION

For the CALICO SOLAR (Formerly SES Solar One)

Docket No. 08-AFC-13

**PROOF OF SERVICE
(Revised 8/9/10)**

APPLICANT

Felicia Bellows
Vice President of Development
& Project Manager
Tessera Solar
4800 North Scottsdale Road,
#5500
Scottsdale, AZ 85251
felicia.bellows@tesseractosolar.com

CONSULTANT

Angela Leiba
AFC Project Manager
URS Corporation
1615 Murray Canyon Rd.,
#1000
San Diego, CA 92108
angela_leiba@URSCorp.com

APPLICANT'S COUNSEL

Allan J. Thompson
Attorney at Law
21 C Orinda Way #314
Orinda, CA 94563
allanori@comcast.net

Ella Foley Gannon, Partner
Bingham McCutchen, LLP
Three Embarcadero Center
San Francisco, CA 94111
ella.gannon@bingham.com

INTERESTED AGENCIES

California ISO
e-recipient@caiso.com

Jim Stobaugh
BLM – Nevada State Office
P.O. Box 12000
Reno, NV 89520
jim_stobaugh@blm.gov

Rich Rotte, Project Manager
Bureau of Land Management
Barstow Field Office
2601 Barstow Road
Barstow, CA 92311
richard_rotte@blm.gov

Becky Jones
California Department of
Fish & Game
36431 41st Street East
Palmdale, CA 93552
dfgpalm@adelphia.net

INTERVENORS

County of San Bernardino
Ruth E. Stringer,
County Counsel
Bart W. Brizzee,
Deputy County Counsel
385 N. Arrowhead Avenue,
4th Floor
San Bernardino, CA 92415-
bbrizzee@cc.sbcounty.gov

California Unions for Reliable
Energy (CURE)
c/o: Loulena A. Miles,
Marc D. Joseph
Adams Broadwell Joseph
& Cardozo
601 Gateway Boulevard, Ste. 1000
South San Francisco, CA 94080
lmiles@adamsbroadwell.com

Defenders of Wildlife
Joshua Basofin
1303 J Street, Suite 270
Sacramento, California 95814
e-mail service preferred
jbasofin@defenders.org

Society for the Conservation of
Bighorn Sheep
Bob Burke & Gary Thomas
P.O. Box 1407
Yermo, CA 92398
cameracoordinator@sheepsociety.com

Basin and Range Watch
Laura Cunningham &
Kevin Emmerich
P.O. Box 70
Beatty, NV 89003
atomicoadranch@netzero.net

INTERVENORS CONT.

Patrick C. Jackson
600 N. Darwood Avenue
San Dimas, CA 91773
e-mail service preferred
ochsjack@earthlink.net

Gloria D. Smith, Senior Attorney
***Travis Ritchie**
Sierra Club
85 Second Street, Second floor
San Francisco, CA 94105
gloria.smith@sierraclub.org
travis.ritchie@sierraclub.org

Newberry Community
Service District
Wayne W. Weierbach
P.O. Box 206
Newberry Springs, CA 92365
newberryCSD@gmail.com

Cynthia Lea Burch
Steven A. Lamb
Anne Alexander
Katten Muchin Rosenman LLP
2029 Century Park East,
Ste. 2700
Los Angeles, CA 90067-3012
Cynthia.burch@kattenlaw.com
Steven.lamb@kattenlaw.com
Anne.alexander@kattenlaw.com

ENERGY COMMISSION

ANTHONY EGGERT
Commissioner and Presiding Member
aeggert@energy.state.ca.us

JEFFREY D. BYRON
Commissioner and Associate Member
jbyron@energy.state.ca.us

Paul Kramer
Hearing Officer
pkramer@energy.state.ca.us

Lorraine White, Adviser to
Commissioner Eggert
e-mail service preferred
lwhite@energy.state.ca.us

Kristy Chew, Adviser to
Commissioner Byron
e-mail service preferred
kchew@energy.state.ca.us

Caryn Holmes
Staff Counsel
cholmes@energy.state.ca.us

Steve Adams
Co-Staff Counsel
sadams@energy.state.ca.us

Christopher Meyer
Project Manager
cmeyer@energy.state.ca.us

Jennifer Jennings
Public Adviser
e-mail service preferred
publicadviser@energy.state.ca.us

DECLARATION OF SERVICE

I, Jennifer Draper, declare that on August 16, 2010, I served and filed copies of the attached Applicant's Updated Detention Basin and Drainage Figures. The original document, filed with the Docket Unit, is accompanied by a copy of the most recent Proof of Service list, located on the web page for this project at: [www.energy.ca.gov/sitingcases/solarone].

The documents have been sent to both the other parties in this proceeding (as shown on the Proof of Service list) and to the Commission's Docket Unit, in the following manner:

(Check all that Apply)

FOR SERVICE TO ALL OTHER PARTIES:

- sent electronically to all email addresses on the Proof of Service list;
- by personal delivery;
- by delivering on this date, for mailing with the United States Postal Service with first-class postage thereon fully prepaid, to the name and address of the person served, for mailing that same day in the ordinary course of business; that the envelope was sealed and placed for collection and mailing on that date to those addresses **NOT** marked "email preferred."

AND

FOR FILING WITH THE ENERGY COMMISSION:

- sending an original paper copy and one electronic copy, mailed and emailed respectively, to the address below (*preferred method*);

OR

- depositing in the mail an original and 12 paper copies, as follows:

CALIFORNIA ENERGY COMMISSION

Attn: Docket No. 08-AFC-13
1516 Ninth Street, MS-4
Sacramento, CA 95814-5512
docket@energy.state.ca.us

I declare under penalty of perjury that the foregoing is true and correct, that I am employed in the county where this mailing occurred, and that I am over the age of 18 years and not a party to the proceeding.

Original signed by
Jennifer Draper

This page intentionally left blank