



DOCKET

08-AFC-13

DATE AUG 12 2010

RECD. AUG 12 2010

August 12, 2010

Mr. Christopher Meyer
CEC Project Manager
Attn: Docket No. 08-AFC-13
California Energy Commission
1516 Ninth Street
Sacramento, CA 95814-5512

RE: Calico Solar (formerly Solar One) Project (08-AFC-13)
Applicant's Phase 1a Information

Dear Mr. Meyer:

Tessera Solar hereby submits the Applicant's Phase 1a information. I certify under penalty of perjury that the foregoing is true, correct and complete to the best of my knowledge.

Sincerely

Tessera Solar

Felicia L. Bellows
Vice President of Development

Calico Solar Phase 1a Description

Consistent with the phased compensatory mitigation proposed by the Applicant, the Calico Solar Project will implement a phased development program. The first occurrence of ground disturbance will consist of a 250 acre area described as Phase 1a (Figure 1-1). In 2010, ground disturbance will be limited to this Phase 1a area as a result of delays in closure of the Department of Energy financing.

Components

Phase 1a will include construction of the main access road, the waterline, the Main Services Area, the substation area, the installation of 60 SunCatcher pedestals, and the temporary at-grade crossing and the permanent bridge spanning the Burlington Northern Santa Fe (BNSF) railroad tracks. Prior to completion of the at-grade railroad crossing, the existing BNSF crossing and right-of-way (ROW) will be used to access Phase 1a. Ground disturbance acreages associated with each Phase 1a feature are provided in Table 1 and Figure 1-1.

**Table 1:
Phase 1a Ground Disturbance Area**

Feature	Ground Disturbance (acres)
Main Access Road	56
Waterline	8
Bridge and At-Grade Crossing	24
Main Service Area	60
60 SunCatcher Pedestal Area	9
Substation Area	93
TOTAL	250

Fencing

Fencing for Phase 1a is shown in Figure 1-2. Construction areas for the main access road, waterline, temporary at-grade crossing and permanent bridge will be fenced with temporary desert tortoise exclusionary fencing. The existing BNSF ROW from the BNSF crossing to the Main Services Area will also be fenced with temporary desert tortoise exclusionary fencing until the new at-grade crossing is complete (Figure 1-2). The Main Service Area, substation area and the 60 SunCatcher pedestals will be fenced with temporary chain-link security fencing and temporary desert tortoise exclusionary fencing.

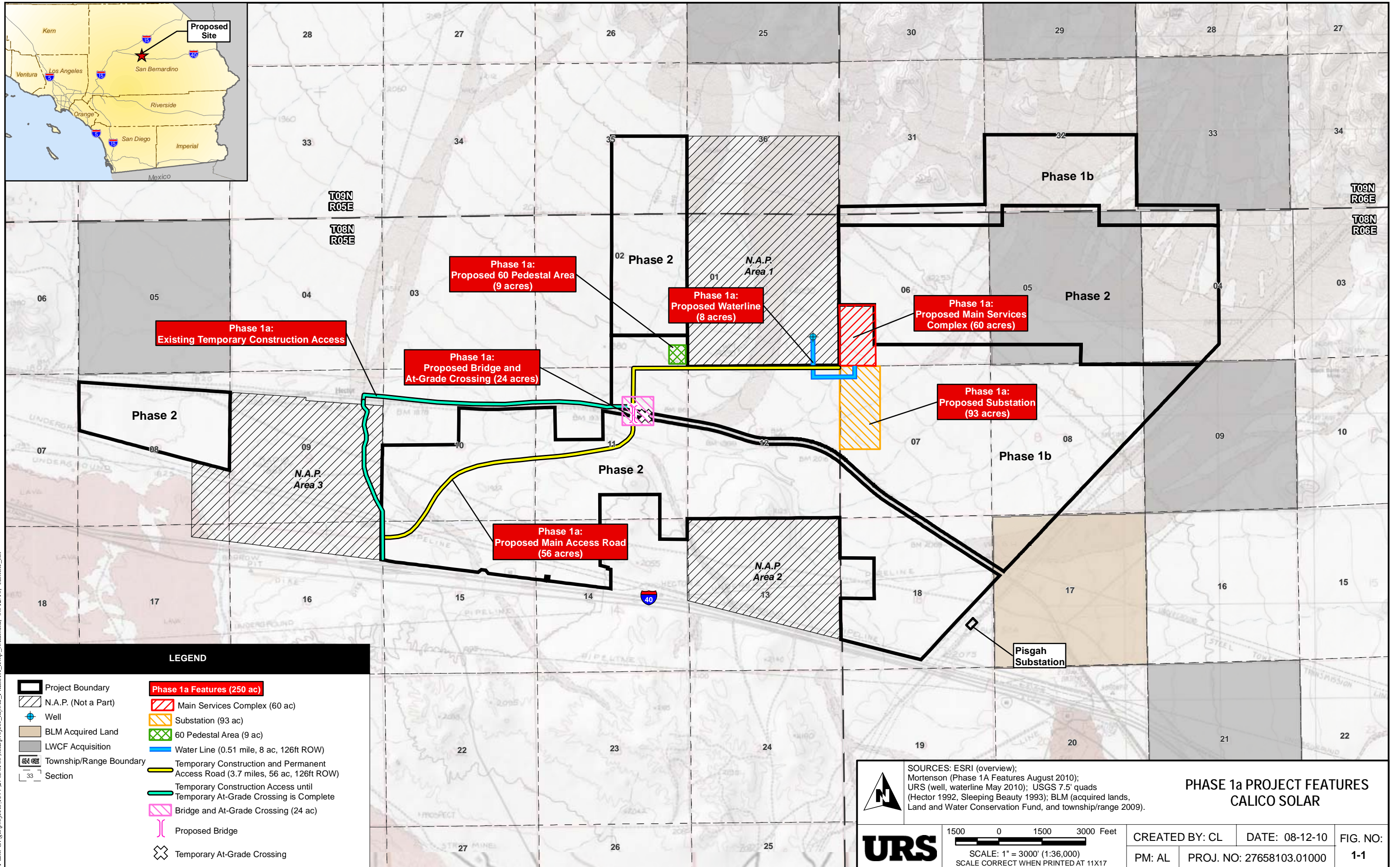

LEGEND

- Project Boundary
- N.A.P. (Not a Part)
- Well
- BLM Acquired Land
- LWCF Acquisition
- Township/Range Boundary
- Section
- Phase 1a Features (250 ac)**
- Main Services Complex (60 ac)
- Substation (93 ac)
- 60 Pedestal Area (9 ac)
- Water Line (0.51 mile, 8 ac, 126ft ROW)
- Temporary Construction and Permanent Access Road (3.7 miles, 56 ac, 126ft ROW)
- Temporary Construction Access until Temporary At-Grade Crossing is Complete
- Bridge and At-Grade Crossing (24 ac)
- Proposed Bridge
- Temporary At-Grade Crossing

PHASE 1a PROJECT FEATURES CALICO SOLAR

SOURCES: ESRI (overview); Mortenson (Phase 1A Features August 2010); URS (well, waterline May 2010); USGS 7.5' quads (Hector 1992, Sleeping Beauty 1993); BLM (acquired lands, Land and Water Conservation Fund, and township/range 2009).

URS

1500 0 1500 3000 Feet
SCALE: 1" = 3000' (1:36,000)
SCALE CORRECT WHEN PRINTED AT 11X17

CREATED BY: CL	DATE: 08-12-10	FIG. NO:
PM: AL	PROJ. NO: 27658103.01000	1-1

Path: G:\gis\projects\1577276581\00\mxd\project_layout_Phase1A_temp_road.mxd, 08/12/10, comille_lill

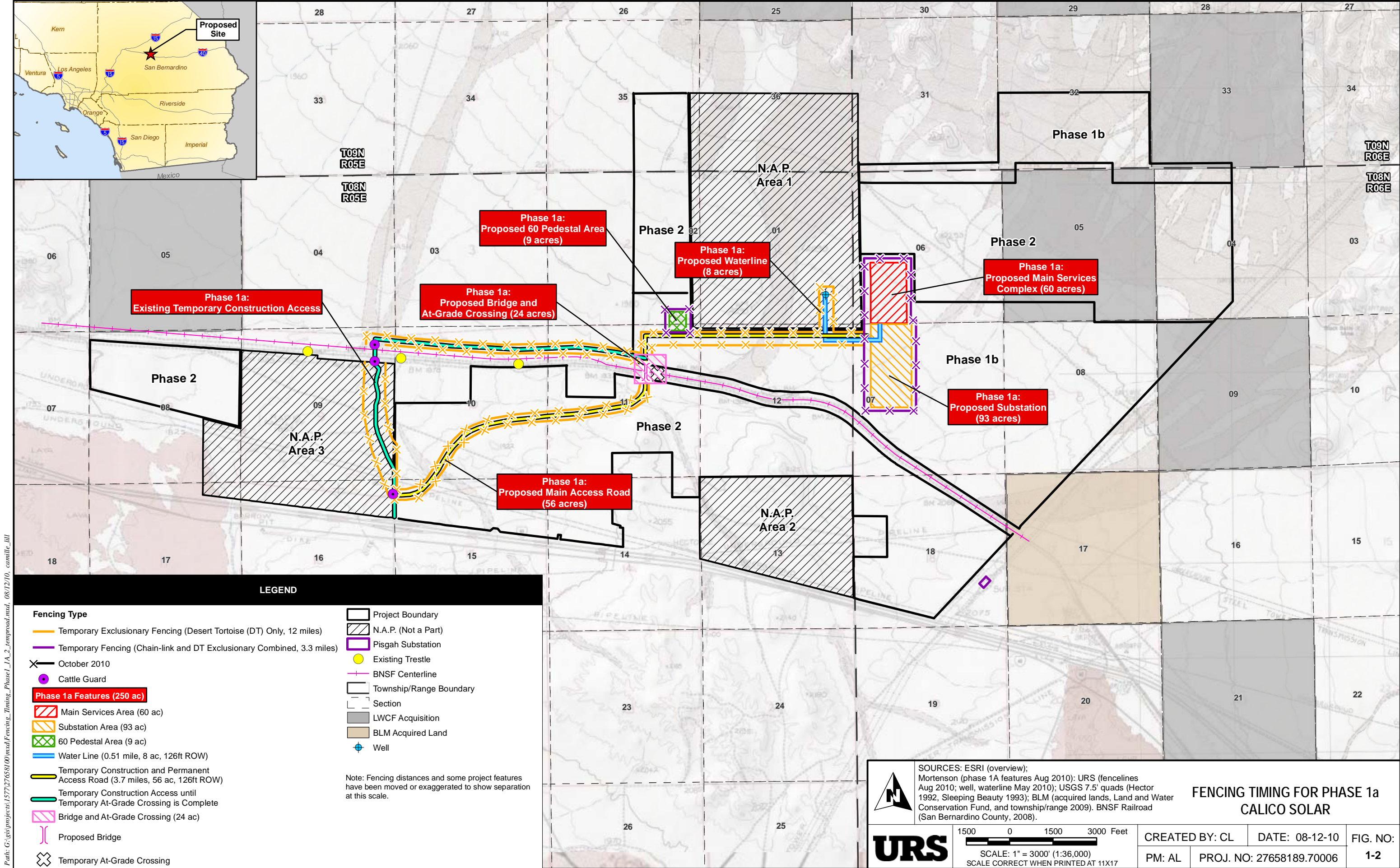

Path: G:\projects\1577276581\00\msd\Fencing_Timing_Phase1_A_2\temp\road.mxd, 08/12/10, camille_bill



**BEFORE THE ENERGY RESOURCES CONSERVATION AND DEVELOPMENT
COMMISSION OF THE STATE OF CALIFORNIA
1516 NINTH STREET, SACRAMENTO, CA 95814
1-800-822-6228 – WWW.ENERGY.CA.GOV**

APPLICATION FOR CERTIFICATION

For the CALICO SOLAR (Formerly SES Solar One)

Docket No. 08-AFC-13

**PROOF OF SERVICE
(Revised 8/9/10)**

APPLICANT

Felicia Bellows
Vice President of Development
& Project Manager
Tessera Solar
4800 North Scottsdale Road,
#5500
Scottsdale, AZ 85251
felicia.bellows@tesseractosolar.com

CONSULTANT

Angela Leiba
AFC Project Manager
URS Corporation
1615 Murray Canyon Rd.,
#1000
San Diego, CA 92108
angela_leiba@URSCorp.com

APPLICANT'S COUNSEL

Allan J. Thompson
Attorney at Law
21 C Orinda Way #314
Orinda, CA 94563
allanori@comcast.net

Ella Foley Gannon, Partner
Bingham McCutchen, LLP
Three Embarcadero Center
San Francisco, CA 94111
ella.gannon@bingham.com

INTERESTED AGENCIES

California ISO
e-recipient@caiso.com

Jim Stobaugh
BLM – Nevada State Office
P.O. Box 12000
Reno, NV 89520
jim_stobaugh@blm.gov

Rich Rotte, Project Manager
Bureau of Land Management
Barstow Field Office
2601 Barstow Road
Barstow, CA 92311
richard_rotte@blm.gov

Becky Jones
California Department of
Fish & Game
36431 41st Street East
Palmdale, CA 93552
dfgpalm@adelphia.net

INTERVENORS

County of San Bernardino
Ruth E. Stringer,
County Counsel
Bart W. Brizzee,
Deputy County Counsel
385 N. Arrowhead Avenue,
4th Floor
San Bernardino, CA 92415-
bbrizzee@cc.sbcounty.gov

California Unions for Reliable
Energy (CURE)
c/o: Loulena A. Miles,
Marc D. Joseph
Adams Broadwell Joseph
& Cardozo
601 Gateway Boulevard, Ste. 1000
South San Francisco, CA 94080
lmiles@adamsbroadwell.com

Defenders of Wildlife
Joshua Basofin
1303 J Street, Suite 270
Sacramento, California 95814
e-mail service preferred
jbasofin@defenders.org

Society for the Conservation of
Bighorn Sheep
Bob Burke & Gary Thomas
P.O. Box 1407
Yermo, CA 92398
cameracoordinator@sheepsociety.com

Basin and Range Watch
Laura Cunningham &
Kevin Emmerich
P.O. Box 70
Beatty, NV 89003
atomicoadranch@netzero.net

INTERVENORS CONT.

Patrick C. Jackson
600 N. Darwood Avenue
San Dimas, CA 91773
e-mail service preferred
ochsjack@earthlink.net

Gloria D. Smith, Senior Attorney
***Travis Ritchie**
Sierra Club
85 Second Street, Second floor
San Francisco, CA 94105
gloria.smith@sierraclub.org
travis.ritchie@sierraclub.org

Newberry Community
Service District
Wayne W. Weierbach
P.O. Box 206
Newberry Springs, CA 92365
newberryCSD@gmail.com

Cynthia Lea Burch
Steven A. Lamb
Anne Alexander
Katten Muchin Rosenman LLP
2029 Century Park East,
Ste. 2700
Los Angeles, CA 90067-3012
Cynthia.burch@kattenlaw.com
Steven.lamb@kattenlaw.com
Anne.alexander@kattenlaw.com

ENERGY COMMISSION

ANTHONY EGGERT
Commissioner and Presiding Member
aeggert@energy.state.ca.us

JEFFREY D. BYRON
Commissioner and Associate Member
jbyron@energy.state.ca.us

Paul Kramer
Hearing Officer
pkramer@energy.state.ca.us

Lorraine White, Adviser to
Commissioner Eggert
e-mail service preferred
lwhite@energy.state.ca.us

Kristy Chew, Adviser to
Commissioner Byron
e-mail service preferred
kchew@energy.state.ca.us

Caryn Holmes
Staff Counsel
cholmes@energy.state.ca.us

Steve Adams
Co-Staff Counsel
sadams@energy.state.ca.us

Christopher Meyer
Project Manager
cmeyer@energy.state.ca.us

Jennifer Jennings
Public Adviser
e-mail service preferred
publicadviser@energy.state.ca.us

DECLARATION OF SERVICE

I, Darin Neufeld, declare that on August 12, 2010, I served and filed copies of the attached Applicant's Proposed Phase 1 A Information. The original document, filed with the Docket Unit, is accompanied by a copy of the most recent Proof of Service list, located on the web page for this project at: [www.energy.ca.gov/sitingcases/solarone].

The documents have been sent to both the other parties in this proceeding (as shown on the Proof of Service list) and to the Commission's Docket Unit, in the following manner:

(Check all that Apply)

FOR SERVICE TO ALL OTHER PARTIES:

- sent electronically to all email addresses on the Proof of Service list;
 by personal delivery;
 by delivering on this date, for mailing with the United States Postal Service with first-class postage thereon fully prepaid, to the name and address of the person served, for mailing that same day in the ordinary course of business; that the envelope was sealed and placed for collection and mailing on that date to those addresses **NOT** marked "email preferred."

AND

FOR FILING WITH THE ENERGY COMMISSION:

- sending an original paper copy and one electronic copy, mailed and emailed respectively, to the address below (*preferred method*);

OR

- depositing in the mail an original and 12 paper copies, as follows:

CALIFORNIA ENERGY COMMISSION

Attn: Docket No. 08-AFC-13
1516 Ninth Street, MS-4
Sacramento, CA 95814-5512
docket@energy.state.ca.us

I declare under penalty of perjury that the foregoing is true and correct, that I am employed in the county where this mailing occurred, and that I am over the age of 18 years and not a party to the proceeding.

Original Signed By
Darin Neufeld