

GRATTAN & GALATI  
COUNSELORS & ADVOCATES

RENAISSANCE TOWER  
301 K STREET  
PENTHOUSE SUITE  
SACRAMENTO, CA 95814

OFFICES ALSO IN  
GLENDALE, CA

January 22, 2002

Ms. Theresa Epps  
Dockets Unit  
California Energy Commission  
1516 9<sup>th</sup> Street  
Sacramento, CA 95814

<b>DOCKET</b> 01-AFC-21
DATE <u>JAN 22 2002</u>
RECD. <u>JAN 22 2002</u>

**RE: The Tesla Power Project (01-AFC-21)**

Dear Ms. Epps:

Enclosed for filing with the California Energy Commission are one original and 12 (Twelve) copies of the **Tables and Graphs referred to in Attachment B of the Tesla Power Project's Responses to the CEC Staff's list of Data Inadequacies**, which was docketed under separate cover on January 4, 2002.

Sincerely,

*Scott Galati*

Scott A. Galati  
on behalf of  
Midway Power LLC

SAG/cw  
Enclosures

## Water Quality Table Q-2

### SOURCE WATER FOR ROSEDALE-RIO BRAVO WSD RECHARGE OPERATIONS

Constituent	Maximum Contaminant Level (MCL applies to treated water only)	California Public Health Goal (PHG applies to treated water only)	SOURCE		
			Friant Kern	Aqueduct	Kern River
<b>Volatile Organic Chemicals</b>					
Benzene	0.001 mg/L	0.00014 mg/L	ND	ND	ND
Carbon Tetrachloride	0.0005 mg/L	0.0001 mg/L	ND	ND	ND
1,2-Dichlorobenzene	0.6 mg/L	0.6 mg/L	ND	ND	ND
1,4-Dichlorobenzene	0.005 mg/L	0.006 mg/L	ND	ND	ND
1,1-Dichloroethane	0.005 mg/L		ND	ND	ND
1,2-Dichloroethane	0.0005 mg/L	0.0004 mg/L	ND	ND	ND
1,1-Dichloroethylene	0.006 mg/L	0.01 mg/L	ND	ND	ND
cis-1,2-Dichloroethylene	0.006 mg/L		ND	ND	ND
trans-1,2-Dichloroethylene	0.01 mg/L		ND	ND	ND
Dichloromethane	0.005 mg/L	0.004 mg/L	ND	ND	ND
1,2-Dichloropropane	0.005 mg/L	0.0005 mg/L	ND	ND	ND
1,3-Dichloropropane	0.0005 mg/L	0.0002 mg/L	ND	ND	ND
Ethylbenzene	0.7 mg/L	0.3 mg/L	ND	ND	ND
Methyl tert-butyl ether	0.013 mg/L	0.013 mg/L	ND	ND	ND
Monochlorobenzene	0.07 mg/L		ND	ND	ND
Styrene	0.1 mg/L		ND	ND	ND
1,1,2,2-Tetrachloroethane	0.001 mg/L		ND	ND	ND
Tetrachloroethylene	0.005 mg/L	0.000056 mg/L	ND	ND	ND
Toluene	0.15 mg/L	0.15 mg/L	ND	ND	ND
Total Trihalomethanes	0.1 mg/L		ND	ND	ND
1,2,4-Trichlorobenzene	0.07 mg/L	0.005 mg/L	ND	ND	ND
1,1,1-Trichloroethane	0.2 mg/L		ND	ND	ND
1,1,2-Trichloroethane	0.005 mg/L		ND	ND	ND
Trichloroethylene	0.005 mg/L	0.0008 mg/L	ND	ND	ND
Trichlorofluoromethane	0.15 mg/L	0.7 mg/L	ND	ND	ND
1,1,2-Trichloro-1,2,2-Trifluoroethane	1.2 mg/L	4 mg/L	ND	ND	ND
Vinyl Chloride	0.0005 mg/L	0.00005 mg/L	ND	ND	ND
Xylenes (total)	1.75 mg/L	1.8 mg/L	ND	ND	ND
<b>Synthetic Organic Chemicals</b>					
Alachlor	0.002 mg/L	0.004 mg/L	ND	ND	ND
Atrazine	0.003 mg/L	0.00015 mg/L	ND	ND	ND
Bentazon	0.018 mg/L	0.2 mg/L	ND	ND	ND
Benzo(a)pyrene	0.0002 mg/L	0.000004 mg/L	ND	ND	ND
Carbofuran	0.018 mg/L	0.0017 mg/L	ND	ND	ND
Chlordane	0.0001 mg/L	0.00003 mg/L	ND	ND	ND
2,4-Dichlorophenoxyacetic acid	0.07 mg/L	0.07 mg/L	ND	ND	ND
Dalapon	0.2 mg/L	0.79 mg/L	ND	ND	ND
1,2-Dibromo-3-chloropropane	0.0002 mg/L	0.0000017 mg/L	ND	ND	ND
Di(2-ethylhexyl)adipate	0.4 mg/L		ND	ND	ND
Di(2-ethylhexyl)phthalate	0.004 mg/L	0.012 mg/L	ND	ND	ND
Dioseb	0.007 mg/L	0.014 mg/L	ND	ND	ND
Diquat	0.02 mg/L	0.015 mg/L	ND	ND	ND
Endothal	0.1 mg/L	0.58 mg/L	ND	ND	ND
Endrin	0.002 mg/L	0.0018 mg/L	ND	ND	ND
Ethylene Dibromide	0.00005 mg/L		ND	ND	ND
Glyphosate	0.7 mg/L	1 mg/L	ND	ND	ND
Heptachlor	0.00001 mg/L	0.000008 mg/L	ND	ND	ND
Heptachlor Epoxide	0.00001 mg/L	0.000006 mg/L	ND	ND	ND
Hexachlorobenzene	0.001 mg/L		ND	ND	ND
Hexachlorocyclopentadiene	0.05 mg/L	0.05 mg/L	ND	ND	ND
Lindane	0.0002 mg/L	0.000032 mg/L	ND	ND	ND
Methoxychlor	0.04 mg/L	0.03 mg/L	ND	ND	ND
Molinate	0.2 mg/L		ND	ND	ND
Oxamyl	0.2 mg/L	0.05 mg/L	ND	ND	ND
Pentachlorophenol	0.001 mg/L	0.0004 mg/L	ND	ND	ND
Picloram	0.5 mg/L	0.5 mg/L	ND	ND	ND
Polychlorinated Biphenyls	0.0005 mg/L		ND	ND	ND
Simazine	0.004 mg/L	0.0004 mg/L	ND	ND	ND
Thiobarnazole	0.07 mg/L	0.07 mg/L	ND	ND	ND

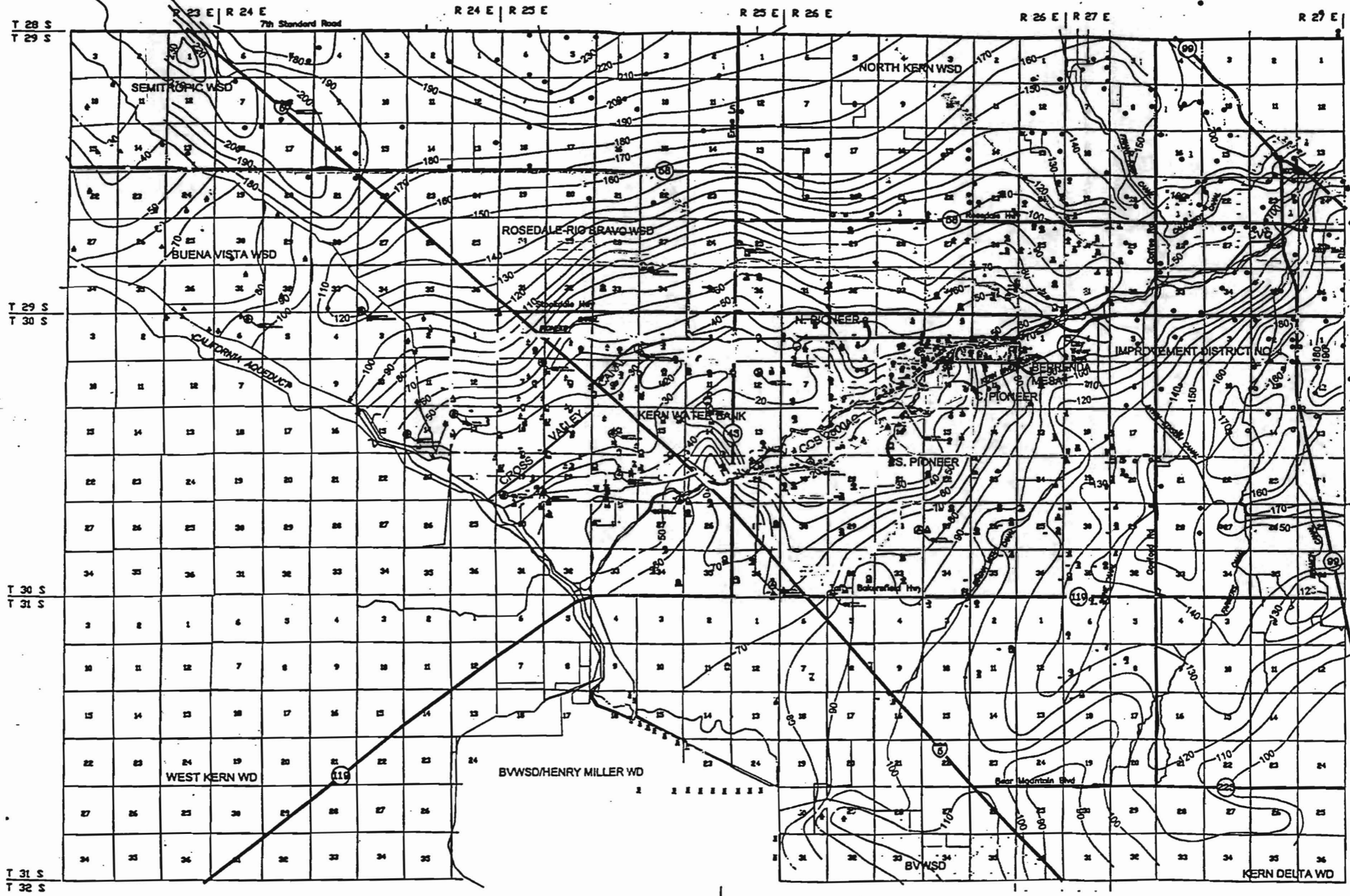

**LEGEND**

- RECHARGE PONDS
- WELL SYMBOLS
  - ▲▲ KERN WATER AUTHORITY WELLS
  - CALIFORNIA WATER SERVICE CO
  - FUNCTIONING WELLS
  - WELLS UNDER WAY

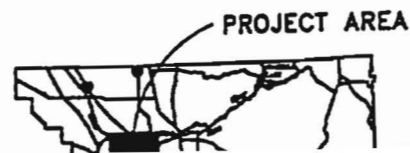

Kern County Water Agency  
Kern County, California

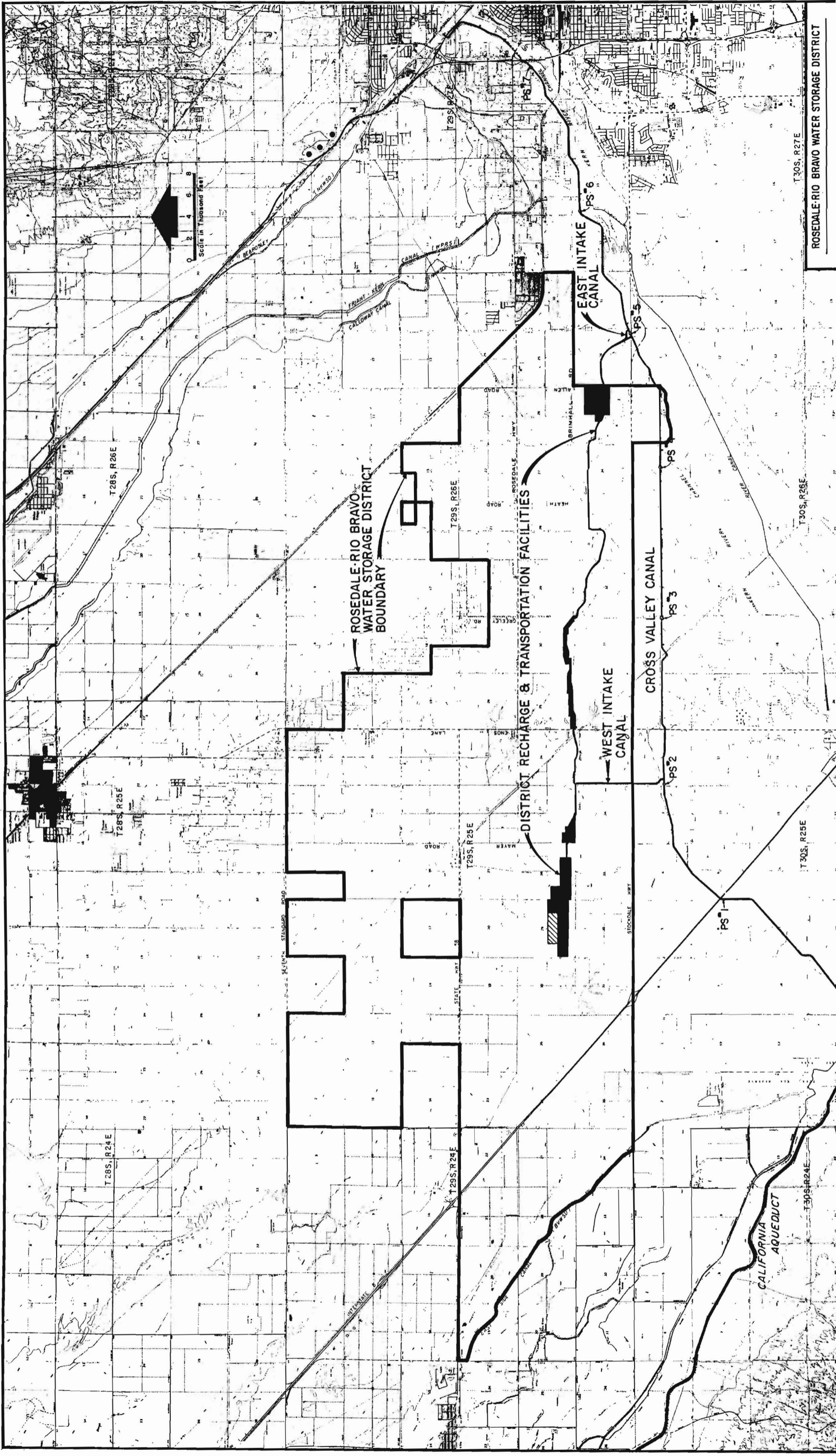

ROSEDALE-RIO BRAVO  
WATER STORAGE DISTRICT  
BOUNDARY

DISTRICT RECHARGE & TRANSPORTATION FACILITIES

WEST INTAKE  
CANAL

CROSS VALLEY CANAL

EAST INTAKE  
CANAL

CALIFORNIA  
AQUEDUCT

ROSEDALE-RIO BRAVO WATER STORAGE DISTRICT



T28S, R26E

T28S, R25E

T28S, R24E

T29S, R26E

T29S, R25E

T29S, R24E

T30S, R26E

T30S, R25E

T30S, R24E

T30S, R27E

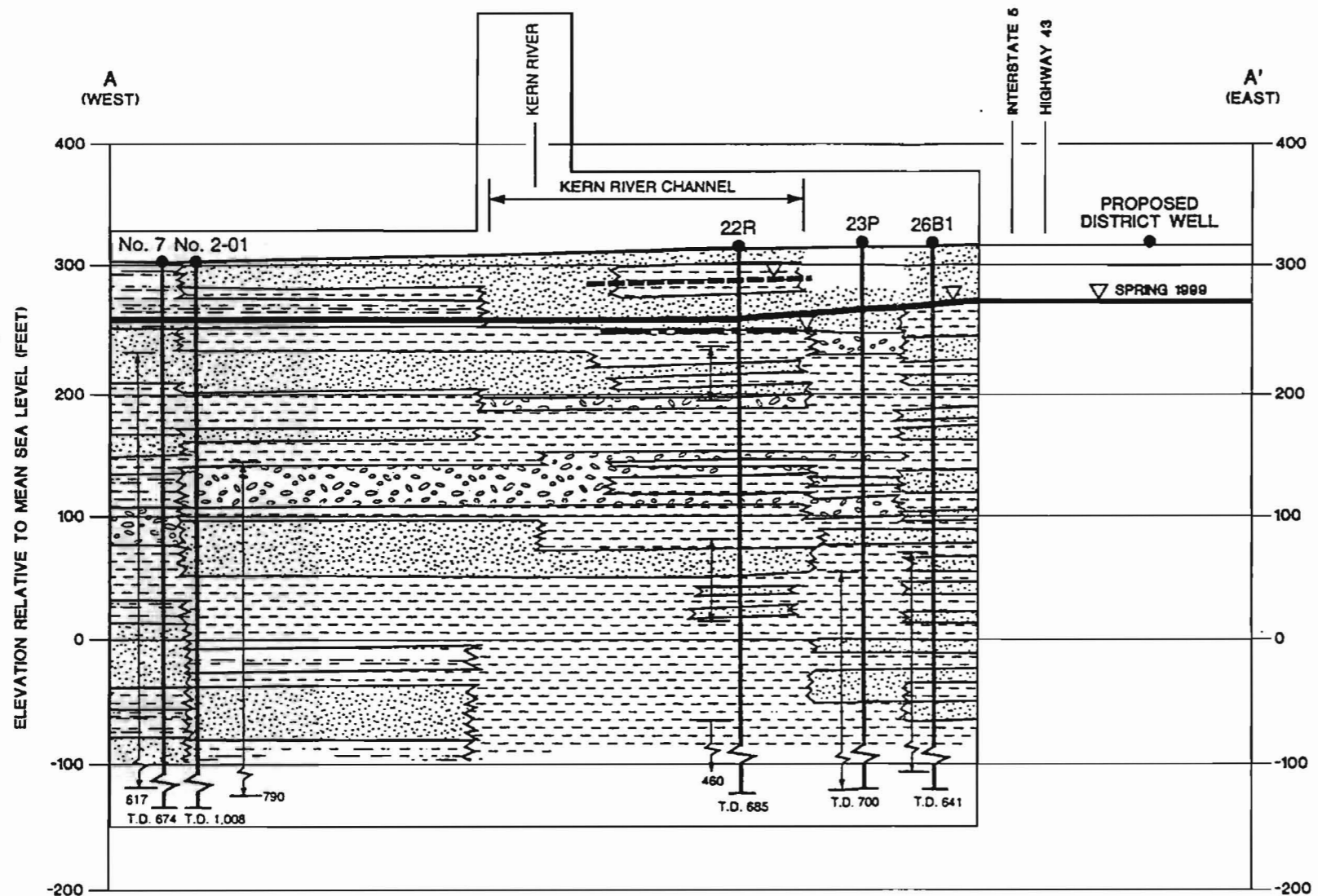



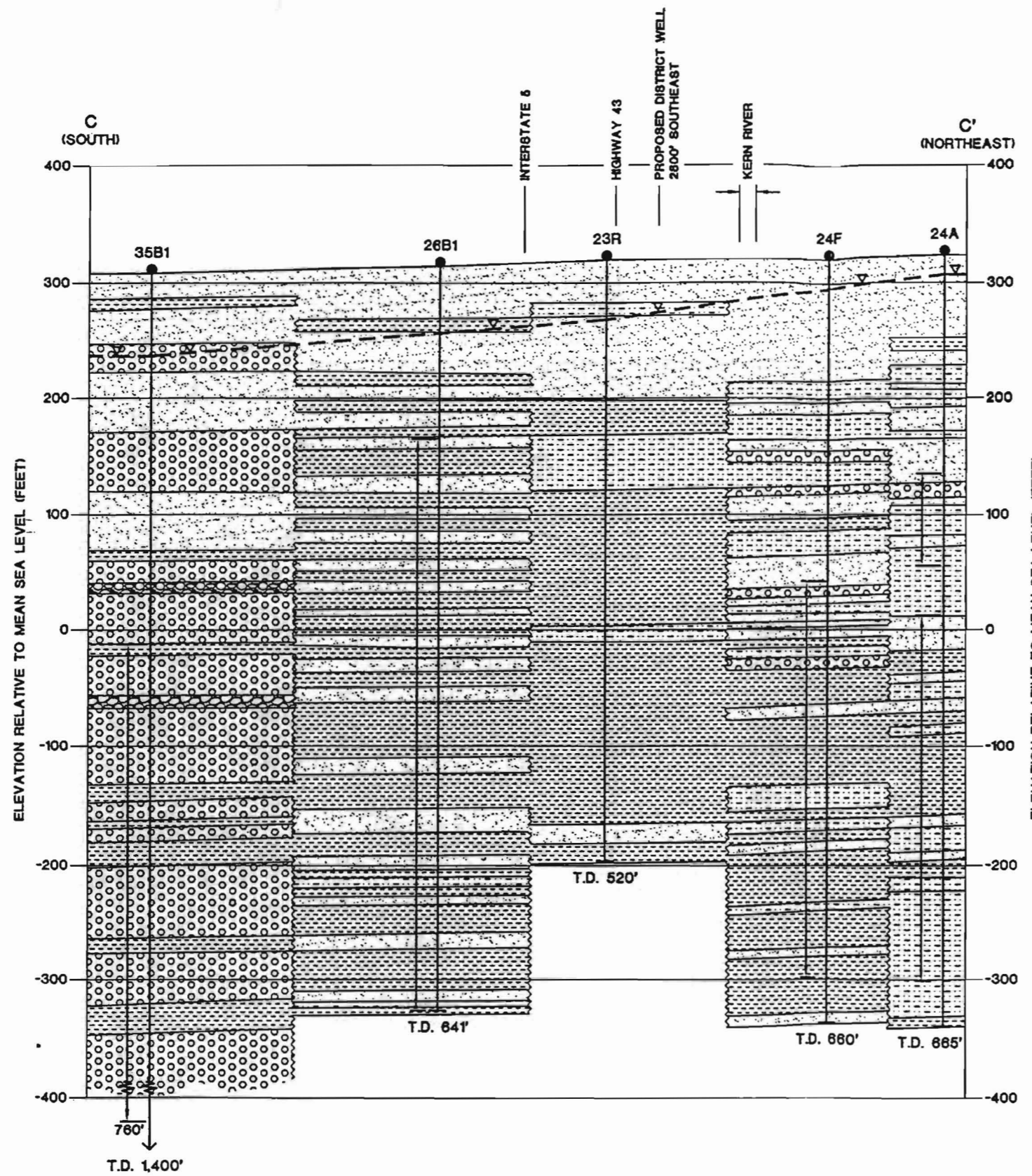

### EXPLANATION

- Sand, Gravel or Cobbles
- Sand, Silty Sand
- Clay, Silty Clay
- Sandy Clay, Clayey Sand and Sand and Clay Mixtures
- 26B1 Well Identification
- Perforated Interval
- T.D. 641 Total Depth (feet)
- Shallow Water Level (Spring 1999)
- Intermediate Water Level (Spring 1999)
- Deep Water Level (Spring 1999)

0 2,000  
Horizontal Scale (feet)



**Explanation**

-  Sand and Gravel or Cobbles
-  Sand, Silty Sand
-  Clay, Silty Clay
-  Sandy Clay, Clayey Sand and Sand and Clay Mixtures
-  Clay and Cobbles

● 24A Well Identification  
 ▭ Perforated Interval  
 T.D. 665' Total Depth (ft)  
 — ▽ — Spring 1998 Water Level

0 1,000 2,000  
 Horiz. Scale in Feet