

DOCKETED

Docket Number:	15-AFC-01
Project Title:	Puente Power Project
TN #:	220229
Document Title:	Testimony of Chris Williamson re Fifth and Del Norte Inland Site
Description:	N/A
Filer:	PATRICIA LARKIN
Organization:	SHUTE, MIHALY & WEINBERGER LLP
Submitter Role:	Intervenor Representative
Submission Date:	7/14/2017 5:30:01 PM
Docketed Date:	7/17/2017

INTERVENOR CITY OF OXNARD

EXHIBIT ____

Testimony of Chris Williamson

Re: Fifth and Del Norte Inland Site

I am a supervisory planner with Rincon Consultants, where I assist the City of Oxnard on matters related to the Puente Power Plant (P3) proposal. On July 7, 2017, I took the photographs of the Fifth and Del Norte Inland Site, attached as Exhibit A to this declaration. I took the photographs from the locations identified on slide one of Exhibit A.

I declare under the penalty of perjury that the foregoing is true and correct.

Executed July 13, 2017 at Oxnard, California.

A handwritten signature in cursive script that reads "Chris Williamson". The signature is written in dark ink and is positioned above the printed name.

Chris Williamson

Photographs Del Norte/Fifth Street Alternative Site

Taken by Chris Williamson
Between 1:15 and 2:15 pm
July 7, 2017

Photo location map

Apn: 216016029
 Situs Add: 3455 E FIFTH ST
 Situs Unit:
 Situs City: OXNARD
 Situs State: CA
 Situs Zip: 93030
 Owner: TODD INDUSTRIAL PARK LLC
 Owner Add1: 5755 VALENTINE RD #203
 Owner Add2:
 Owner City: VENTURA
 Owner State: CA
 Owner Zip: 93003
 Land Value: 361693
 Imp Value: 82604
 Value Year: 2016
 LandUse Code: 2099
 LandUse Desc: OTHER-INDUSTRIAL IMPS
 Zone Code: M1PD
 Zone Desc: LIGHT MAN PLND DEVT

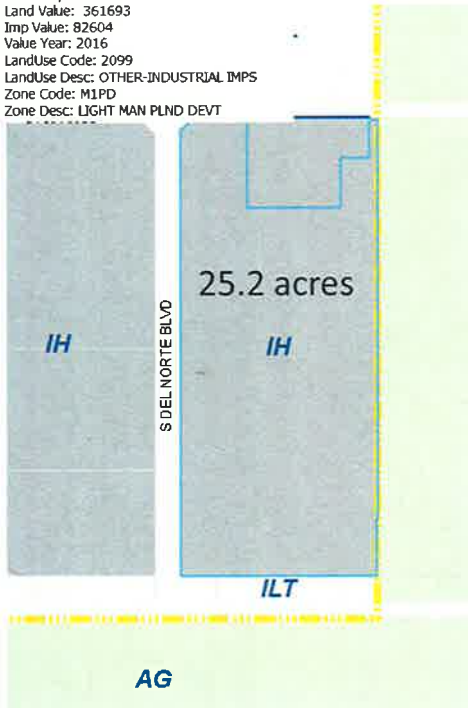

1. View east from asphalt plant entry off of Del Norte

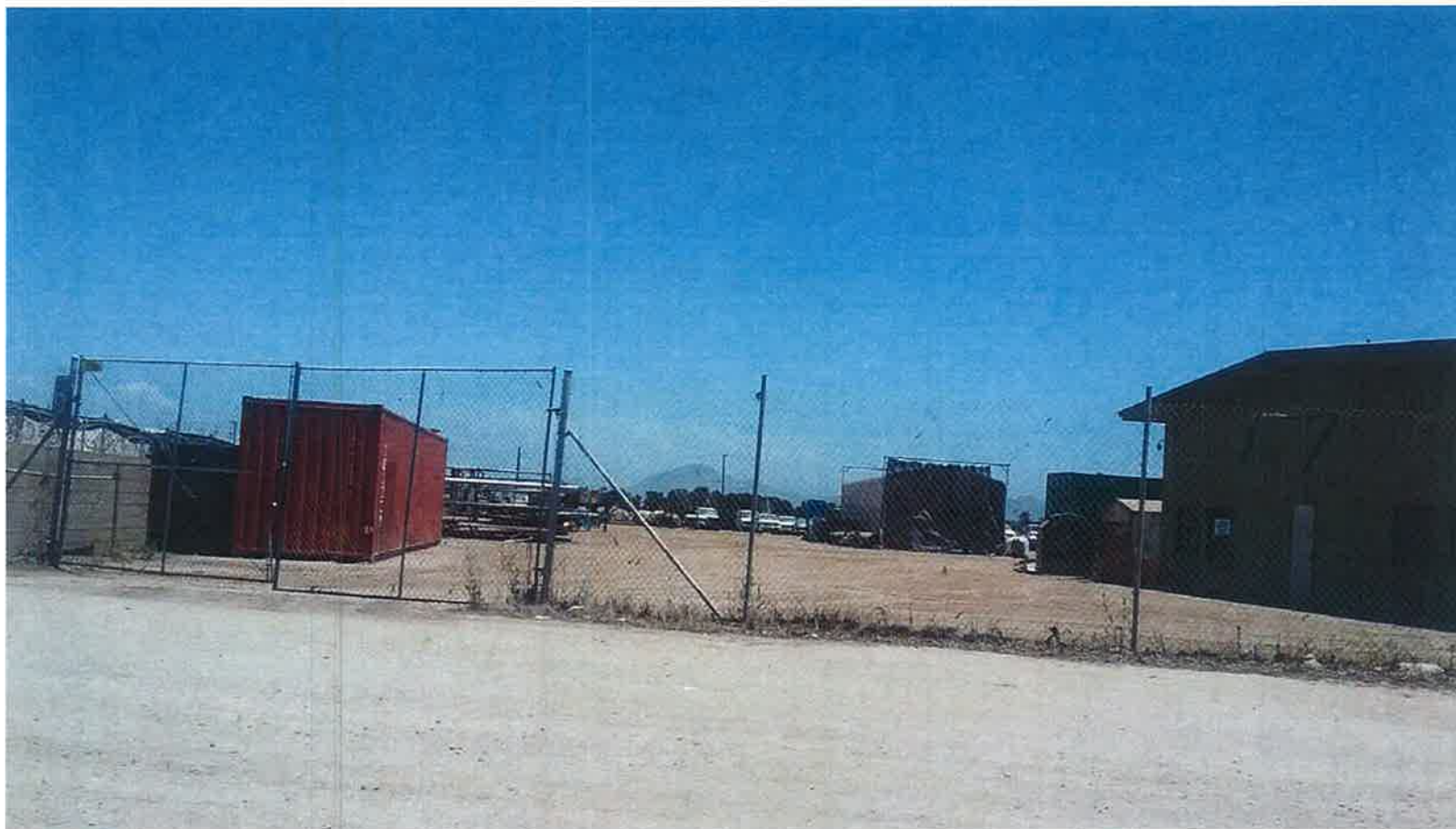

2. View south from Sturgis Road



3. View of north half of property from 85 feet above Oxnard MRF, west side of Del Norte

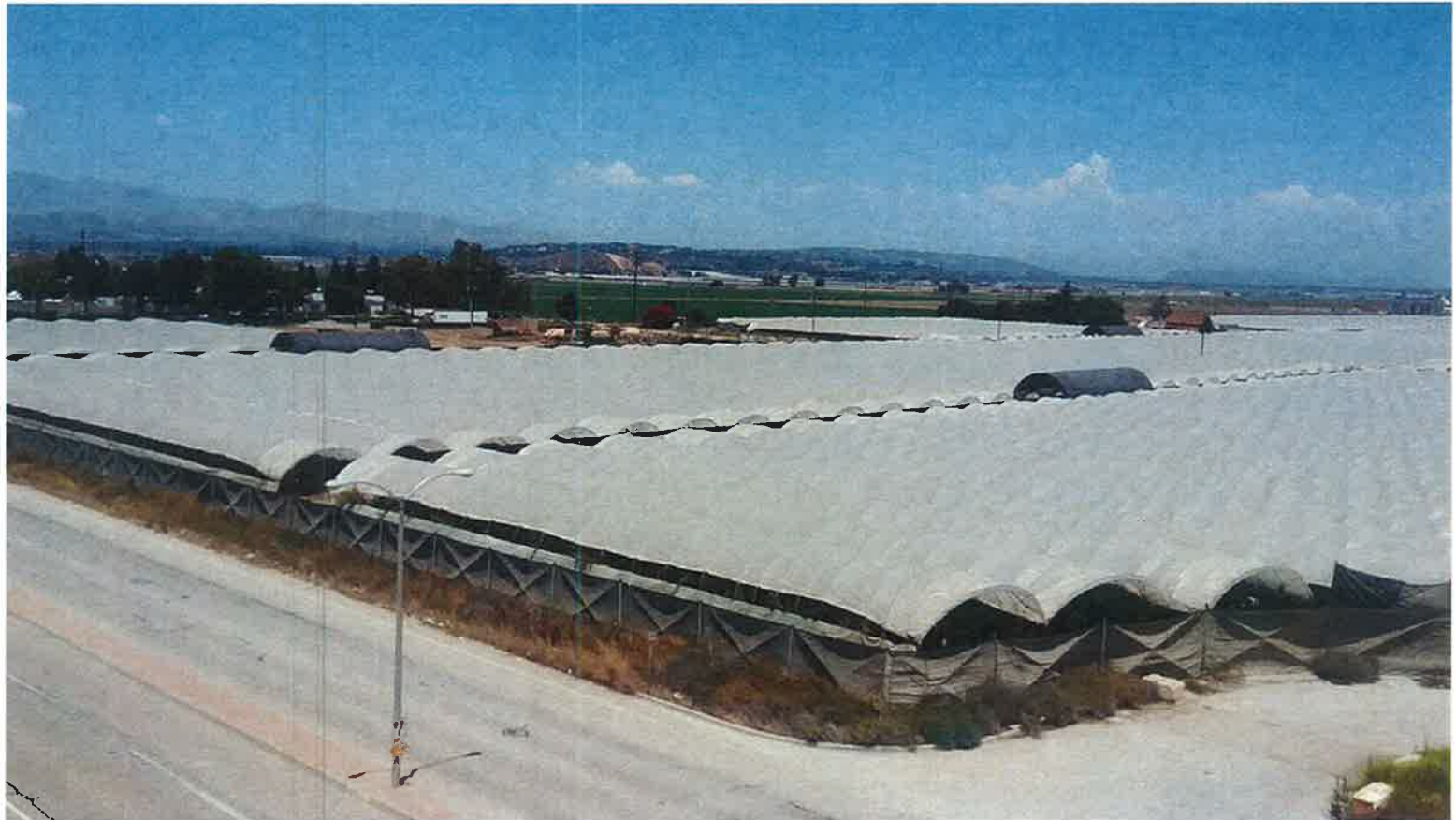

4. View east from 85 ft of property opposite MRF building

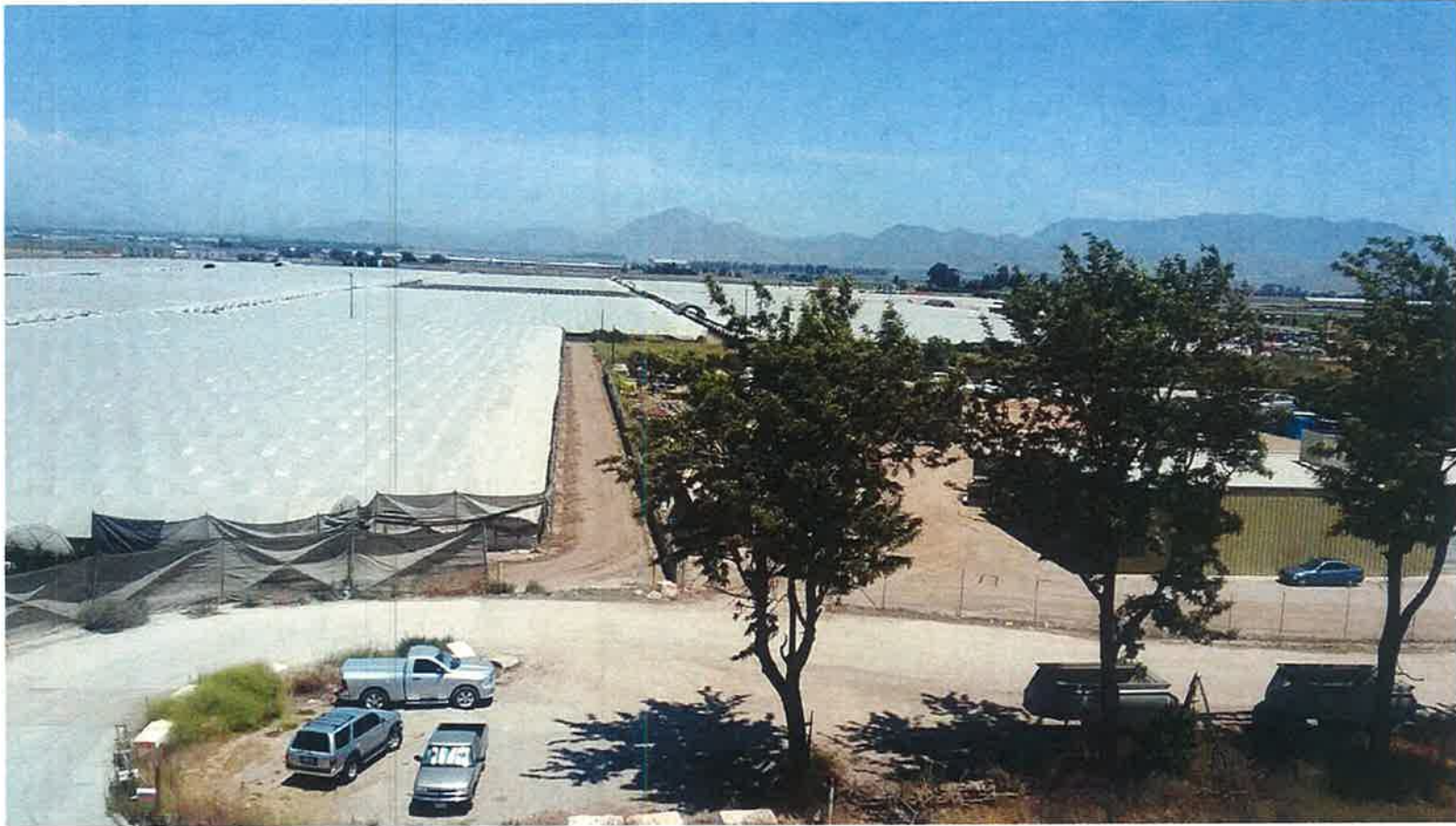

5. View south along Del Norte from 85 ft above MRF, property on left side

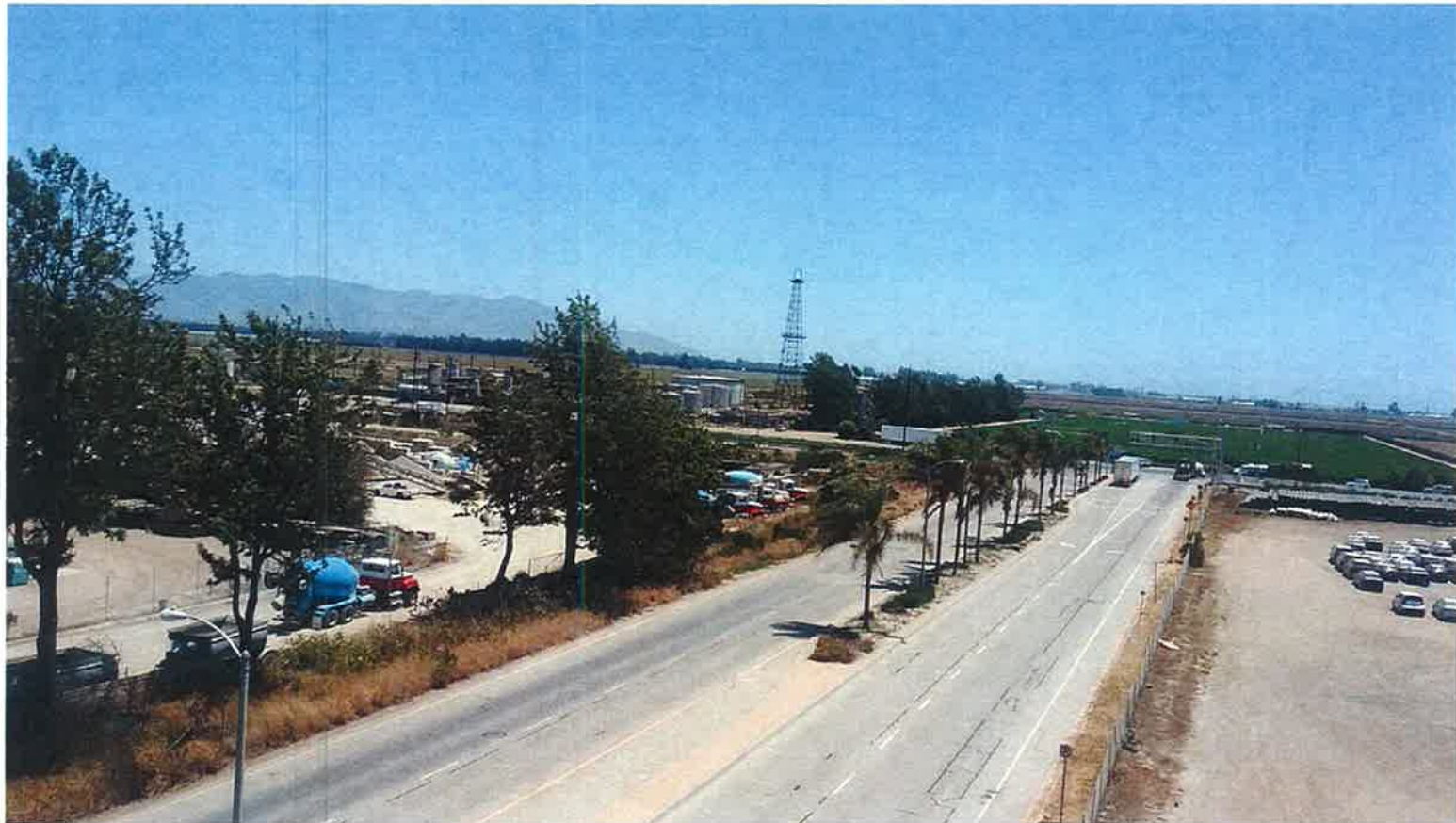

6. View south of City parcel being used for parking new autos, from 85 ft over MRF



7. Pole at Sturgis and NE corner of property transferring 66kV line coming along city limits from north to east-west lines along Sturgis Rd.



8. 66Kv transmission line going north from NEC of property at Sturgis Rd and City limits .



9. Abandoned oil refinery on south side of Fifth Street just across from parcel



10. View of property from Fifth Street looking north



11. View of Fifth Street east of property and City limits

