

DOCKETED	
Docket Number:	26-OPT-02
Project Title:	Seahawk Battery Energy Storage System
TN #:	271021
Document Title:	Patrick Orozco Comments - Cultural Resources at College Lake
Description:	N/A
Filer:	System
Organization:	Patrick Orozco
Submitter Role:	Public
Submission Date:	6/25/2026 4:50:14 PM
Docketed Date:	6/25/2026

Comment Received From: Patrick Orozco
Submitted On: 6/25/2026
Docket Number: 26-OPT-02

Cultural Resources at College Lake

I am registered with the BIA as a member of the Chumash, Ohlone and Acjachemen tribes and am an MLD Cultural Monitor for the Native American Heritage Commission since 1976. I am opposed to the project due to it being hazardous to the people of this area, it would create a disturbance to the spawning grounds of the steelhead trout and other listed species such as the long-toed salamander and California red-legged tree frog. I am especially protective of the presence of native cemeteries in our area, and I would be glad to talk to your agency about those which are close to the proposed BESS site. I am submitting documents here indicating cultural findings at College Lake at Holohan Road (SCR-104). Other sites with cultural resources in the area within a mile from College Lake are SCR-44, SCR-36, SCR-113, SCR-158. I urge you to deny the application for the lithium BESS at 90 Minto Road.

Additional submitted attachment is included below.

ARCHAEOLOGICAL EVALUATION OF CA-SCR-158

Ponto Lake

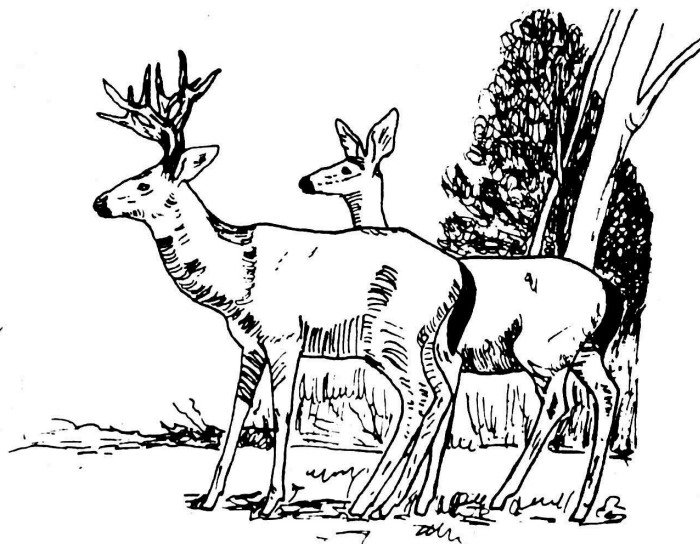

by **Judith Bergthold**
Gary S. Breschini
Trudy Haversat

COYOTE PRESS
P.O. BOX 3377
SALINAS, CA 93912

SCR-104

4092
P-44-000108

4091
57'30"

E-7 =
Temporary S.

104
(WATSONVILLE EAST)
1857' NW GILROY 17 MI.

T. 11 S.
T. 12 S.

WATSONVILLE WEST, CALIF
Basin Research
N3652.5-W12145/7.5
6/29/84

1954
PHOTOREVISED 1980
DMA1657 IV NE-SERIES V895

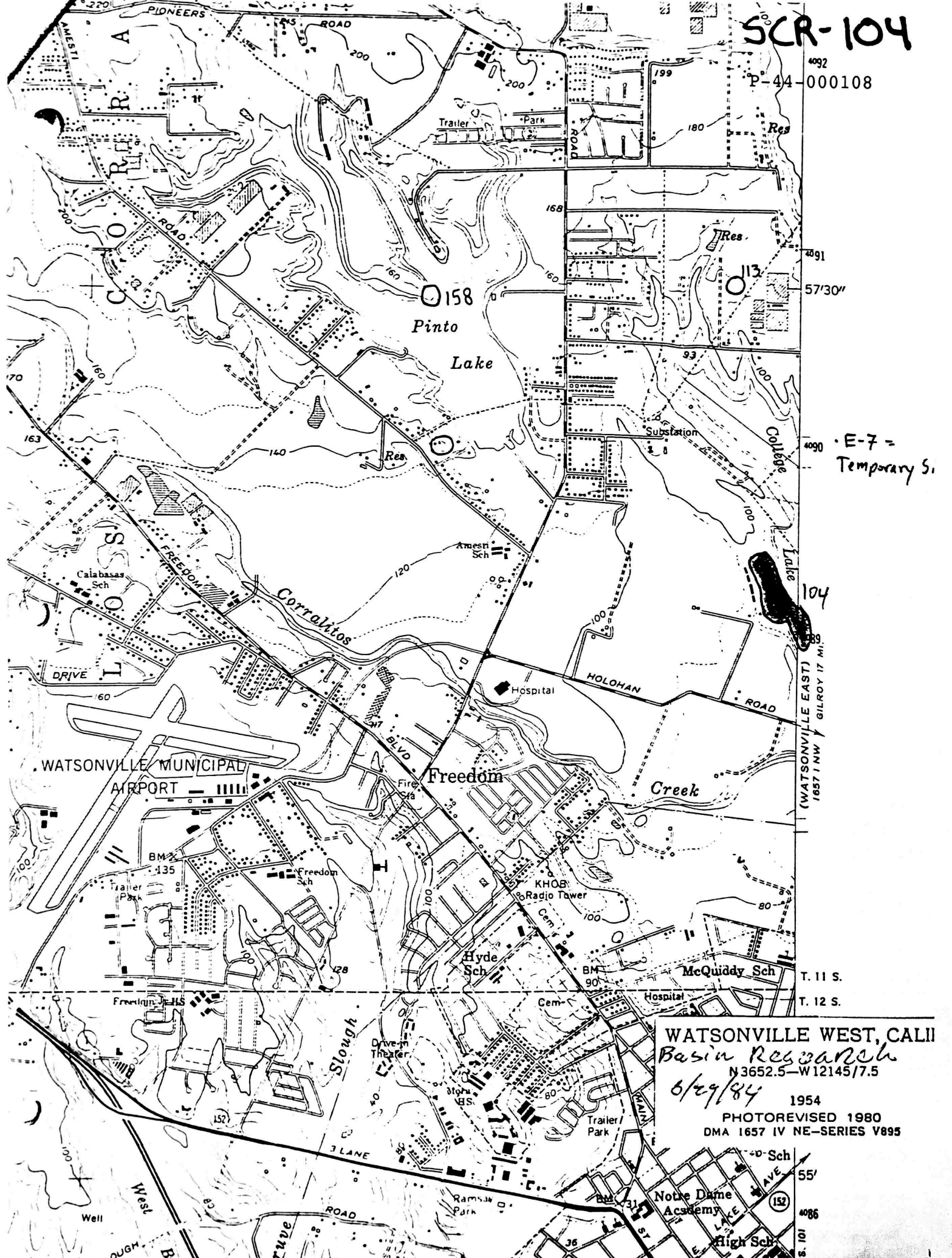

CABRILLO COLLEGE ARCHAEOLOGICAL SITE SURVEY RECORD

1. C.A.S. Site _____ 2. Map Watsonville ^{W. + E.} County Santa Cruz
4. TWN 11-S Range 2-E; _____ $\frac{1}{4}$ of _____ $\frac{1}{4}$ of Sec. _____
5. Location North side of Holohan Rd., rear pasture of 2 houses, plus orchards at W side and front, 1/4 mi west of College Lake
- U.T.M.G. Coordinate 113 891 6. Contour elevation 80-90 ft.
7. Previous designations for site none
8. Owner George Braycovich. Address 118-A Holohan Road, Watsonville
10. Previous owners, dates Burke, 1914; Braycovich since 1920
11. Present tenant same--rear house
12. Attitude toward excavation very good for survey--suggests wintertime
13. Description of site Very large prolific site covering knoll rising above floodplain about 1/2 mi west of SCR-44, mixed w/historic debris near hou
14. Area appr. 200m 15. Depth explored to 4 feet 16. Height --
17. Vegetation dense grasses, orchard 18. Nearest water College Lake, 1/4 mi
19. Soil of site Very drk gr. to lt. brn. 20. Surrounding soil med. brn. to yellow
21. Previous excavation none
22. Cultivation irrigated pasture, apple 23. Erosion --
24. Building, roads, etc. 2 ranch houses, associated bldgs., roads
25. Possibility of destruction probably slight other than ditches
26. House pits --
27. Other features --
28. Burials poss, human bone on surface
29. Artifacts --
30. Remarks Great deal of clam, mussel shell, mammal bone inc. human, chert, fire cracked rock, 1 quartz crystal; mixed with old historic debris near houses. Soil changes in NW portion to fine textured med. brn, little shell.
31. Published references --
32. Photos Edwards, Pajaro River Project 33. Sketch map see back
34. Date 7/14/74 35. Recorded by Farley/Edwards

Farley/Edwards

P-44-000108

① - 4' DEEP ...

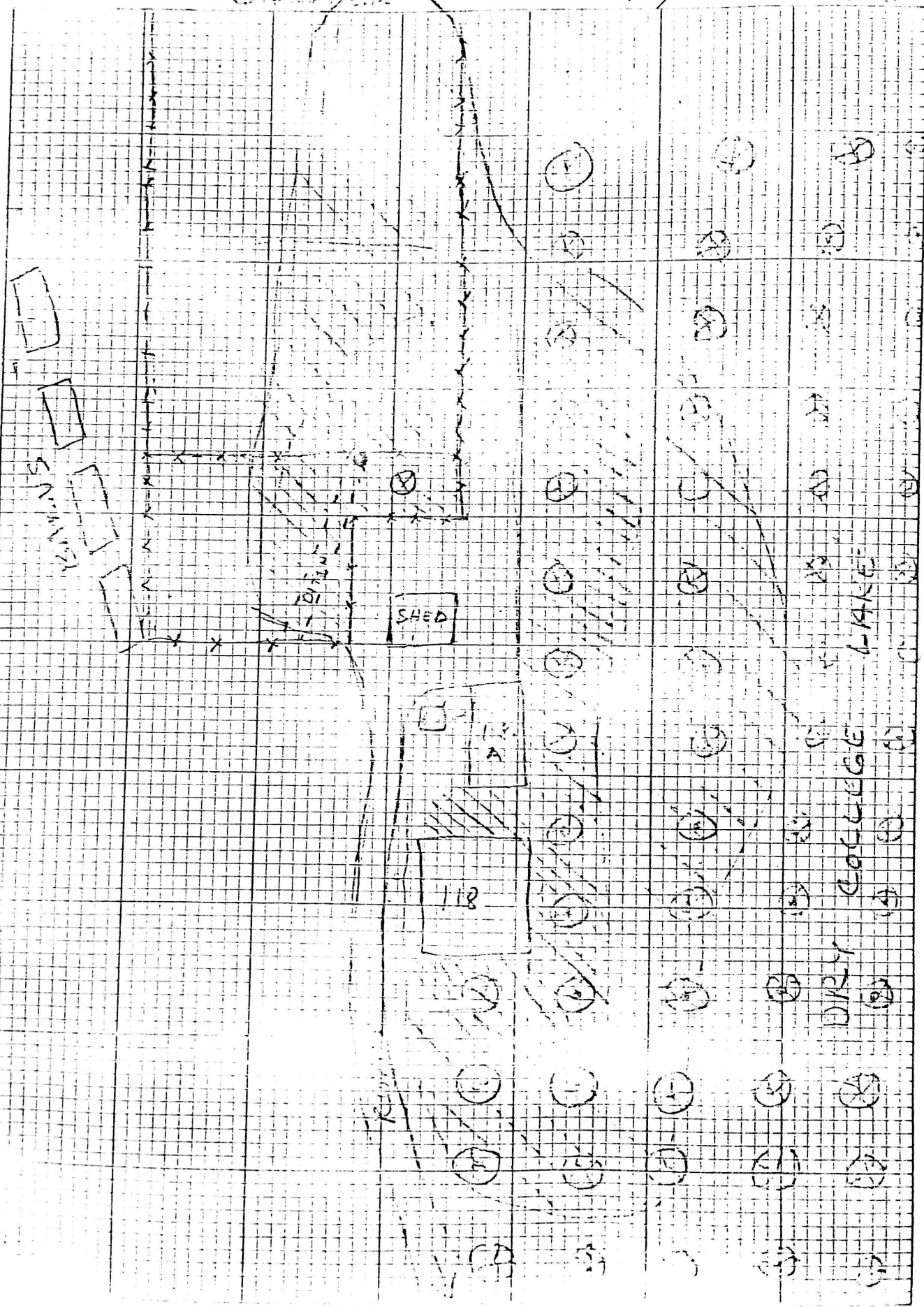

7

RESULTS OF THE RESEARCH

The results of the research fall into several different categories: (1) results of the background research and records check, (2) results of the field excavation, (3) results of the specialized research and analyses, (4) an estimation of the significance of the archaeological resource in terms of its research potential (36 CFR 800.10) or other criteria used for determining significance, and (5) recommendations and mitigation alternatives. The above categories are discussed in more detail below.

Background Research and Records Search.--The background research and records check located 21 previous survey reports, 3 previous EIR's that were pertinent to this parcel, and two reports on the general Pajaro Valley area. These are listed in the bibliography or cited below.

Heicksen in his survey of Pinto Lake County Park interviewed older residents of the area and found that "Almost without exception, there was recollection of quantities of artifacts having been found in the fields at earlier periods, consisting of 'mortars, pestles, arrowheads, etc.,' as after all this land has been continuously farmed since about 1851, and it is therefore not surprising that most surface evidence of Indian occupation has disappeared" (Heicksen 1974:3). He does not state, however, the location of these artifacts, nor does he supply the names of those interviewed, thus making it difficult to ascertain if these artifacts might have been found on or near SCR-158. Heicksen found "...no lithic flakes, shell midden deposits, or other evidence on the surface of aboriginal occupation" (Heicksen 1974:4).

Archaeological Consulting and Research Services discovered SCR-158 during their 1977 survey. Their report describes the site as containing chert debitage, utilized flakes, retouched flake tools, fire-cracked rock, and freshwater shellfish species (Jackson 1977:6). They have described the site as a "small occupation and/or procurement site (Jackson 1977:6).

Archaeological Resource Service reports from their 1975 survey a possible site in the general area of SCR-158 (Roop 1975:2). The report illustrates four Monterey chert flakes, and describes two species of marine bivalve shell which are considered to be prehistoric. The report of that survey did note, however, that "On-the-ground observations were exceedingly difficult to make over most of the survey area" (Roop 1975:1). This leaves questions as to whether or not there were additional cultural resources which were not located because of the dense ground cover, and if so, what their characteristics were.

The two known archaeological sites in the area are SCR-113 and SCR-104. SCR-113 has yielded Franciscan chert and obsidian waste flakes and one shell fragment, but appears to lack a dense midden. The other site, SCR-104, is known to have produced clam, abalone, and mussel shell, mammal (including human) bone, fire-cracked rock, one quartz crystal, a possible pestle fragment, a mano, a core, utilized flakes, waste flakes, and flake tools. It has been described in the records as a "Very large prolific site covering (the) knoll rising above (the) floodplain about 1/2 mile west of SCR-44" (Archaeological Site Survey Record, filed at the Regional Office of the California Archaeological Site Survey, at Cabrillo College). Its elevation is 80-90 feet.

Edwards and Farley noted that prior to their 1974 research in the Pajaro Valley few prehistoric sites had been recorded for the Santa Cruz portion of the valley and that "All were on high ground above a slough, river, or lake" (Edwards and Farley 1974:7). SCR-113, SCR-104, and the possible site all fall into this category, as does SCR-158.

Palou (Bolton 1926 in King 1974:76) mentioned a village either at College or Pinto Lake. King feels the Calendarruc (the Indians living in the Watsonville/Pinto Lake area) "...evidently had one major village, probably the village near the Pajaro (river) south of Watsonville and a number of other villages, one of which was

ARCHAEOLOGICAL FIELD SPECIMEN INVENTORY RECORD

SITE: CA-5CR-104

COLLECTOR: Farley / Edwards

Sheet No. 10613

Collected: 11/14/74

DATE: 11/14/74

Cat. 12/20/75

Field Spec. Number	Description	Location	Depth	Association	L. O. Remarks	Mus. No.
04-1	1 pc vented stone/black	surface			4.5 X 3 X 2 cm	
1-2	1 pc. shell	"			4 X 3 cm mm	
" 3	1 pc untinged chert/Monterey	"			4.2 X 5.5 X 2.2 "	
4	chert flake fragment	"			4.5 X 2.8 X 2 "	
5	possible pebble fragment / reddish	"			5 X 4.2 X 2.5 "	
6	white chert core	"			6.5 X 5.5 X 4 "	
7	overrun, log of foot ^{to a} figure	"			6.3 X 2.5 X 2.0 "	
8	presumably chert fragment / greenish	"			5.5 X 4 X 4 "	
9	orange / plane scarred	"			8.5 X 4.5 X 3.5 "	
10	flake, soap / greenish	"			5.3 X 4 X 1 "	
11	1 pc quartzite	"			4.4 X 4.1 X .5 "	
12	chert flake	"			2.5 X 2.4 X 1 "	
13	1 pc striated alum	"			2.6 X 2.4 X .5 "	
14	1 pc quartzite	"			2.8 X 1.7 X "	
15	Monterey chert fragment	"			2 X 1.5 X .5 "	
16	1 pc glass / pinkish tone	"			2.2 X 2.2 X .7 "	
17	1 pc shell	"			1.9 X 1.7 X .5 mm	
18	glass bottle neck & top	"			2.7 X 2.4 X .4 "	
19	1 pc charred wood	"				

ARCHAEOLOGICAL FIELD SPECIMEN INVENTORY RECORD

P-44-000108

SITE CA-50R-104

COLLECTOR

Fowler/Edwardo

Sheet No. 2 of 23

DATE 7/14/74

Checked

Oct 12/20/70

Field Spec. Number	Description	Location	Depth	Association	L. W. TH Remarks	Mus. No.
20-20	1 pc abalone	Surface			2.5 x 1.5 x .7 cm	
20-21	1 pc prismo clam	Surface			8.2 x 5.5 x 1.2 "	
22	1 pc ceramic / brown glaze	"			3.6 x 3 x 1.5 "	
-23	1 pc chert	"			3.1 x 1.5 x 1.2 "	
24	1 pc green ^{green} medula / beetle bottom	"			3 x 2.2 x 2 "	
25	1 pc chert green & brown banded	"			4.5 x 4.3 x 1.7 "	
26	chained wood	"			2 x 1.5 x .5 "	
27	1 pc shell	"			2.6 x 1.9 ^{cm}	
28	utilized chert	"			1.9 x 2.1 x . "	
29	lithic flake - white	"			5.4 x 3.2 x 1 "	
30	lithic flake - grey	"			4.6 x 3.5 x 1 "	
31	1 pc bone / charred	"			8.1 x 1.7 x 1 "	
32	1 pc possible pash / reddish	"			4.4 x 3 x 2.6 "	
33	1 chert flake brown polished	"			3 x 2.2 x 1.1 "	
34	1 glass fragment	"			2.4 x 1 x .5 "	
35	1 pc chert	"			1.8 x 1.5 x 1 "	
36	1 pc prismo clam	"			2.7 x 3 x 1 "	
37	1 pc shell	"			2.3 x 7 x 1 "	
38	1 pc chert brown mottled	"				

