

DOCKETED

Docket Number:	26-OPT-01
Project Title:	Vaca Dixon Power Center Project
TN #:	270276
Document Title:	Appendix DR VIS-2 Lighting Plan
Description:	Appendix to Data Request Response Set #1
Filer:	Adam Morrison
Organization:	Rincon Consultants, Inc.
Submitter Role:	Applicant Consultant
Submission Date:	5/27/2026 9:13:16 AM
Docketed Date:	5/27/2026

Appendix DR VIS-2

Lighting Plan

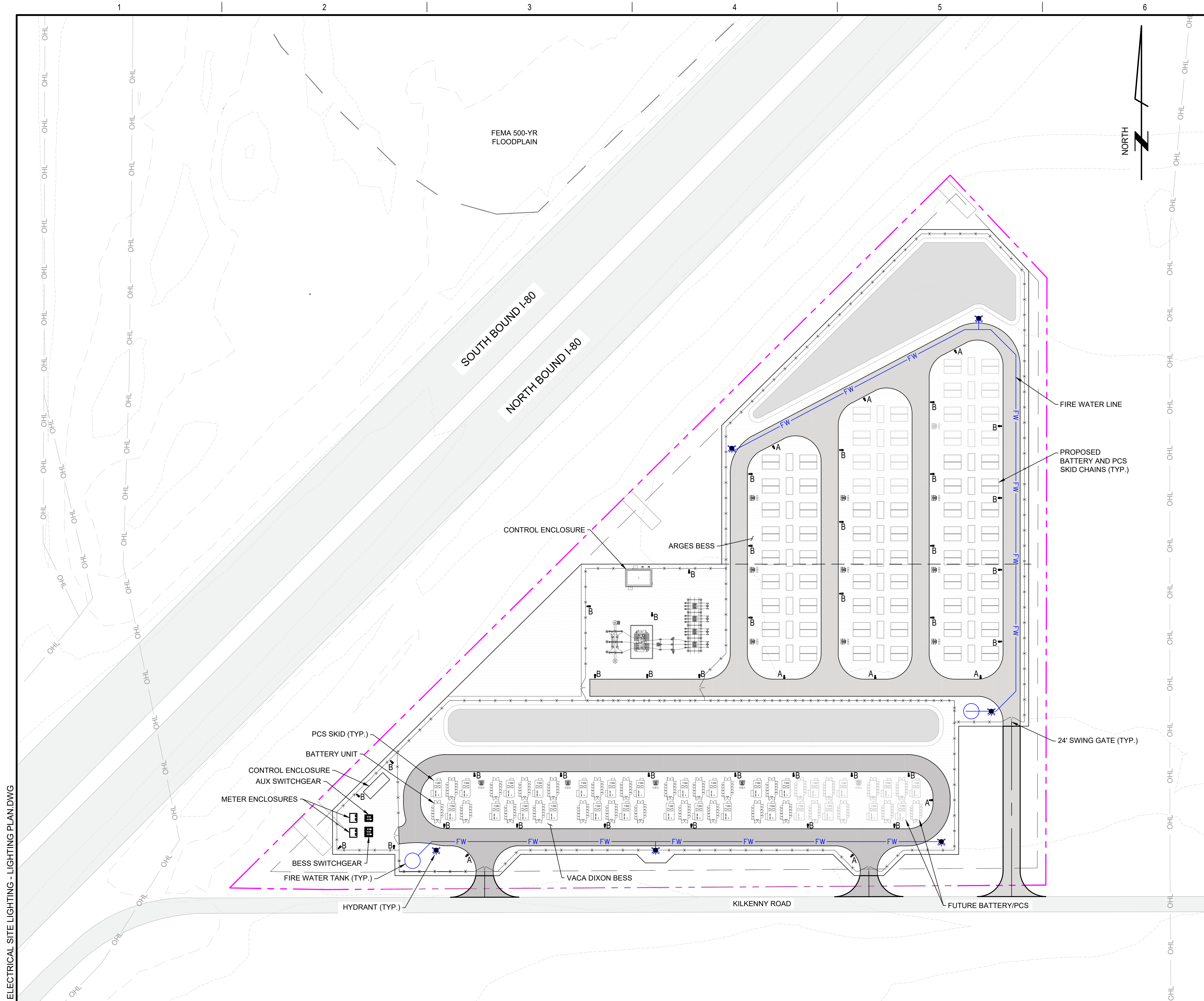

NOTES

1. LIGHTING WILL COMPLY WITH DARK SKY REQUIREMENTS. THIS INCLUDES UTILIZING SHIELDING SO NO LIGHT IS EMITTED ABOVE THE HORIZONTAL PLANE. LIGHTS SHOULD BE 3000K OR WARMER. USE TIMERS AND PHOTOCELLS SO LIGHTS ARE ONLY ON WHEN NEEDED.
2. EXTERIOR LIGHTING DESIGN FOR THE PROJECT WILL INCORPORATE MEASURES TO CONTROL OFF-SITE REFLECTANCE FROM EXTERIOR SURFACES IN ACCORDANCE WITH APPLICABLE CITY AND COUNTY MUNICIPAL CODES GOVERNING GLARE AND LIGHT TRESPASS. ALL EXTERIOR EQUIPMENT ENCLOSURES, BATTERY CABINETS, INVERTER HOUSINGS, FENCING, AND ANCILLARY STRUCTURES WILL UTILIZE NON-REFLECTIVE OR LOW-GLOSS FINISHES TO MINIMIZE REFLECTION OF BOTH NATURAL AND ARTIFICIAL LIGHT BEYOND THE PROJECT BOUNDARY. SURFACE COATINGS WILL GENERALLY BE MATTE OR SEMI-MATTE INDUSTRIAL FINISHES WITH LOW REFLECTIVITY VALUES, AND HIGHLY POLISHED OR METALLIC SURFACES WILL BE AVOIDED. LIGHTING FIXTURES WILL BE FULL CUT-OFF, DOWNWARD-DIRECTED LUMINAIRES DESIGNED TO LIMIT UPWARD LIGHT AND OFF-SITE GLARE, AND WILL BE POSITIONED TO ILLUMINATE ONLY REQUIRED OPERATIONAL AREAS.
3. THE PROJECT INTENDS TO UTILIZE EXTERIOR LIGHTING FIXTURES THAT CARRY THE DARKSKY (INTERNATIONAL DARK-SKY ASSOCIATION) FIXTURE SEAL OF APPROVAL WHERE SUCH FIXTURES ARE REASONABLY AVAILABLE AND COMPATIBLE WITH THE OPERATIONAL AND DURABILITY REQUIREMENTS OF THE FACILITY. HOWEVER, THE AVAILABILITY OF FIXTURES BEARING THE FORMAL DARKSKY SEAL CAN VARY DEPENDING ON MANUFACTURER OFFERINGS, SUPPLY CHAIN CONDITIONS, AND SPECIFIC INDUSTRIAL PERFORMANCE REQUIREMENTS. IN THE EVENT THAT FIXTURES WITH THE DARKSKY APPROVAL MARK CANNOT BE REASONABLY PROCURED, THE PROJECT WILL INSTEAD SPECIFY LIGHTING FIXTURES THAT ARE DESIGNED AND MANUFACTURED TO MEET THE FUNCTIONAL DARKSKY LIGHTING PRINCIPLES, INCLUDING FULL CUT-OFF DISTRIBUTION, SHIELDING TO PREVENT UPWARD LIGHT EMISSION, MINIMIZED GLARE, AND APPROPRIATE COLOR TEMPERATURE TO LIMIT SKYGLOW AND OFF-SITE LIGHT TRESPASS. IN THIS MANNER, THE LIGHTING DESIGN WILL MAINTAIN CONFORMANCE WITH DARKSKY PERFORMANCE REQUIREMENTS AND APPLICABLE MUNICIPAL LIGHTING STANDARDS EVEN IF THE SELECTED FIXTURES DO NOT CARRY THE FORMAL DARKSKY CERTIFICATION LABEL.

LEGEND

- A LITHONIA LIGHTING DSX0-LED-P1-30K-70CRI-T1S-HS
- B LITHONIA LIGHTING DSX1-LED-P1-30K-70CRI-T1S-HS

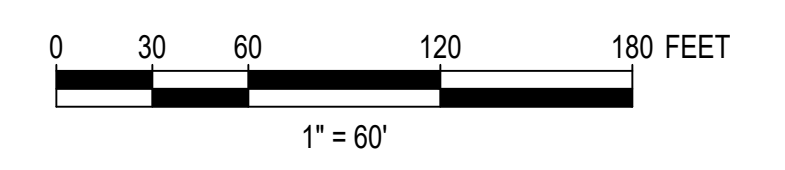

E18-00-01 BESS ELECTRICAL SITE LIGHTING - LIGHTING PLAN.DWG

THIS DRAWING WAS PREPARED BY POWER ENGINEERS, INC. FOR A SPECIFIC PROJECT, TAKING INTO CONSIDERATION THE SPECIFIC AND UNIQUE REQUIREMENTS OF THE PROJECT. REUSE OF THIS DRAWING OR ANY INFORMATION CONTAINED IN THIS DRAWING FOR ANY PURPOSE IS PROHIBITED UNLESS WRITTEN PERMISSION FROM BOTH POWER AND POWER'S CLIENT IS GRANTED.

PRELIMINARY

NOT FOR CONSTRUCTION

REV	REVISIONS	DATE	DRN	DSGN	CKD	APPD	REFERENCE DRAWINGS
B	FOR PERMIT REVIEW	07/01/2025	SLM	CSM	TWH	TWH	
A	FOR PERMIT REVIEW	04/04/2025	SLM	CSM	TWH	TWH	

DSGN	CSM	APR 2025
DRN	SLM	APR 2025
CKD	TWH	APR 2025
SCALE:	1" = 60'-0"	
FOR 22x34 DWG ONLY		

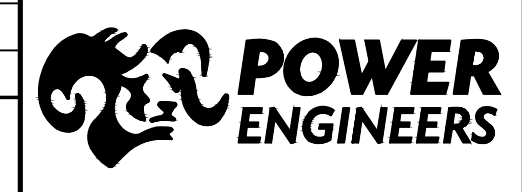

MIDDLE RIVER POWER	JOB NUMBER	REV
VACA ARGES POWER CENTER	0256726	
BESS ELECTRICAL SITE LIGHTING LIGHTING PLAN	DRAWING NUMBER	E18-00-01

NOTES

1. LIGHTING WILL COMPLY WITH DARK SKY REQUIREMENTS. THIS INCLUDES UTILIZING SHIELDING SO NO LIGHT IS EMITTED ABOVE THE HORIZONTAL PLANE. LIGHTS SHOULD BE 3000K OR WARMER. USE TIMERS AND PHOTOCELLS SO LIGHTS ARE ONLY ON WHEN NEEDED.
2. EXTERIOR LIGHTING DESIGN FOR THE PROJECT WILL INCORPORATE MEASURES TO CONTROL OFF-SITE REFLECTANCE FROM EXTERIOR SURFACES IN ACCORDANCE WITH APPLICABLE CITY AND COUNTY MUNICIPAL CODES GOVERNING GLARE AND LIGHT TRESPASS. ALL EXTERIOR EQUIPMENT ENCLOSURES, BATTERY CABINETS, INVERTER HOUSINGS, FENCING, AND ANCILLARY STRUCTURES WILL UTILIZE NON-REFLECTIVE OR LOW-GLOSS FINISHES TO MINIMIZE REFLECTION OF BOTH NATURAL AND ARTIFICIAL LIGHT BEYOND THE PROJECT BOUNDARY. SURFACE COATINGS WILL GENERALLY BE MATTE OR SEMI-MATTE INDUSTRIAL FINISHES WITH LOW REFLECTIVITY VALUES, AND HIGHLY POLISHED OR METALLIC SURFACES WILL BE AVOIDED. LIGHTING FIXTURES WILL BE FULL CUT-OFF, DOWNWARD-DIRECTED LUMINAIRES DESIGNED TO LIMIT UPWARD LIGHT AND OFF-SITE GLARE, AND WILL BE POSITIONED TO ILLUMINATE ONLY REQUIRED OPERATIONAL AREAS.
3. THE PROJECT INTENDS TO UTILIZE EXTERIOR LIGHTING FIXTURES THAT CARRY THE DARKSKY (INTERNATIONAL DARK-SKY ASSOCIATION) FIXTURE SEAL OF APPROVAL WHERE SUCH FIXTURES ARE REASONABLY AVAILABLE AND COMPATIBLE WITH THE OPERATIONAL AND DURABILITY REQUIREMENTS OF THE FACILITY. HOWEVER, THE AVAILABILITY OF FIXTURES BEARING THE FORMAL DARKSKY SEAL CAN VARY DEPENDING ON MANUFACTURER OFFERINGS, SUPPLY CHAIN CONDITIONS, AND SPECIFIC INDUSTRIAL PERFORMANCE REQUIREMENTS. IN THE EVENT THAT FIXTURES WITH THE DARKSKY APPROVAL MARK CANNOT BE REASONABLY PROCURED, THE PROJECT WILL INSTEAD SPECIFY LIGHTING FIXTURES THAT ARE DESIGNED AND MANUFACTURED TO MEET THE FUNCTIONAL DARKSKY LIGHTING PRINCIPLES, INCLUDING FULL CUT-OFF DISTRIBUTION, SHIELDING TO PREVENT UPWARD LIGHT EMISSION, MINIMIZED GLARE, AND APPROPRIATE COLOR TEMPERATURE TO LIMIT SKYGLOW AND OFF-SITE LIGHT TRESPASS. IN THIS MANNER, THE LIGHTING DESIGN WILL MAINTAIN CONFORMANCE WITH DARKSKY PERFORMANCE REQUIREMENTS AND APPLICABLE MUNICIPAL LIGHTING STANDARDS EVEN IF THE SELECTED FIXTURES DO NOT CARRY THE FORMAL DARKSKY CERTIFICATION LABEL.

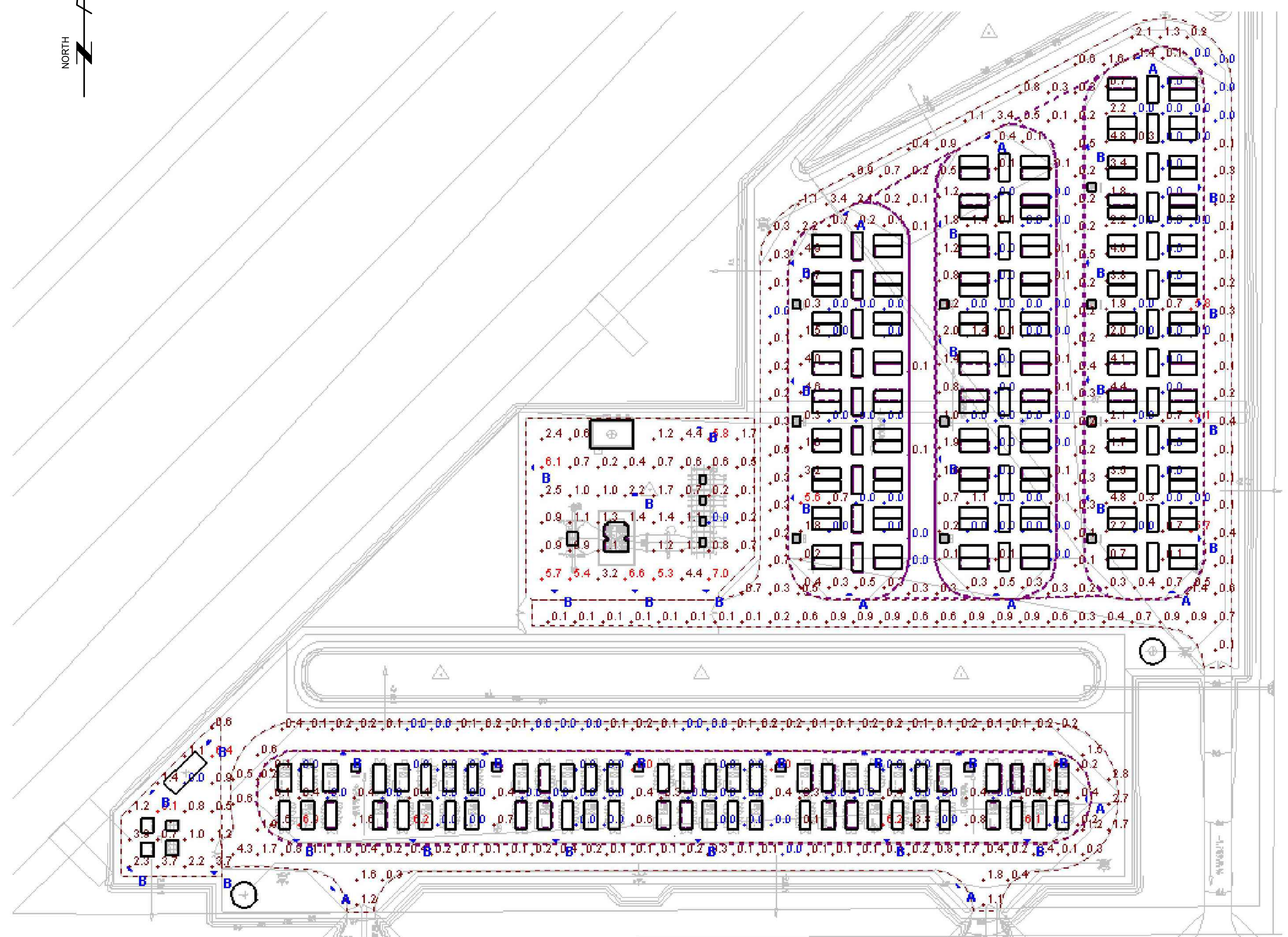
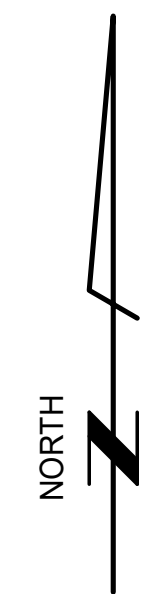

STATISTICS			
DESCRIPTION	AVERAGE	MAXIMUM	MINIMUM
NORTH ROADWAY	0.5 fc	3.4 fc	0.0 fc
SOUTH BESS AREA	0.9 fc	6.9 fc	0.0 fc
SOUTH ROADWAY	0.5 fc	4.3 fc	0.0 fc
SUBSTATION AREA	2.0 fc	7.0 fc	0.0 fc
SWITCHGEAR AREA	2.0 fc	6.4 fc	0.0 fc
NORTH BATTERY / PCS AREA	0.9 fc	6.1 fc	0.0 fc

E18-00-02 BESS ELECTRICAL SITE LIGHTING - LIGHTING STATISTICS.DWG

THIS DRAWING WAS PREPARED BY POWER ENGINEERS, INC. FOR A SPECIFIC PROJECT, TAKING INTO CONSIDERATION THE SPECIFIC AND UNIQUE REQUIREMENTS OF THE PROJECT. REUSE OF THIS DRAWING OR ANY INFORMATION CONTAINED IN THIS DRAWING FOR ANY PURPOSE IS PROHIBITED UNLESS WRITTEN PERMISSION FROM BOTH POWER AND POWER'S CLIENT IS GRANTED.

PRELIMINARY

NOT FOR CONSTRUCTION

REV	REVISIONS	DATE	DRN	DSGN	CKD	APPD	REFERENCE DRAWINGS
B	FOR PERMIT REVIEW	07/01/2025	SLM	CSM	TWH	TWH	
A	FOR PERMIT REVIEW	04/04/2025	SLM	CSM	TWH	TWH	

DSGN	CSM	APR 2025
DRN	SLM	APR 2025
CKD	TWH	APR 2025
SCALE:	NONE	

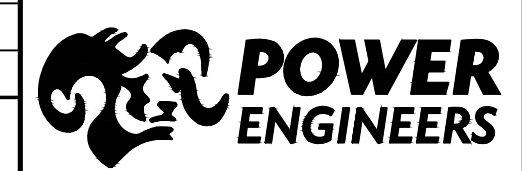

MIDDLE RIVER POWER	JOB NUMBER	REV
VACA ARGES POWER CENTER	0256726	B
BESS ELECTRICAL SITE LIGHTING LIGHTING STATISTICS	DRAWING NUMBER	E18-00-02

LIGHTING GENERAL NOTES

1. VERIFY UNDERGROUND UTILITIES, PIPING AND DUCTBANKS PRIOR TO TRENCHING FOR UNDERGROUND INSTALLATION.
2. CONTRACTOR SHALL BE RESPONSIBLE FOR FINAL COORDINATION OF LIGHTING FIXTURE LOCATIONS AND FOR RELOCATION OF FIXTURE WHERE NECESSARY TO AVOID INTERFERENCE.
3. INSTALLATION DETAILS, WHEN SHOWN, ARE GENERAL IN NATURE AND SHALL BE ADAPTED TO SATISFY FIELD CONDITIONS.
4. GRAPHICAL REPRESENTATIONS ON THE LIGHTING DETAILS ARE GENERAL IN NATURE AND MAY NOT ACCURATELY DEPICT THE EQUIPMENT OR THE MANUFACTURER LISTED.
5. ALL LIGHTING FIXTURES, AND SWITCHES SHALL BE GROUNDED BY MEANS OF A GREEN INSULATED GROUNDING CONDUCTOR RUN WITH THE LINE/PHASE CONDUCTORS FROM THE PANEL GROUND BUS TO THE FIXTURES, AND SWITCHES. THE GROUNDING CONDUCTOR SHALL BE THE SAME SIZE AS THE CIRCUIT LINE/PHASE CONDUCTORS.
6. ALL WORK AND MATERIALS SHALL BE NEW, U.L. LISTED AND IN ACCORDANCE WITH THE LATEST REVISION OF THE NATIONAL ELECTRICAL CODE.
7. IT IS NOT THE INTENTION OF THESE DRAWINGS THAT EVERY FITTING, SUPPORT, WIRE OR DEVICE BE SHOWN. ALL SUCH ITEMS SHALL BE FURNISHED AND INSTALLED AS NECESSARY FOR A COMPLETE ELECTRICAL SYSTEM CONFORMING TO THE LATEST APPLICABLE LOCAL CODES AND THE NATIONAL ELECTRICAL CODE.
8. USE OF MANUFACTURER AND CATALOG NUMBERS ARE INTENDED TO CONVEY QUALITY AND TYPE OF MATERIAL REQUIRED. ALL MATERIAL IS SPECIFIED "OR APPROVED EQUAL" UNLESS NOTED. ALTERNATES MAY BE USED IF APPROVED BY ENGINEER.
9. CONDUITS SHALL BE SIZED IN ACCORDANCE WITH THE REQUIREMENTS OF THE LATEST EDITION OF THE NATIONAL ELECTRICAL CODE (NEC). THE EXACT CONDUIT ROUTING AND ARRANGEMENT WITHIN CONDUIT GROUPS SHALL BE DETERMINED BY THE ELECTRICAL CONTRACTOR. THE SUPPORTS FOR METALLIC CONDUIT ARE TO BE PROVIDED BY THE ELECTRICAL CONTRACTOR, AT INTERVALS NOT TO EXCEED 10'-0".
10. THE ELECTRICAL CONTRACTOR SHALL FURNISH AND INSTALL ADDITIONAL PULL POINTS (PULL SLEEVES, WIREWAYS OR PULL BOXES) WHERE REQUIRED TO LIMIT THE NUMBER OF 90 DEGREE BENDS TO THE REQUIREMENTS OF THE NEC. PULL BOXES SHALL BE FURNISHED BY THE ELECTRICAL CONTRACTOR AND SHALL BE SIZED AND INSTALLED IN ACCORDANCE WITH NEC.
11. MOUNTING HEIGHTS OF LIGHTING FIXTURES SHALL BE THE DISTANCE BETWEEN THE FINISHED GRADE AND THE BOTTOM OF THE FIXTURE.
12. ALL MOUNTING HARDWARE SHALL BE GALVANIZED OR STAINLESS STEEL INCLUDING NUTS, AND BOLTS.
13. UPON COMPLETION OF LIGHTING SYSTEM, THE OWNER WILL PROVIDE A SURVEY OF THE SITE TO VERIFY ADEQUATE LIGHTING FOR GENERAL MAINTENANCE AND SAFETY REQUIREMENTS. ADJUST OR ADD LIGHTING AS NECESSARY.

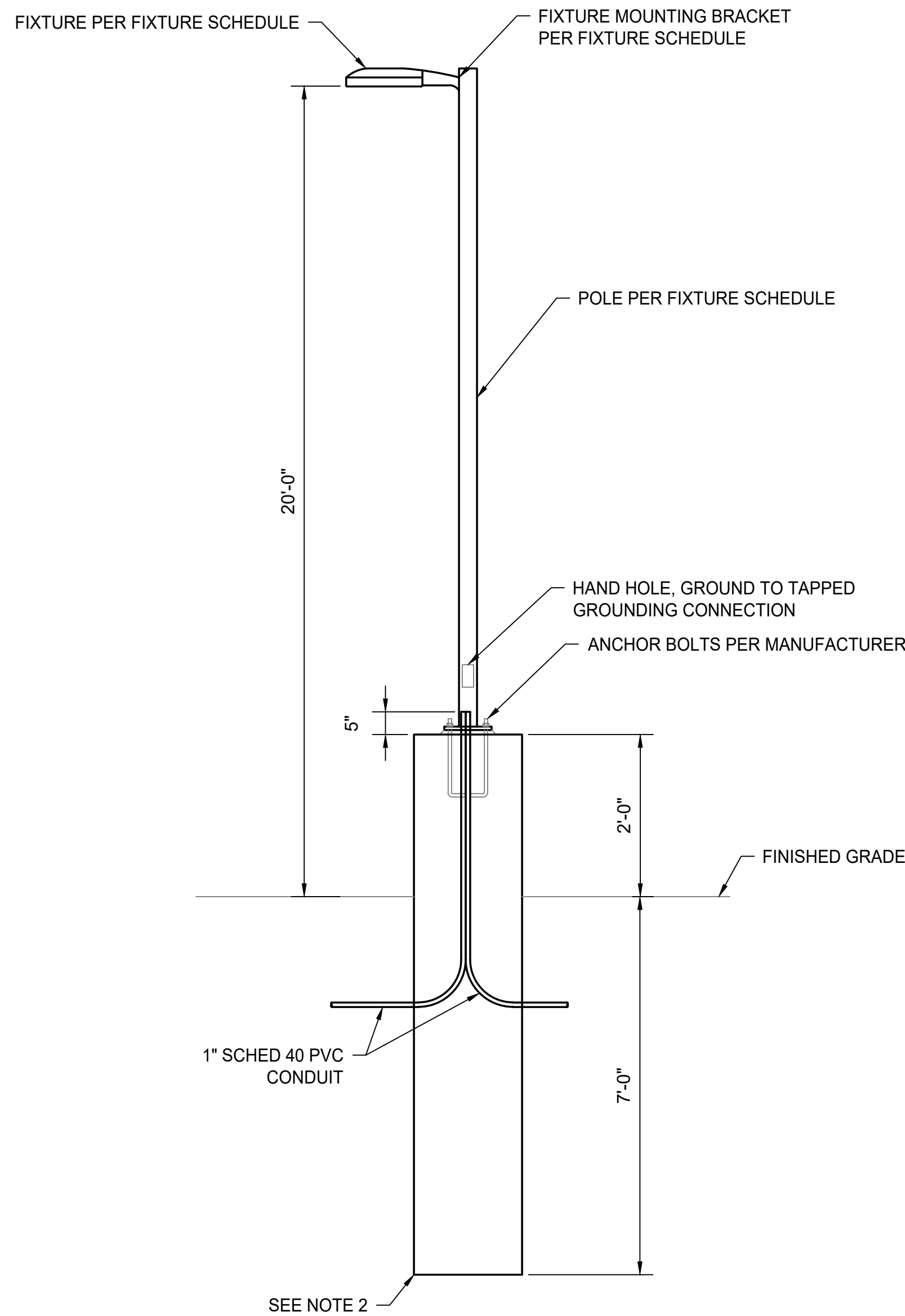

AREA LIGHT FIXTURE POLE MOUNTED DETAIL

NOTES

1. LIGHTING WILL COMPLY WITH DARK SKY REQUIREMENTS. THIS INCLUDES UTILIZING SHIELDING SO NO LIGHT IS EMITTED ABOVE THE HORIZONTAL PLANE. LIGHTS SHOULD BE 3000K OR WARMER. USE TIMERS AND PHOTOCELLS SO LIGHTS ARE ONLY ON WHEN NEEDED.
2. ALL CONDUIT FITTINGS AND BOX CONNECTIONS SHALL BE WEATHERPROOF.
3. EXTERIOR LIGHTING DESIGN FOR THE PROJECT WILL INCORPORATE MEASURES TO CONTROL OFF-SITE REFLECTANCE FROM EXTERIOR SURFACES IN ACCORDANCE WITH APPLICABLE CITY AND COUNTY MUNICIPAL CODES GOVERNING GLARE AND LIGHT TRESPASS. ALL EXTERIOR EQUIPMENT ENCLOSURES, BATTERY CABINETS, INVERTER HOUSINGS, FENCING, AND ANCILLARY STRUCTURES WILL UTILIZE NON-REFLECTIVE OR LOW-GLOSS FINISHES TO MINIMIZE REFLECTION OF BOTH NATURAL AND ARTIFICIAL LIGHT BEYOND THE PROJECT BOUNDARY. SURFACE COATINGS WILL GENERALLY BE MATTE OR SEMI-MATTE INDUSTRIAL FINISHES WITH LOW REFLECTIVITY VALUES, AND HIGHLY POLISHED OR METALLIC SURFACES WILL BE AVOIDED. LIGHTING FIXTURES WILL BE FULL CUT-OFF, DOWNWARD-DIRECTED LUMINAIRES DESIGNED TO LIMIT UPWARD LIGHT AND OFF-SITE GLARE, AND WILL BE POSITIONED TO ILLUMINATE ONLY REQUIRED OPERATIONAL AREAS.
4. THE PROJECT INTENDS TO UTILIZE EXTERIOR LIGHTING FIXTURES THAT CARRY THE DARKSKY (INTERNATIONAL DARK-SKY ASSOCIATION) FIXTURE SEAL OF APPROVAL WHERE SUCH FIXTURES ARE REASONABLY AVAILABLE AND COMPATIBLE WITH THE OPERATIONAL AND DURABILITY REQUIREMENTS OF THE FACILITY. HOWEVER, THE AVAILABILITY OF FIXTURES BEARING THE FORMAL DARKSKY SEAL CAN VARY DEPENDING ON MANUFACTURER OFFERINGS, SUPPLY CHAIN CONDITIONS, AND SPECIFIC INDUSTRIAL PERFORMANCE REQUIREMENTS. IN THE EVENT THAT FIXTURES WITH THE DARKSKY APPROVAL MARK CANNOT BE REASONABLY PROCURED, THE PROJECT WILL INSTEAD SPECIFY LIGHTING FIXTURES THAT ARE DESIGNED AND MANUFACTURED TO MEET THE FUNCTIONAL DARKSKY LIGHTING PRINCIPLES, INCLUDING FULL CUT-OFF DISTRIBUTION, SHIELDING TO PREVENT UPWARD LIGHT EMISSION, MINIMIZED GLARE, AND APPROPRIATE COLOR TEMPERATURE TO LIMIT SKYGLOW AND OFF-SITE LIGHT TRESPASS. IN THIS MANNER, THE LIGHTING DESIGN WILL MAINTAIN CONFORMANCE WITH DARKSKY PERFORMANCE REQUIREMENTS AND APPLICABLE MUNICIPAL LIGHTING STANDARDS EVEN IF THE SELECTED FIXTURES DO NOT CARRY THE FORMAL DARKSKY CERTIFICATION LABEL.

LIGHTING FIXTURE SCHEDULE

LABEL	QTY	POLE MOUNTING HEIGHT	MANUFACTURER	CATALOG	DESCRIPTION	LAMP OUTPUT (LUMENS)	WATTS
A	9	20FT	LITHONIA LIGHTING	DSX0-LED-P1-30K-70CRI-T1S-HS	D-SERIES SIZE 0 AREA LUMINAIRE P1 PERFORMANCE PACKAGE 3000K CCT 70 CRI TYPE 1 SHORT HOUSESIDE SHIELD	4507	33
B	37	20FT	LITHONIA LIGHTING	DSX1-LED-P1-30K-70CRI-T1S-HS	D-SERIES SIZE 1 AREA LUMINAIRE P1 PERFORMANCE PACKAGE 3000K CCT 70 CRI TYPE 1 SHORT HOUSESIDE SHIELD	7143	51

E18-00-00 BESS ELECTRICAL SITE LIGHTING - NOTES AND SCHEDULE.DWG

THIS DRAWING WAS PREPARED BY POWER ENGINEERS, INC. FOR A SPECIFIC PROJECT. TAKING INTO CONSIDERATION THE SPECIFIC AND UNIQUE REQUIREMENTS OF THE PROJECT, REUSE OF THIS DRAWING OR ANY INFORMATION CONTAINED IN THIS DRAWING FOR ANY PURPOSE IS PROHIBITED UNLESS WRITTEN PERMISSION FROM BOTH POWER AND POWER'S CLIENT IS GRANTED.

PRELIMINARY

NOT FOR CONSTRUCTION

REV	REVISIONS	DATE	DRN	DSGN	CKD	APPD	REFERENCE DRAWINGS
B	FOR PERMIT REVIEW	07/01/2025	SLM	CSM	TWH	TWH	
A	FOR PERMIT REVIEW	04/04/2025	SLM	CSM	TWH	TWH	

DSGN	CSM	APR 2025
DRN	SLM	APR 2025
CKD	TWH	APR 2025
SCALE:	NONE	



MIDDLE RIVER POWER		JOB NUMBER	REV
VACA ARGES POWER CENTER		0256726	B
BESS ELECTRICAL SITE LIGHTING NOTES AND SCHEDULE		DRAWING NUMBER	E18-00-00