

DOCKETED	
Docket Number:	23-OPT-02C
Project Title:	Darden Clean Energy - Compliance
TN #:	269194
Document Title:	MCR No 9 Appendix C
Description:	Appendix C for DCEP February MCR.
Filer:	Eric Schaad
Organization:	Rincon
Submitter Role:	Applicant Consultant
Submission Date:	3/13/2026 4:33:55 PM
Docketed Date:	3/13/2026

HARLAN SWITCHING STATION COMPLIANCE REPORT FEBRUARY 2026

PREPARED FOR:
CALIFORNIA ENERGY COMMISSION ON
MARCH 1ST, 2026

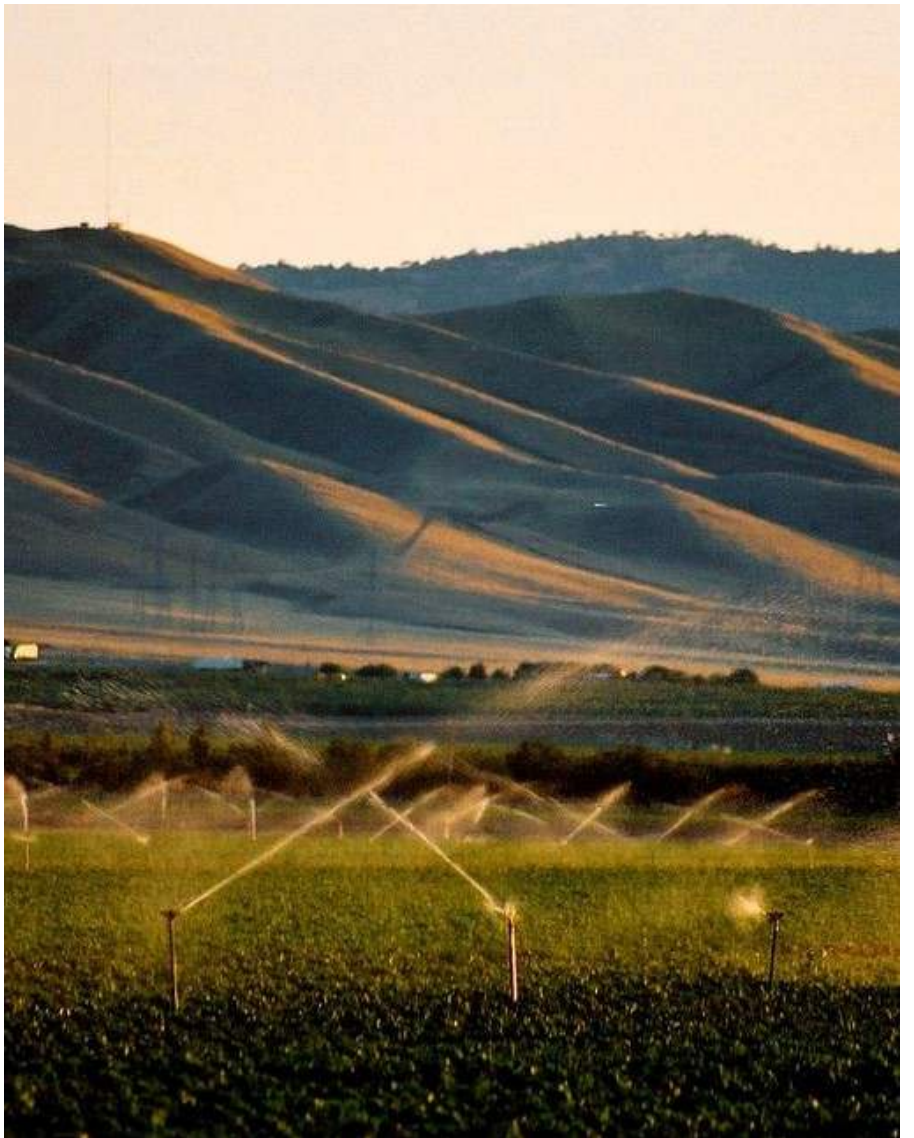

Table of Contents

- **GEN-02 & COM-06:**

1. Project schedule
2. Project permits
3. Items added to on-site compliance file (01.2026)
4. Compliance activities outlook (.01.2026 & 02.2026)
5. Compliants, notices of violation, official warnings, and/or citations received.

- **SWITCH-AQ-01 & AQSC-04:**

1. Summary of actions taken to maintain compliance with this condition
2. Complaints filed with regional APCD received.
3. Daily air quality inspection reports

- **SWITCH-GHG-01:**

1. AQSC-05
 - Summary of actions taken to maintain compliance with this condition
 - Monthly equipment inventory & run time.
 - Monthly GHG-01 best practices inspection

- **WATER-06:**

1. Summary of monthly water use

- **WORKER-SAFETY-03:**

1. Monthly safety inspection
2. Training sign-in sheets
3. NOISE-02
 - Noise exposure log & monitoring
4. WORKER-SAFETY-11
 - Respirator training & monitoring
 - Valley fever symptoms and/or case reporting
5. SWITCH-HAZ-02
 - Monthly fire extinguisher inspection

- **TRANS-02:**

1. Haul permits log.
2. Hazardous materials delivery log

GEN-02 & COM-06

1. PROJECT SCHEDULE

Site activities commenced on Monday, November 3rd. Work executed during November included surveying and staking, coordination with Rincon for burrow clearance, installation of stormwater and air-quality BMPs, roadway and switchyard pad grading, and receipt of initial equipment deliveries. As we moved into December, site crews maintained steady progress on critical earthwork operations. Activities included the continued over-excavation of the pad to achieve design subgrade elevations, followed by cut, fill, and compaction processes to ensure proper soil density and stability. Additional crews were mobilized to begin drilling and pouring piers for the MPAC foundation. Large amounts of rain on site caused delays to foundation pours. In addition to these efforts, the access road was successfully completed during the month. Steel deliveries for above grade construction began in December as well and the site has received all steel required for this project at this time.

Current progress toward major construction tasks is as follows:

Task	Status
Site preparation BMPs	100% complete
Burrow cleaning (in coordination with Rincon)	100% complete
Stripping organics across site	100% complete
Pad over-excavation	75% complete
Pad cut / fill / compaction	65% complete.
Access road installation	100% complete
Foundation Survey	80% complete
MPAC Foundation	10% complete

Planned activities for March 2026 include continuing grading and compaction work on the switchyard pad and foundation & below grade scope of work will continue into March. Overall, site preparation is progressing as scheduled, with foundational earthwork well underway and critical environmental compliance measures fully implemented.

GEN-02 & COM-06

Harlan Project

WEEKLY REPORT

21055 South Derrick Ave, Cantua Creek, CA, 93608

Job #: 604650	Week Ending: February 1, 2026
Site Manager: Julian Robertson	Project Manager: Trevor Young

Workforce	Completed Activities	M	T	W	Th	F	S	Su
Dacon - Civil	MPAC/Battery Building portion of pad complete (imported fill)				x			
Dacon - Electrical								
Dacon - Foundations	Mobilization			x	x	x		
Total Manhours		0	0	0	0	0	0	0

3 WEEK LOOK AHEAD		M	T	W	Th	F	S	Su	M	T	W	Th	F	S	Su	M	T	W	Th	F	S	Su
Dacon Civil	Pad Area	9	10	11	12	13	14	15	16	17	18	19	20	21	22	23	24	25	26	27	28	1
	Excavation of Quadrants 1 and 3	x	x	x	x	x	x		x	x	x	x	x	x		x	x	x	x	x	x	x
	Fill and Compaction of Quadrants 2 and 4	x	x	x	x	x	x		x	x	x	x	x	x		x	x	x	x	x	x	x
Dacon Electrical	Receive material and stack/store								x	x	x											
Dacon Foundation	Install foundations MPAC area	x	x	x	x	x	x		x	x	x	x	x		x	x	x	x	x	x	x	x
	Install/build forms	x	x	x	x	x	x		x	x	x	x	x		x	x	x	x	x	x	x	x
	Install pier foundations	x	x	x	x	x	x		x	x	x	x	x		x	x	x	x	x	x	x	x
	Place concrete/slurry						x				x	x					x		x			
Total Projected Manpower																						

Project Specific Contacts					
Contact Name & Title	Company	Phone #	Contact Name & Title	Company	Phone #
Trevor Young - PM	Dashiell	281-450-2971			
Isaac Sandoval - APM	Dashiell	346-870-9501			
Julian Robertson - CM	Dashiell	601-590-1884			



GEN-02 & COM-06

Harlan Project

WEEKLY REPORT

21055 South Derrick Ave, Cantua Creek, CA, 93608

Job #:	604650	Week Ending:	February 15, 2026
Site Manager:	Julian Robertson	Project Manager:	Trevor Young

Workforce	Completed Activities	M	T	W	Th	F	S	Su
Dacon - Civil	MPAC/Battery Building portion of pad complete (imported fill)				x			
Dacon - Electrical								
Dacon - Foundations	Mobilization	x						
	MPAC Slurry wall						x	
Total Manhours		0	0	0	0	0	0	0

3 WEEK LOOK AHEAD		M	T	W	Th	F	S	Su	M	T	W	Th	F	S	Su	M	T	W	Th	F	S	Su
Dacon Civil	Pad Area	16	17	18	19	20	21	22	23	24	25	26	27	28	1	2	3	4	5	6	7	8
	Excavation of Quadrants 1 and 3	x	x	x	x	x	x		x	x	x	x	x	x		x	x	x	x	x	x	
	Fill and Compaction of Quadrants 2 and 4	x	x	x	x	x	x		x	x	x	x	x	x		x	x	x	x	x	x	
Dacon Electrical	Receive material and stack/store	x	x	x																		
Dacon Foundation	MPAC Area																					
	Forms	x	x	x	x	x	x									x	x	x	x	x	x	
	Rebar								x	x	x	x	x	x								
	Bay 3																					
	Drilling Piers	x	x	x	x	x	x		x	x	x	x	x	x		x	x	x	x	x	x	
	Concrete		x		x		x			x		x		x								x
Total Projected Manpower																						

Project Specific Contacts					
Contact Name & Title	Company	Phone #	Contact Name & Title	Company	Phone #
Trevor Young - PM	Dashiell	281-450-2971			
Isaac Sandoval - APM	Dashiell	346-870-9501			
Julian Robertson - CM	Dashiell	601-590-1884			



GEN-02 & COM-06

Harlan Project		WEEKLY REPORT																								
21055 South Derrick Ave, Cantua Creek, CA, 93608																										
Job #: 604650		Week Ending:							February 22, 2026																	
Site Manager: Julian Robertson		Project Manager:							Trevor Young																	
Workforce	Completed Activities	M	T	W	Th	F	S	Su																		
Dacon - Civil																										
Dacon - Electrical																										
Dacon - Foundations	Drilled foundations																									
Total Manhours		0	0	0	0	0	0	0																		
3 WEEK LOOK AHEAD																										
Workforce	Planned Activities:	M	T	W	Th	F	S	Su	M	T	W	Th	F	S	Su	M	T	W	Th	F	S	Su				
Dacon Civil	Pad Area	23	24	25	26	27	28	1	2	3	4	5	6	7	8	9	10	11	12	13	14	15				
	Excavation of Quadrants 1 and 3	x	x	x	x	x	x		x	x	x	x	x	x		x	x	x	x	x	x	x				
	Fill and Compaction of Quadrants 2 and 4	x	x	x	x	x	x		x	x	x	x	x	x		x	x	x	x	x	x	x				
Dacon Electrical	Receive material and stack/store	x																								
Dacon Foundation	MPAC Area																									
	Forms	x	x	x					x	x	x	x	x	x	x	x	x	x	x	x	x					
	Rebar	x	x	x	x	x	x		x	x	x	x	x	x	x	x	x	x	x	x	x					
	Bay 3																									
	Drilling Piers	x	x	x	x	x	x		x	x	x	x	x	x	x	x	x	x	x	x	x					
	Concrete		x		x		x			x		x		x		x		x		x						
Total Projected Manpower																										
Project Specific Contacts																										
Contact Name & Title	Company	Phone #	Contact Name & Title	Company	Phone #																					
Trevor Young - PM	Dashiell	281-450-2971																								
Isaac Sandoval - APM	Dashiell	346-870-9501																								
Julian Robertson - CM	Dashiell	601-590-1884																								



GEN-02 & COM-06

2. PROJECT PERMITS

Dashiell received an Encroachment Permit from the Fresno County Road Maintenance and Operations Division on November 11, 2025, authorizing construction of the switching station access road within the County Right-of-Way (ROW). The permit remains valid through December 29, 2025.

In addition, Dashiell's construction business unit, Dacon, secured water-use rights for the project from Britz Helm TIC on October 13, 2025. This agreement authorizes the use of up to seven acre-feet of water to support project activities - including, but not limited to, dust suppression for the duration of construction.

GEN-02 & COM-06



ROAD IMPROVEMENT PERMIT
COUNTY OF FRESNO
ROAD MAINTENANCE AND OPERATIONS DIVISION
 MAILING ADDRESS: 2220 TULARE STREET, 6TH FLOOR, FRESNO, CA 93721
 OFFICE LOCATION: SOUTHWEST CORNER OF TULARE & 'M' STREETS, SUITE B

In compliance with County of Fresno Ordinance Nos. 13.04040, 13.08.010 and Chapter 5.5 of Division 2 of the Streets and Highways Code, the undersigned hereby applies for permission to excavate, construct and/or otherwise encroach on the County right-of-way by performing the following work.

PROJECT INFORMATION

Permit Title: Harlan Switching Station Access Road 20' Approach	Permit No: IP25-0970
Location of Proposed Work: S DERRICK AVE, APPROX. 5,000 S/O HWY I-5	Folder No.: 25 014801 For Inspection Service: Phone: (559) 600-4240 Fax: (559) 600-4203 EncroachmentPermits@fresnocountyca.gov

Description of Proposed Work:
 Authorization is granted to place and utilize traffic control devices within the County of Fresno Road right of way for constructing a 20'W gravel driveway entrance for the Harlan Switching Station as shown on the provided permit drawings.

<u>11/13/25</u>	<u>12/2/25</u>	<u>10</u>
Estimated Starting Date	Estimated Completion Date	Traffic Control Days

consideration of the granting of this application, it is agreed that the applicant shall indemnify the County of Fresno and any of its officers, employees and agents and shall defend and hold them harmless from any and all claim or liability for personal injury or property damage due to any acts or failure to act in connection with any work permitted herein. Applicant further agrees to comply with all terms, conditions and specifications contained below and on the reverse side hereof.

PERMIT APPROVAL

NOTIFY THE COUNTY OF FRESNO PERMIT DESK AT (559)600-4240-4240 A MINIMUM OF 48 HOURS IN ADVANCE OF BEGINNING CONSTRUCTION ACTIVITIES.

Permission is hereby granted to perform the above-described work subject to all terms, conditions and restrictions contained below and on the reverse side hereof. This permit is to be strictly construed and no work other than that specified is authorized hereby. This permit is expressly conditioned upon performance of the work. Failure to perform said work in accordance with County specifications shall be deemed an immediate revocation of this permit and without notice.
 WORK SHALL BE SUBJECT TO COUNTY INSPECTION. PERMITEE SHALL NOTIFY COUNTY INSPECTOR **Nuvdeep Jhutti** A MINIMUM OF 48 HOURS BEFORE STARTING WORK. **559-554-4101**
 THIS PERMIT SHALL BE VOID UNLESS THE WORK HEREIN CONTEMPLATED SHALL HAVE BEEN COMPLETED BEFORE **12/2/25 9:41AM**.
 To commence or complete work after said date requires approved application for permit renewal or time extension. Grantor reserves the right to complete the work to restore.

PROJECT CONDITIONS

ATTACHED ADDENDUM IS A PART OF THIS PERMIT

APPLICANT: Starflower Environmental	OWNER: IP DARDEN I, LLC c/o Intersect Po
ADDRESS: 801 BIG BEAVER RD W SUITE 300, TROY MS 48084-	ADDRESS: 9460 SW Gemini Drive PMB #68743, Beaverton, OR
PHONE: (734) 645-4098	PHONE: (805) 644-4455
EMAIL:	EMAIL:
Project Manager: Myles Markey (734) 645-4096	
APPLICANT SIGNATURE: (X) _____	DATE: _____
ACCOUNT NUMBER: _____	LICENSE NUMBER: _____ BOND NUMBER: _____

PERMIT QUANTITIES & INSPECTION FEES

2201.A.11 - Traffic Control System	426.00	10 days of TC
2204.A.4 - Asphalt Concrete (HMA) Approach/Front	367.00	20' W Gravel A
TOTAL PROJECT FEES:		793.00

Permit No.: IP25-0970
MTCE Area: 03

Mohamoud Mohamed

Steven E. White, Director
Department of Public Works & Planning

By: Mohamoud Mohamed Date: 11/12/25
for **Ruben Garcia, Permit Engineer**

WHITE - Office Copy GREEN - Inspector Copy CANARY - Permittee Copy PINK - Accounting Copy GOLDENROD - Area Supervisor Copy FOR OFFICE USE ONLY



GEN-02 & COM-06

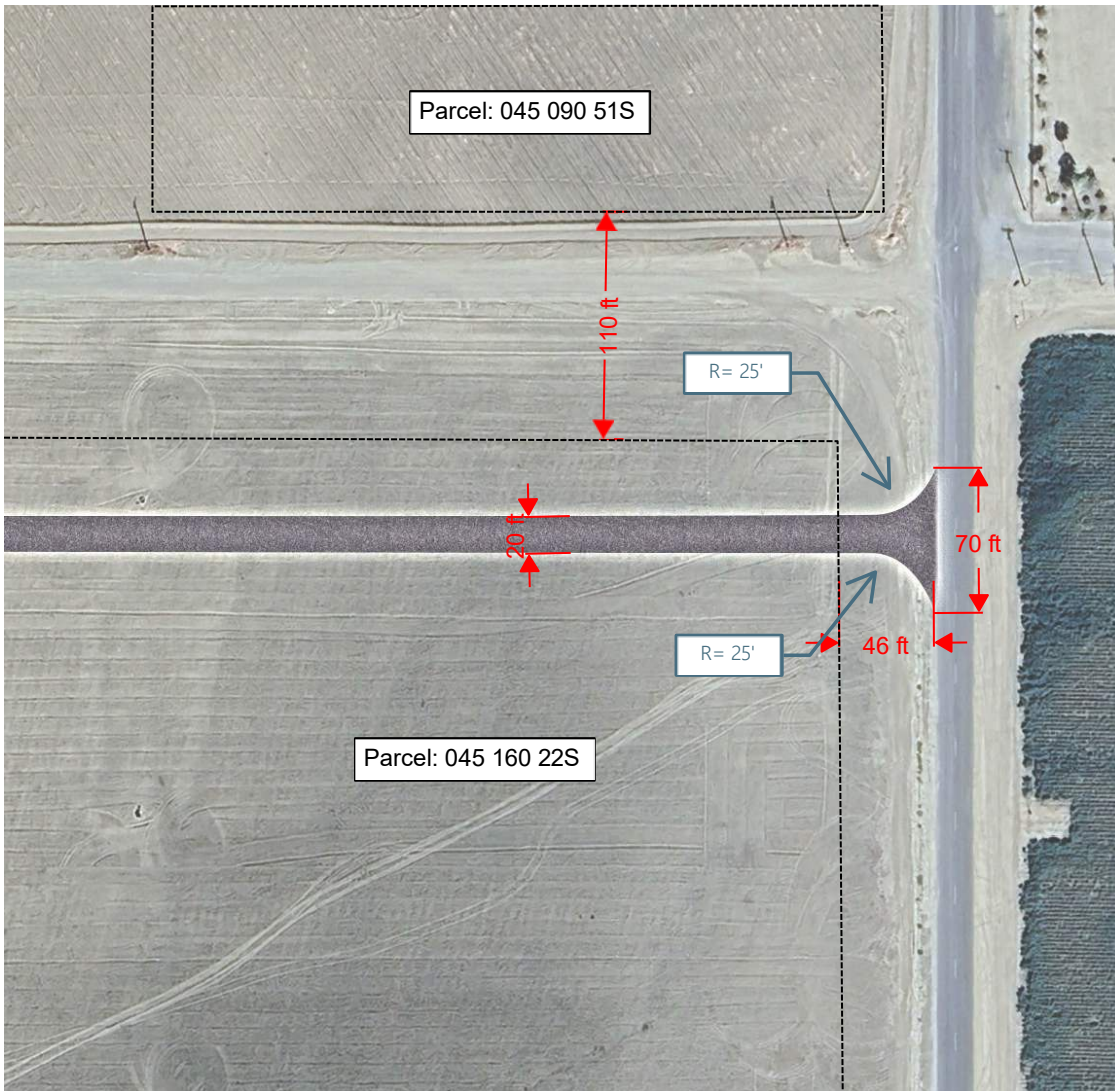

NOTES:

ROADWAY CONSTRUCTION WITHIN FRESNO COUNTY ROW SHALL BE CONSTRUCTED TO THE COUNTY OF FRESNO DEPARTMENT OF PUBLIC WORKS AND PLANNING DETAIL ST32: RURAL RESIDENTIAL DRIVEWAY APPROACH

SHEET TITLE:	HARLAN ACCESS ROAD JUNCTION DIMENSIONS
PROJECT:	HARLAN 500KV BAAH SWITCHYARD
ROADWAY:	S. DERRICK AVE.
DATE:	11/12/2025
REV:	02

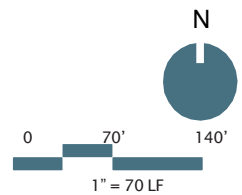

GEN-02 & COM-06

DURATION OF ENCROACHMENT PERMIT:	12/01/2025 - 12/29/2025
TRAFFIC CONTROL TOTAL NUMBER OF DAYS:	4
WORK HOURS:	7AM-4PM
ON SITE PROJECT MANAGER:	ISAAC SANDOVAL (346)-870-9501

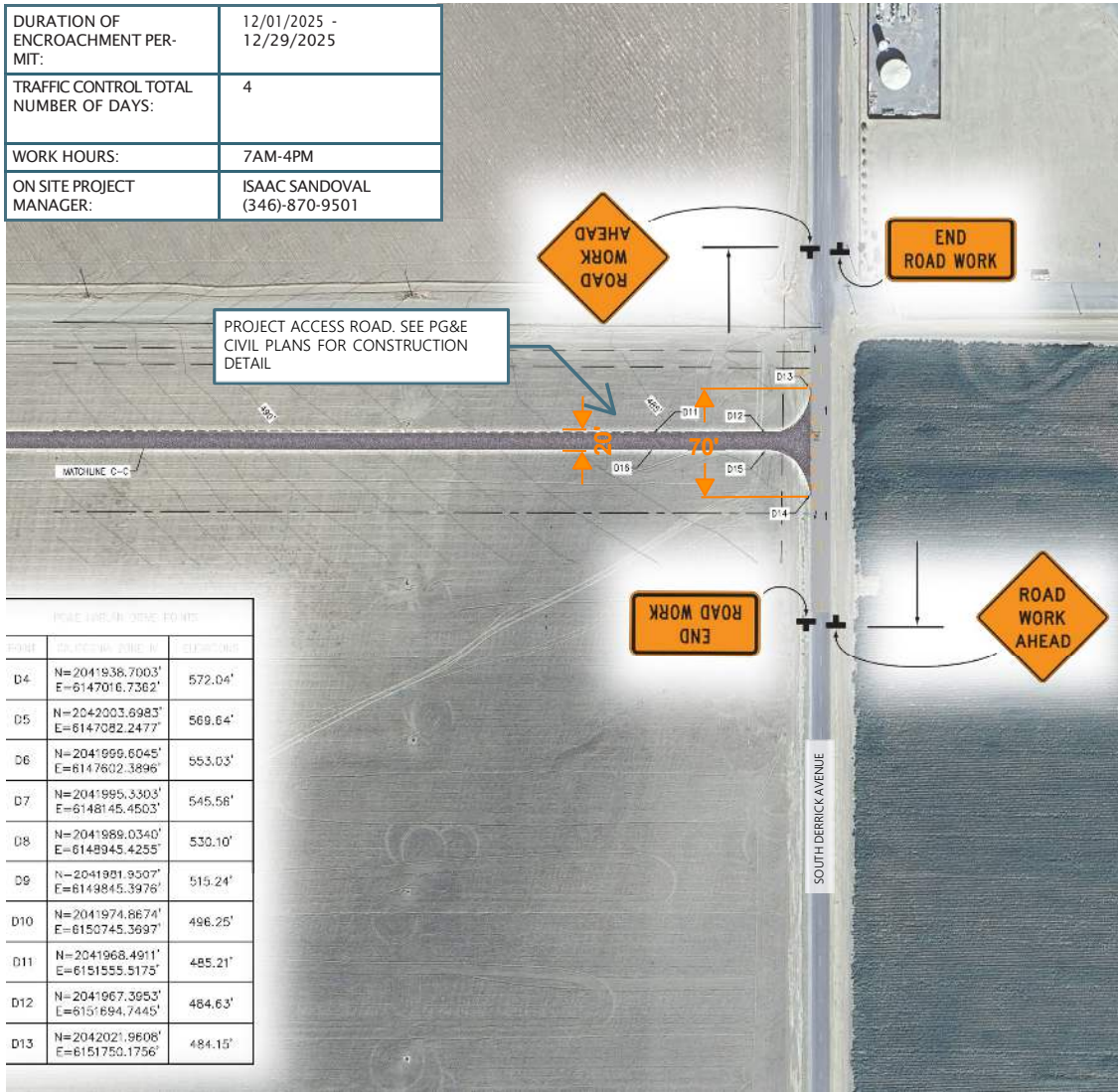

POINT	CORRECTED COORDINATES	ELEVATION
D4	N=2041938.7003' E=6147016.7362'	572.04'
D5	N=2042003.6983' E=6147082.2477'	569.64'
D6	N=2041999.6045' E=6147602.3896'	553.03'
D7	N=2041995.3303' E=6148145.4503'	545.56'
D8	N=2041988.0340' E=6148945.4255'	530.10'
D9	N=2041991.9507' E=6149845.3976'	515.24'
D10	N=2041974.8674' E=6150745.3997'	496.25'
D11	N=2041968.4911' E=6151555.5175'	485.21'
D12	N=2041967.3953' E=6151694.7445'	464.63'
D13	N=2042021.9608' E=6151750.1756'	484.15'

NOTES:
1. SEE CALIFORNIA MUTCD 2014 EDITION DETAIL TA-6 AND FIGURE 6H-7 FOR FURTHER DETAIL.

Tracy
Barnes
2025.11.2
6 10:44:24
-08'00'

SHEET TITLE:	HARLAN EP TRAFFIC CONTROL PLAN OVERVIEW
ROADWAY:	S. DERRICK AVE.
DATE:	11/24/2025
PROJECT:	HARLAN 500KV BAAH SWITCHYARD

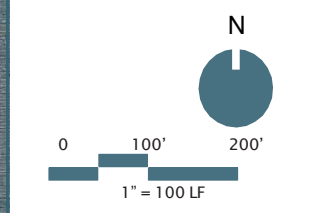

GEN-02 & COM-06



DACON CORPORATION



1300 UNDERWOOD DEERPARK, TX 77536

PHONE: 713-578-6001

WATER PROCUREMENT AGREEMENT

This Water Procurement Agreement ("Agreement") is entered into as of [Effective Date] by and between ~~Britz Farming Corp.~~ ("Seller") and Dacon Corp. ("Buyer").

Britz Helm TIC

1. Purpose

Seller agrees to supply, and Buyer agrees to purchase and take delivery of, up to seven (7) acre-feet of water for Buyer's operational needs, on the terms set forth herein.

2. Quantity; Term

2.1 Contract Quantity: Total quantity available under this Agreement shall not exceed 7.0 AF during the Term.

2.2 Term: This Agreement commences on the Effective Date of 10/13/2025 and continues through 4/6/2027 unless earlier terminated.

3. Price; Billing; Payment

Price: \$3,000.00 per Acre-Foot (AF).

Billing: Seller will invoice monthly based on metered volume delivered. Each invoice will show meter readings delivered.

Payment Terms: Net 30 days from invoice date.

4. Delivery; Title; Risk of Loss

Delivery will be made at the Delivery Point(s). Title and risk of loss for water pass to Buyer at the Delivery Point.

GEN-02 & COM-06

5. Measurement; Tracking; Access

Deliveries shall be measured by calibrated meters. Seller will provide Buyer with monthly meter logs. Buyer may inspect meters with notice.

6. Shortage; Curtailment

Deliveries may be reduced or suspended due to shortages, regulatory curtailments, or force majeure. Charges apply only to volumes actually delivered.

7. Water Rights; Quality; Use

Seller represents it has the right to deliver water. Water is delivered as-is. Buyer is responsible for use and end-use permits.

8. Default; Remedies; Termination

Buyer default for nonpayment after 30 days' notice allows Seller to suspend deliveries. Seller default not cured within 15 days allows Buyer to terminate.

9. Governing Law

This Agreement is governed by the laws of the State of CA. Disputes shall be resolved in courts located in [Fresno County,CA].

SIGNATURES

SELLER: Brintz Farming Corp.

By: David Brintz

Name: David Brintz

Title: Partner

Date: 10/13/25

BUYER: Dacon Corp.

By: Richard Lee

Name: Richard Lee

Title: Purchasing

Date: 10/06/2025

GEN-02 & COM-06

3. ITEMS ADDED TO ON-SITE COMPLIANCE FILE

The following Conditions of Compliance (COC) items were added to the on-site monthly comply file for the Harlan Switching Station:

CONSTRUCTION & TRANSPORTATION

TRANS-02

Haul permits log.

Hazardous waste delivery log

TRANS-03

Roadway inspection, pre-mobilization

SWICH-WASTE-01

Waste diversion training log.

HEALTH & SAFETY

WORKER-SAFETY-11

Valley fever training log

Air quality monitoring & inspections

NOISE-02

Noise pollution training log

SWITCH-HAZ-02

Emergency & fire protection training log

Fire extinguisher inspection form

WORKER-SAFETY-03

General site safety inspection & certification

ENVIRONMENTAL

SWITCH-HAZ-01

Monthly SPCC inspection

Waste Management

SWITCH-WATER-01

Weekly & post precipitation bmp inspections

GEN-02 & COM-06

4. COMPLIANCE ACTIVITIES OUTLOOK – FEBRUARY 2026 & MARCH 2026

Dashiell will continue performing the following routine COC activities:

CONSTRUCTION & TRANSPORTATION

TRANS-02

Haul permits log.

Hazardous waste delivery log

SWICH-WASTE-01

Waste diversion training log

Monthly waste diversion log

Construction waste log.

HEALTH & SAFETY

WORKER-SAFETY-11

Valley fever training log

Air quality monitoring & inspections

SWITCH-HAZ-02

Emergency & fire protection training log

Fire extinguisher inspection form

WORKER-SAFETY-03

General site safety inspection & certification

ENVIRONMENTAL

SWITCH-HAZ-01

Monthly SPCC inspection

SWITCH-WATER-01

Weekly & post precipitation bmp inspections

SWITCH-GHG-01

Implementation of greenhouse emissions reduction

Combustion engine emissions log

GEN-02 & COM-06

Dashiell will perform the following COC activities as needed, based on corresponding conditional triggers:

CONSTRUCTION & TRANSPORTATION

TRANS-02

County/state roadway damage report and corrective action plan

VIS-02

Site lighting inspection by Compliance Project Manager (CPM)

SWITCH-AQ-01

Dust plume complaint report and corrective action plan.

HEALTH & SAFETY

WORKER-SAFETY-11

Mandatory respirator requirements, including buddy system training, implementation and fit.

checks

Suspected case report form

High risk BMP implementation and/or construction activity suspension

SWITCH-HAZ-02

Emergency & fire protection training log

Fire extinguisher inspection form

NOISE-02

High noise activity dosimeter monitoring and subsequent adjacent activity exposure logging

ENVIRONMENTAL

SWITCH-HAZ-01

Post-spill SPCC report

SWITCH-WATER-01

Post-precipitation stormwater BMP inspection and rain gauge check

SWITCH-AQ-01 & AQSC-04

1. SUMMARY OF ACTIONS TAKEN TO MAINTAIN COMPLIANCE WITH THIS CONDITION

Throughout the current phase of construction, the project team has implemented a comprehensive set of dust-control and air-quality protection measures to minimize fugitive emissions, reduce offsite particulate transport, and maintain safe working conditions. Routine watering of disturbed soil has been conducted to preserve adequate surface moisture, supplemented by the retention of vegetation and on inactive areas to reduce wind-driven erosion. Haul routes and primary traffic lanes have been actively maintained through periodic wetting and grading to ensure dust-controlled travel surfaces. Spoil piles and material stockpiles have been stabilized as needed to prevent drying and subsequent plume formation, and, where feasible, heavy equipment has been operated using enclosed, HEPA-filtered cabs to reduce operator exposure.

Operational controls have also been consistently enforced. Site-wide speed limits have been restricted to 10 miles per hour, with further reductions applied during elevated wind conditions or when visible emissions warrant additional caution. Supervisory personnel retain authority to halt dust-generating activities if plume thresholds are reached, ensuring rapid response to changing on-site conditions.

To prevent offsite tracking and transport of soil, the project has maintained rock apron and stabilization features at site exits and applied supplemental watering to minimize material carryout. Adjacent paved surfaces have been cleaned regularly to remove accumulated sediment and limit dust resuspension. Administrative measures, including routine dust-compliance spot checks, visual plume monitoring, opacity observations, and meteorologically based activity triggers, have supported continuous oversight of dust-generating operations.

In accordance with the Construction Management Plan, roadway housekeeping practices have been applied to maintain haul routes and access roads free of mud, loose soil, and track-out. Water has been applied to these surfaces during periods of heavy use to further suppress particulate generation.

Collectively, these measures demonstrate the project's proactive approach to dust mitigation and air-quality management, ensuring compliance with applicable regulatory conditions while supporting worker safety and minimizing environmental impacts.

2. COMPLAINTS FILED WITH REGIONAL APCD RECEIVED

Dashiell has not received any notices of complaints or violations from the San Joaquin Valley Air Pollution Control District.

SWITCH-AQ-01 & AQSC-04

3. DAILY AIR QUALITY INSPECTION REPORT



AIR QUALITY / DUST CONTROL INSPECTION FORM

Project / Site Name: Harlan Switch Station

Date: 2/2/26

Inspector: Isaac Sandoval

Time: 1030

1. Weather Conditions

Parameter	Observation
Temperature (°F)	See attached weather report
Wind Speed (mph)	See attached weather report
Wind Direction	See attached weather report
Humidity (%)	See attached weather report

Conditions: Calm Breezy Windy Gusty Other: _____

2. Dust-Producing Activities Observed

Activity	Active Today?	Notes / Area
Grading / Excavation	<input checked="" type="checkbox"/> Yes <input type="checkbox"/> No	_____
Scraping / Stockpiling	<input checked="" type="checkbox"/> Yes <input type="checkbox"/> No	_____
Loading / Hauling	<input type="checkbox"/> Yes <input checked="" type="checkbox"/> No	_____
Soil Compaction / Rolling	<input checked="" type="checkbox"/> Yes <input type="checkbox"/> No	_____
Trenching / Backfill	<input type="checkbox"/> Yes <input checked="" type="checkbox"/> No	_____
Vehicle Travel on Unpaved Roads	<input checked="" type="checkbox"/> Yes <input type="checkbox"/> No	_____
Material Handling / Crushing / Screening	<input checked="" type="checkbox"/> Yes <input type="checkbox"/> No	_____
Other Dust Source(s): _____	<input type="checkbox"/> Yes <input checked="" type="checkbox"/> No	_____

3. Best Management Practices (BMPs) Implemented

BMP / Control Measure	In Use Today	Comments / Location
Water Truck / Water Tower Application	<input checked="" type="checkbox"/> Yes <input type="checkbox"/> No	_____
Wind Breaks / Fencing	<input type="checkbox"/> Yes <input checked="" type="checkbox"/> No	_____
Gravel Pads / Track-Out Control	<input checked="" type="checkbox"/> Yes <input checked="" type="checkbox"/> No	_____
Stabilized Surfaces (Soil Binder, Mulch, etc.)	<input type="checkbox"/> Yes <input checked="" type="checkbox"/> No	_____
Reduced Vehicle Speeds (<15 mph)	<input checked="" type="checkbox"/> Yes <input type="checkbox"/> No	_____

Ceased Work Due to High Winds	<input type="checkbox"/> Yes <input type="checkbox"/> No	_____
Sweeping / Vacuuming Paved Areas	<input type="checkbox"/> Yes <input type="checkbox"/> No	_____
Covering of Haul Loads	<input type="checkbox"/> Yes <input type="checkbox"/> No	_____
Other Control(s): _____	<input type="checkbox"/> Yes <input type="checkbox"/> No	_____

4. Observations / Corrective Actions

Description	Action Taken / Recommended	Date / Time Completed
_____	_____	_____

5. Photos

_Insert photos below (document visible dust plumes, controls in place, or any observed deficiencies.)

Inspector Signature: Isaac Sandoval Date: 2/2/26

AIR QUALITY / DUST CONTROL INSPECTION FORM

Project / Site Name: Harlan Switch Station

Date: 2/3/26

Inspector: Isaac Sandoval

Time: 1030

1. Weather Conditions

Parameter	Observation
Temperature (°F)	See attached weather report
Wind Speed (mph)	See attached weather report
Wind Direction	See attached weather report
Humidity (%)	See attached weather report

Conditions: Calm Breezy Windy Gusty Other: _____

2. Dust-Producing Activities Observed

Activity	Active Today?	Notes / Area
Grading / Excavation	<input checked="" type="checkbox"/> Yes <input type="checkbox"/> No	_____
Scraping / Stockpiling	<input checked="" type="checkbox"/> Yes <input type="checkbox"/> No	_____
Loading / Hauling	<input type="checkbox"/> Yes <input checked="" type="checkbox"/> No	_____
Soil Compaction / Rolling	<input checked="" type="checkbox"/> Yes <input type="checkbox"/> No	_____
Trenching / Backfill	<input type="checkbox"/> Yes <input checked="" type="checkbox"/> No	_____
Vehicle Travel on Unpaved Roads	<input checked="" type="checkbox"/> Yes <input type="checkbox"/> No	_____
Material Handling / Crushing / Screening	<input checked="" type="checkbox"/> Yes <input type="checkbox"/> No	_____
Other Dust Source(s): _____	<input type="checkbox"/> Yes <input checked="" type="checkbox"/> No	_____

3. Best Management Practices (BMPs) Implemented

BMP / Control Measure	In Use Today	Comments / Location
Water Truck / Water Tower Application	<input checked="" type="checkbox"/> Yes <input type="checkbox"/> No	_____
Wind Breaks / Fencing	<input type="checkbox"/> Yes <input checked="" type="checkbox"/> No	_____
Gravel Pads / Track-Out Control	<input checked="" type="checkbox"/> Yes <input type="checkbox"/> No	_____
Stabilized Surfaces (Soil Binder, Mulch, etc.)	<input type="checkbox"/> Yes <input checked="" type="checkbox"/> No	_____
Reduced Vehicle Speeds (<15 mph)	<input checked="" type="checkbox"/> Yes <input type="checkbox"/> No	_____

Ceased Work Due to High Winds	<input type="checkbox"/> Yes <input type="checkbox"/> No	_____
Sweeping / Vacuuming Paved Areas	<input type="checkbox"/> Yes <input type="checkbox"/> No	_____
Covering of Haul Loads	<input type="checkbox"/> Yes <input type="checkbox"/> No	_____
Other Control(s): _____	<input type="checkbox"/> Yes <input type="checkbox"/> No	_____

4. Observations / Corrective Actions

Description	Action Taken / Recommended	Date / Time Completed
_____	_____	_____

5. Photos

_Insert photos below (document visible dust plumes, controls in place, or any observed deficiencies.)

Inspector Signature: Isaac Sandoval Date: 2/3/26

AIR QUALITY / DUST CONTROL INSPECTION FORM

Project / Site Name: Harlan Switch Station

Date: 2/4/26

Inspector: Isaac Sandoval

Time: 1030

1. Weather Conditions

Parameter	Observation
Temperature (°F)	See attached weather report
Wind Speed (mph)	See attached weather report
Wind Direction	See attached weather report
Humidity (%)	See attached weather report

Conditions: Calm Breezy Windy Gusty Other: _____

2. Dust-Producing Activities Observed

Activity	Active Today?	Notes / Area
Grading / Excavation	<input checked="" type="checkbox"/> Yes <input type="checkbox"/> No	_____
Scraping / Stockpiling	<input checked="" type="checkbox"/> Yes <input type="checkbox"/> No	_____
Loading / Hauling	<input type="checkbox"/> Yes <input checked="" type="checkbox"/> No	_____
Soil Compaction / Rolling	<input checked="" type="checkbox"/> Yes <input type="checkbox"/> No	_____
Trenching / Backfill	<input type="checkbox"/> Yes <input checked="" type="checkbox"/> No	_____
Vehicle Travel on Unpaved Roads	<input checked="" type="checkbox"/> Yes <input type="checkbox"/> No	_____
Material Handling / Crushing / Screening	<input checked="" type="checkbox"/> Yes <input type="checkbox"/> No	_____
Other Dust Source(s): _____	<input type="checkbox"/> Yes <input checked="" type="checkbox"/> No	_____

3. Best Management Practices (BMPs) Implemented

BMP / Control Measure	In Use Today	Comments / Location
Water Truck / Water Tower Application	<input checked="" type="checkbox"/> Yes <input type="checkbox"/> No	_____
Wind Breaks / Fencing	<input type="checkbox"/> Yes <input checked="" type="checkbox"/> No	_____
Gravel Pads / Track-Out Control	<input checked="" type="checkbox"/> Yes <input checked="" type="checkbox"/> No	_____
Stabilized Surfaces (Soil Binder, Mulch, etc.)	<input type="checkbox"/> Yes <input checked="" type="checkbox"/> No	_____
Reduced Vehicle Speeds (<15 mph)	<input checked="" type="checkbox"/> Yes <input type="checkbox"/> No	_____

Ceased Work Due to High Winds	<input type="checkbox"/> Yes <input type="checkbox"/> No	_____
Sweeping / Vacuuming Paved Areas	<input type="checkbox"/> Yes <input type="checkbox"/> No	_____
Covering of Haul Loads	<input type="checkbox"/> Yes <input type="checkbox"/> No	_____
Other Control(s): _____	<input type="checkbox"/> Yes <input type="checkbox"/> No	_____

4. Observations / Corrective Actions

Description	Action Taken / Recommended	Date / Time Completed
_____	_____	_____

5. Photos

_Insert photos below (document visible dust plumes, controls in place, or any observed deficiencies.)

Inspector Signature: Isaac Sandoval Date: 2/4/26

AIR QUALITY / DUST CONTROL INSPECTION FORM

Project / Site Name: Harlan Switch Station

Date: 2/5/26

Inspector: Isaac Sandoval

Time: 1030

1. Weather Conditions

Parameter	Observation
Temperature (°F)	See attached weather report
Wind Speed (mph)	See attached weather report
Wind Direction	See attached weather report
Humidity (%)	See attached weather report

Conditions: Calm Breezy Windy Gusty Other: _____

2. Dust-Producing Activities Observed

Activity	Active Today?	Notes / Area
Grading / Excavation	<input checked="" type="checkbox"/> Yes <input type="checkbox"/> No	_____
Scraping / Stockpiling	<input checked="" type="checkbox"/> Yes <input type="checkbox"/> No	_____
Loading / Hauling	<input type="checkbox"/> Yes <input checked="" type="checkbox"/> No	_____
Soil Compaction / Rolling	<input checked="" type="checkbox"/> Yes <input type="checkbox"/> No	_____
Trenching / Backfill	<input type="checkbox"/> Yes <input checked="" type="checkbox"/> No	_____
Vehicle Travel on Unpaved Roads	<input checked="" type="checkbox"/> Yes <input type="checkbox"/> No	_____
Material Handling / Crushing / Screening	<input checked="" type="checkbox"/> Yes <input type="checkbox"/> No	_____
Other Dust Source(s): _____	<input type="checkbox"/> Yes <input checked="" type="checkbox"/> No	_____

3. Best Management Practices (BMPs) Implemented

BMP / Control Measure	In Use Today	Comments / Location
Water Truck / Water Tower Application	<input checked="" type="checkbox"/> Yes <input type="checkbox"/> No	_____
Wind Breaks / Fencing	<input type="checkbox"/> Yes <input checked="" type="checkbox"/> No	_____
Gravel Pads / Track-Out Control	<input checked="" type="checkbox"/> Yes <input type="checkbox"/> No	_____
Stabilized Surfaces (Soil Binder, Mulch, etc.)	<input type="checkbox"/> Yes <input checked="" type="checkbox"/> No	_____
Reduced Vehicle Speeds (<15 mph)	<input checked="" type="checkbox"/> Yes <input type="checkbox"/> No	_____

Ceased Work Due to High Winds	<input type="checkbox"/> Yes <input type="checkbox"/> No	_____
Sweeping / Vacuuming Paved Areas	<input type="checkbox"/> Yes <input type="checkbox"/> No	_____
Covering of Haul Loads	<input type="checkbox"/> Yes <input type="checkbox"/> No	_____
Other Control(s): _____	<input type="checkbox"/> Yes <input type="checkbox"/> No	_____

4. Observations / Corrective Actions

Description	Action Taken / Recommended	Date / Time Completed
_____	_____	_____

5. Photos

_Insert photos below (document visible dust plumes, controls in place, or any observed deficiencies.)

Inspector Signature: Isaac Sandoval Date: 2/5/26

AIR QUALITY / DUST CONTROL INSPECTION FORM

Project / Site Name: Harlan Switch Station

Date: 2/6/26

Inspector: Isaac Sandoval

Time: 1030

1. Weather Conditions

Parameter	Observation
Temperature (°F)	See attached weather report
Wind Speed (mph)	See attached weather report
Wind Direction	See attached weather report
Humidity (%)	See attached weather report

Conditions: Calm Breezy Windy Gusty Other: _____

2. Dust-Producing Activities Observed

Activity	Active Today?	Notes / Area
Grading / Excavation	<input checked="" type="checkbox"/> Yes <input type="checkbox"/> No	_____
Scraping / Stockpiling	<input checked="" type="checkbox"/> Yes <input type="checkbox"/> No	_____
Loading / Hauling	<input type="checkbox"/> Yes <input checked="" type="checkbox"/> No	_____
Soil Compaction / Rolling	<input checked="" type="checkbox"/> Yes <input type="checkbox"/> No	_____
Trenching / Backfill	<input type="checkbox"/> Yes <input checked="" type="checkbox"/> No	_____
Vehicle Travel on Unpaved Roads	<input checked="" type="checkbox"/> Yes <input type="checkbox"/> No	_____
Material Handling / Crushing / Screening	<input checked="" type="checkbox"/> Yes <input type="checkbox"/> No	_____
Other Dust Source(s): _____	<input type="checkbox"/> Yes <input checked="" type="checkbox"/> No	_____

3. Best Management Practices (BMPs) Implemented

BMP / Control Measure	In Use Today	Comments / Location
Water Truck / Water Tower Application	<input checked="" type="checkbox"/> Yes <input type="checkbox"/> No	_____
Wind Breaks / Fencing	<input type="checkbox"/> Yes <input checked="" type="checkbox"/> No	_____
Gravel Pads / Track-Out Control	<input checked="" type="checkbox"/> Yes <input type="checkbox"/> No	_____
Stabilized Surfaces (Soil Binder, Mulch, etc.)	<input type="checkbox"/> Yes <input checked="" type="checkbox"/> No	_____
Reduced Vehicle Speeds (<15 mph)	<input checked="" type="checkbox"/> Yes <input type="checkbox"/> No	_____

Ceased Work Due to High Winds	<input type="checkbox"/> Yes <input type="checkbox"/> No	_____
Sweeping / Vacuuming Paved Areas	<input type="checkbox"/> Yes <input type="checkbox"/> No	_____
Covering of Haul Loads	<input type="checkbox"/> Yes <input type="checkbox"/> No	_____
Other Control(s): _____	<input type="checkbox"/> Yes <input type="checkbox"/> No	_____

4. Observations / Corrective Actions

Description	Action Taken / Recommended	Date / Time Completed
_____	_____	_____

5. Photos

_Insert photos below (document visible dust plumes, controls in place, or any observed deficiencies.)

Inspector Signature: Isaac Sandoval Date: 2/6/26

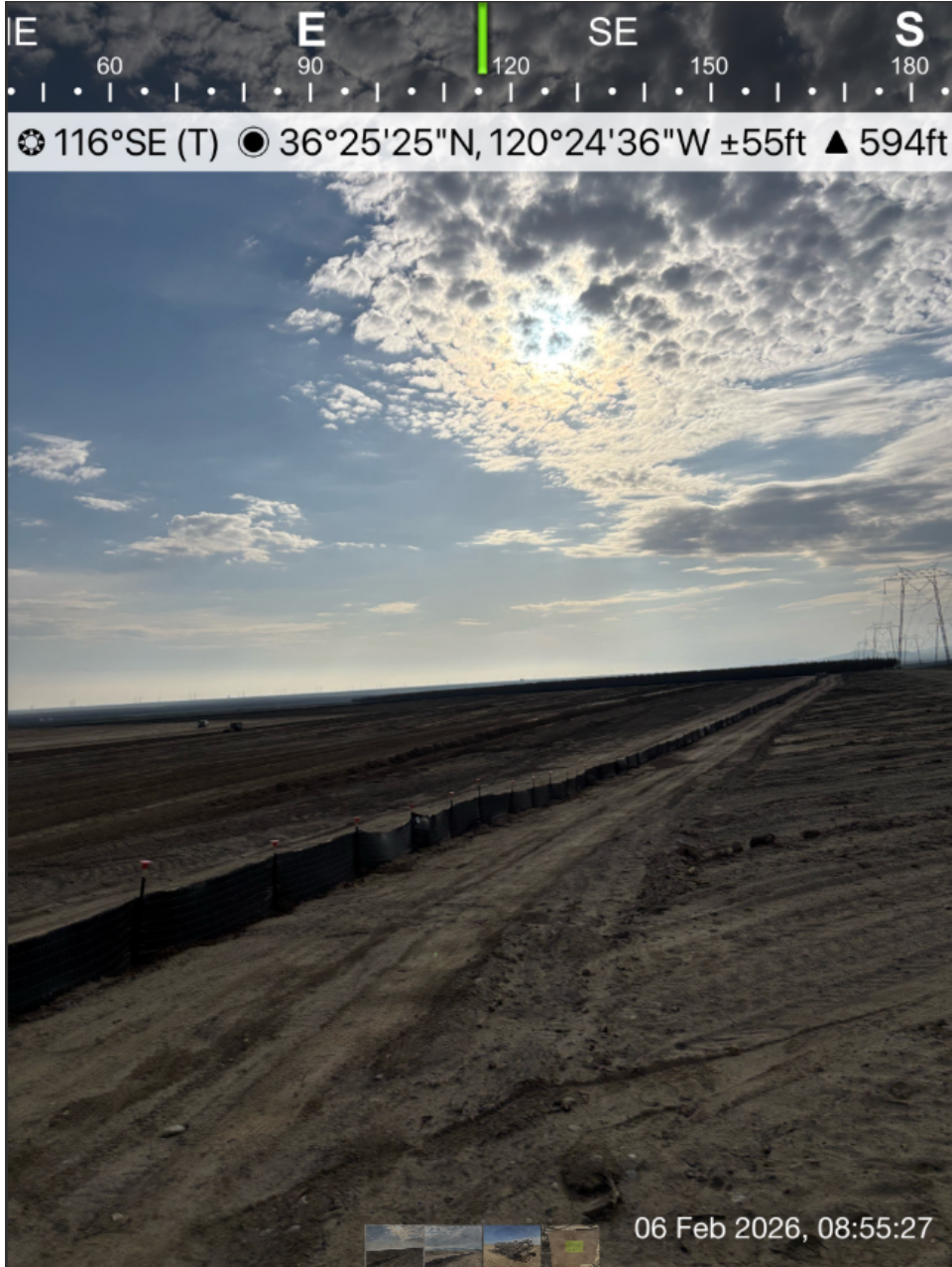



☉ 239°SW (T) ● 36°25'34"N, 120°24'33"W ±13ft ▲ 589ft



06 Feb 2026, 08:53:10

AIR QUALITY / DUST CONTROL INSPECTION FORM

Project / Site Name: Harlan Switch Station

Date: 2/7/26

Inspector: Isaac Sandoval

Time: 1030

1. Weather Conditions

Parameter	Observation
Temperature (°F)	See attached weather report
Wind Speed (mph)	See attached weather report
Wind Direction	See attached weather report
Humidity (%)	See attached weather report

Conditions: Calm Breezy Windy Gusty Other: _____

2. Dust-Producing Activities Observed

Activity	Active Today?	Notes / Area
Grading / Excavation	<input checked="" type="checkbox"/> Yes <input type="checkbox"/> No	_____
Scraping / Stockpiling	<input checked="" type="checkbox"/> Yes <input type="checkbox"/> No	_____
Loading / Hauling	<input type="checkbox"/> Yes <input checked="" type="checkbox"/> No	_____
Soil Compaction / Rolling	<input checked="" type="checkbox"/> Yes <input type="checkbox"/> No	_____
Trenching / Backfill	<input type="checkbox"/> Yes <input checked="" type="checkbox"/> No	_____
Vehicle Travel on Unpaved Roads	<input checked="" type="checkbox"/> Yes <input type="checkbox"/> No	_____
Material Handling / Crushing / Screening	<input checked="" type="checkbox"/> Yes <input type="checkbox"/> No	_____
Other Dust Source(s): _____	<input type="checkbox"/> Yes <input checked="" type="checkbox"/> No	_____

3. Best Management Practices (BMPs) Implemented

BMP / Control Measure	In Use Today	Comments / Location
Water Truck / Water Tower Application	<input checked="" type="checkbox"/> Yes <input type="checkbox"/> No	_____
Wind Breaks / Fencing	<input type="checkbox"/> Yes <input checked="" type="checkbox"/> No	_____
Gravel Pads / Track-Out Control	<input checked="" type="checkbox"/> Yes <input type="checkbox"/> No	_____
Stabilized Surfaces (Soil Binder, Mulch, etc.)	<input type="checkbox"/> Yes <input checked="" type="checkbox"/> No	_____
Reduced Vehicle Speeds (<15 mph)	<input checked="" type="checkbox"/> Yes <input type="checkbox"/> No	_____

Ceased Work Due to High Winds	<input type="checkbox"/> Yes <input type="checkbox"/> No	_____
Sweeping / Vacuuming Paved Areas	<input type="checkbox"/> Yes <input type="checkbox"/> No	_____
Covering of Haul Loads	<input type="checkbox"/> Yes <input type="checkbox"/> No	_____
Other Control(s): _____	<input type="checkbox"/> Yes <input type="checkbox"/> No	_____

4. Observations / Corrective Actions

Description	Action Taken / Recommended	Date / Time Completed
_____	_____	_____

5. Photos

_Insert photos below (document visible dust plumes, controls in place, or any observed deficiencies.)

Inspector Signature: Isaac Sandoval Date: 2/7/26

AIR QUALITY / DUST CONTROL INSPECTION FORM

Project / Site Name: Harlan Switch Station

Date: 2/09/26

Inspector: Isaac Sandoval

Time: 0800

1. Weather Conditions

Parameter	Observation
Temperature (°F)	See attached weather report
Wind Speed (mph)	See attached weather report
Wind Direction	See attached weather report
Humidity (%)	See attached weather report

Conditions: Calm Breezy Windy Gusty Other: _____

2. Dust-Producing Activities Observed

Activity	Active Today?	Notes / Area
Grading / Excavation	<input checked="" type="checkbox"/> Yes <input type="checkbox"/> No	_____
Scraping / Stockpiling	<input checked="" type="checkbox"/> Yes <input type="checkbox"/> No	_____
Loading / Hauling	<input type="checkbox"/> Yes <input checked="" type="checkbox"/> No	_____
Soil Compaction / Rolling	<input checked="" type="checkbox"/> Yes <input type="checkbox"/> No	_____
Trenching / Backfill	<input type="checkbox"/> Yes <input checked="" type="checkbox"/> No	_____
Vehicle Travel on Unpaved Roads	<input checked="" type="checkbox"/> Yes <input type="checkbox"/> No	_____
Material Handling / Crushing / Screening	<input checked="" type="checkbox"/> Yes <input type="checkbox"/> No	_____
Other Dust Source(s): _____	<input type="checkbox"/> Yes <input checked="" type="checkbox"/> No	_____

3. Best Management Practices (BMPs) Implemented

BMP / Control Measure	In Use Today	Comments / Location
Water Truck / Water Tower Application	<input checked="" type="checkbox"/> Yes <input type="checkbox"/> No	_____
Wind Breaks / Fencing	<input type="checkbox"/> Yes <input checked="" type="checkbox"/> No	_____
Gravel Pads / Track-Out Control	<input checked="" type="checkbox"/> Yes <input type="checkbox"/> No	_____
Stabilized Surfaces (Soil Binder, Mulch, etc.)	<input type="checkbox"/> Yes <input checked="" type="checkbox"/> No	_____
Reduced Vehicle Speeds (<15 mph)	<input checked="" type="checkbox"/> Yes <input type="checkbox"/> No	_____

Ceased Work Due to High Winds	<input type="checkbox"/> Yes <input type="checkbox"/> No	_____
Sweeping / Vacuuming Paved Areas	<input type="checkbox"/> Yes <input type="checkbox"/> No	_____
Covering of Haul Loads	<input type="checkbox"/> Yes <input type="checkbox"/> No	_____
Other Control(s): _____	<input type="checkbox"/> Yes <input type="checkbox"/> No	_____

4. Observations / Corrective Actions

Description	Action Taken / Recommended	Date / Time Completed
_____	_____	_____

5. Photos

_Insert photos below (document visible dust plumes, controls in place, or any observed deficiencies.)

Inspector Signature: Isaac Sandoval Date: 2/09/26

AIR QUALITY / DUST CONTROL INSPECTION FORM

Project / Site Name: Harlan Switch Station

Date: 2/10/26

Inspector: Isaac Sandoval

Time: 0800

1. Weather Conditions

Parameter	Observation
Temperature (°F)	See attached weather report
Wind Speed (mph)	See attached weather report
Wind Direction	See attached weather report
Humidity (%)	See attached weather report

Conditions: Calm Breezy Windy Gusty Other: _____

2. Dust-Producing Activities Observed

Activity	Active Today?	Notes / Area
Grading / Excavation	<input checked="" type="checkbox"/> Yes <input type="checkbox"/> No	_____
Scraping / Stockpiling	<input checked="" type="checkbox"/> Yes <input type="checkbox"/> No	_____
Loading / Hauling	<input type="checkbox"/> Yes <input checked="" type="checkbox"/> No	_____
Soil Compaction / Rolling	<input checked="" type="checkbox"/> Yes <input type="checkbox"/> No	_____
Trenching / Backfill	<input type="checkbox"/> Yes <input checked="" type="checkbox"/> No	_____
Vehicle Travel on Unpaved Roads	<input checked="" type="checkbox"/> Yes <input type="checkbox"/> No	_____
Material Handling / Crushing / Screening	<input checked="" type="checkbox"/> Yes <input type="checkbox"/> No	_____
Other Dust Source(s): _____	<input type="checkbox"/> Yes <input checked="" type="checkbox"/> No	_____

3. Best Management Practices (BMPs) Implemented

BMP / Control Measure	In Use Today	Comments / Location
Water Truck / Water Tower Application	<input checked="" type="checkbox"/> Yes <input type="checkbox"/> No	_____
Wind Breaks / Fencing	<input type="checkbox"/> Yes <input checked="" type="checkbox"/> No	_____
Gravel Pads / Track-Out Control	<input checked="" type="checkbox"/> Yes <input type="checkbox"/> No	_____
Stabilized Surfaces (Soil Binder, Mulch, etc.)	<input type="checkbox"/> Yes <input checked="" type="checkbox"/> No	_____
Reduced Vehicle Speeds (<15 mph)	<input checked="" type="checkbox"/> Yes <input type="checkbox"/> No	_____

Ceased Work Due to High Winds	<input type="checkbox"/> Yes <input type="checkbox"/> No	_____
Sweeping / Vacuuming Paved Areas	<input type="checkbox"/> Yes <input type="checkbox"/> No	_____
Covering of Haul Loads	<input type="checkbox"/> Yes <input type="checkbox"/> No	_____
Other Control(s): _____	<input type="checkbox"/> Yes <input type="checkbox"/> No	_____

4. Observations / Corrective Actions

Description	Action Taken / Recommended	Date / Time Completed
_____	_____	_____

5. Photos

_Insert photos below (document visible dust plumes, controls in place, or any observed deficiencies.)

Inspector Signature: Isaac Sandoval Date: 2/10/26

AIR QUALITY / DUST CONTROL INSPECTION FORM

Project / Site Name: Harlan Switch Station

Date: 2/11/26

Inspector: Isaac Sandoval

Time: 0900

1. Weather Conditions

Parameter	Observation
Temperature (°F)	See attached weather report
Wind Speed (mph)	See attached weather report
Wind Direction	See attached weather report
Humidity (%)	See attached weather report

Conditions: Calm Breezy Windy Gusty Other: _____

2. Dust-Producing Activities Observed

Activity	Active Today?	Notes / Area
Grading / Excavation	<input checked="" type="checkbox"/> Yes <input type="checkbox"/> No	_____
Scraping / Stockpiling	<input checked="" type="checkbox"/> Yes <input type="checkbox"/> No	_____
Loading / Hauling	<input type="checkbox"/> Yes <input checked="" type="checkbox"/> No	_____
Soil Compaction / Rolling	<input checked="" type="checkbox"/> Yes <input type="checkbox"/> No	_____
Trenching / Backfill	<input type="checkbox"/> Yes <input checked="" type="checkbox"/> No	_____
Vehicle Travel on Unpaved Roads	<input checked="" type="checkbox"/> Yes <input type="checkbox"/> No	_____
Material Handling / Crushing / Screening	<input checked="" type="checkbox"/> Yes <input type="checkbox"/> No	_____
Other Dust Source(s): _____	<input type="checkbox"/> Yes <input checked="" type="checkbox"/> No	_____

3. Best Management Practices (BMPs) Implemented

BMP / Control Measure	In Use Today	Comments / Location
Water Truck / Water Tower Application	<input checked="" type="checkbox"/> Yes <input type="checkbox"/> No	_____
Wind Breaks / Fencing	<input type="checkbox"/> Yes <input checked="" type="checkbox"/> No	_____
Gravel Pads / Track-Out Control	<input checked="" type="checkbox"/> Yes <input checked="" type="checkbox"/> No	_____
Stabilized Surfaces (Soil Binder, Mulch, etc.)	<input type="checkbox"/> Yes <input checked="" type="checkbox"/> No	_____
Reduced Vehicle Speeds (<15 mph)	<input checked="" type="checkbox"/> Yes <input type="checkbox"/> No	_____

Ceased Work Due to High Winds	<input type="checkbox"/> Yes <input type="checkbox"/> No	_____
Sweeping / Vacuuming Paved Areas	<input type="checkbox"/> Yes <input type="checkbox"/> No	_____
Covering of Haul Loads	<input type="checkbox"/> Yes <input type="checkbox"/> No	_____
Other Control(s): _____	<input type="checkbox"/> Yes <input type="checkbox"/> No	_____

4. Observations / Corrective Actions

Description	Action Taken / Recommended	Date / Time Completed
_____	_____	_____

5. Photos

_Insert photos below (document visible dust plumes, controls in place, or any observed deficiencies.)

Inspector Signature: Isaac Sandoval Date: 2/11/26

AIR QUALITY / DUST CONTROL INSPECTION FORM

Project / Site Name: Harlan Switch Station

Date: 2/12/26

Inspector: Isaac Sandoval

Time: 0900

1. Weather Conditions

Parameter	Observation
Temperature (°F)	See attached weather report
Wind Speed (mph)	See attached weather report
Wind Direction	See attached weather report
Humidity (%)	See attached weather report

Conditions: Calm Breezy Windy Gusty Other: _____

2. Dust-Producing Activities Observed

Activity	Active Today?	Notes / Area
Grading / Excavation	<input checked="" type="checkbox"/> Yes <input type="checkbox"/> No	_____
Scraping / Stockpiling	<input checked="" type="checkbox"/> Yes <input type="checkbox"/> No	_____
Loading / Hauling	<input type="checkbox"/> Yes <input checked="" type="checkbox"/> No	_____
Soil Compaction / Rolling	<input checked="" type="checkbox"/> Yes <input type="checkbox"/> No	_____
Trenching / Backfill	<input checked="" type="checkbox"/> Yes <input type="checkbox"/> No	_____
Vehicle Travel on Unpaved Roads	<input checked="" type="checkbox"/> Yes <input type="checkbox"/> No	_____
Material Handling / Crushing / Screening	<input checked="" type="checkbox"/> Yes <input type="checkbox"/> No	_____
Other Dust Source(s): _____	<input type="checkbox"/> Yes <input checked="" type="checkbox"/> No	_____

3. Best Management Practices (BMPs) Implemented

BMP / Control Measure	In Use Today	Comments / Location
Water Truck / Water Tower Application	<input checked="" type="checkbox"/> Yes <input type="checkbox"/> No	_____
Wind Breaks / Fencing	<input type="checkbox"/> Yes <input checked="" type="checkbox"/> No	_____
Gravel Pads / Track-Out Control	<input checked="" type="checkbox"/> Yes <input type="checkbox"/> No	_____
Stabilized Surfaces (Soil Binder, Mulch, etc.)	<input type="checkbox"/> Yes <input checked="" type="checkbox"/> No	_____
Reduced Vehicle Speeds (<15 mph)	<input checked="" type="checkbox"/> Yes <input type="checkbox"/> No	_____

Ceased Work Due to High Winds	<input type="checkbox"/> Yes <input type="checkbox"/> No	_____
Sweeping / Vacuuming Paved Areas	<input type="checkbox"/> Yes <input type="checkbox"/> No	_____
Covering of Haul Loads	<input type="checkbox"/> Yes <input type="checkbox"/> No	_____
Other Control(s): _____	<input type="checkbox"/> Yes <input type="checkbox"/> No	_____

4. Observations / Corrective Actions

Description	Action Taken / Recommended	Date / Time Completed
_____	_____	_____

5. Photos

_Insert photos below (document visible dust plumes, controls in place, or any observed deficiencies.)

Inspector Signature: Isaac Sandoval Date: 2/12/26

AIR QUALITY / DUST CONTROL INSPECTION FORM

Project / Site Name: Harlan Switch Station

Date: 2/13/26

Inspector: Isaac Sandoval

Time: 0900

1. Weather Conditions

Parameter	Observation
Temperature (°F)	See attached weather report
Wind Speed (mph)	See attached weather report
Wind Direction	See attached weather report
Humidity (%)	See attached weather report

Conditions: Calm Breezy Windy Gusty Other: _____

2. Dust-Producing Activities Observed

Activity	Active Today?	Notes / Area
Grading / Excavation	<input checked="" type="checkbox"/> Yes <input type="checkbox"/> No	_____
Scraping / Stockpiling	<input checked="" type="checkbox"/> Yes <input type="checkbox"/> No	_____
Loading / Hauling	<input type="checkbox"/> Yes <input checked="" type="checkbox"/> No	_____
Soil Compaction / Rolling	<input checked="" type="checkbox"/> Yes <input type="checkbox"/> No	_____
Trenching / Backfill	<input checked="" type="checkbox"/> Yes <input type="checkbox"/> No	_____
Vehicle Travel on Unpaved Roads	<input checked="" type="checkbox"/> Yes <input type="checkbox"/> No	_____
Material Handling / Crushing / Screening	<input checked="" type="checkbox"/> Yes <input type="checkbox"/> No	_____
Other Dust Source(s): _____	<input type="checkbox"/> Yes <input checked="" type="checkbox"/> No	_____

3. Best Management Practices (BMPs) Implemented

BMP / Control Measure	In Use Today	Comments / Location
Water Truck / Water Tower Application	<input checked="" type="checkbox"/> Yes <input type="checkbox"/> No	_____
Wind Breaks / Fencing	<input type="checkbox"/> Yes <input checked="" type="checkbox"/> No	_____
Gravel Pads / Track-Out Control	<input checked="" type="checkbox"/> Yes <input type="checkbox"/> No	_____
Stabilized Surfaces (Soil Binder, Mulch, etc.)	<input type="checkbox"/> Yes <input checked="" type="checkbox"/> No	_____
Reduced Vehicle Speeds (<15 mph)	<input checked="" type="checkbox"/> Yes <input type="checkbox"/> No	_____

Ceased Work Due to High Winds	<input type="checkbox"/> Yes <input type="checkbox"/> No	_____
Sweeping / Vacuuming Paved Areas	<input type="checkbox"/> Yes <input type="checkbox"/> No	_____
Covering of Haul Loads	<input type="checkbox"/> Yes <input type="checkbox"/> No	_____
Other Control(s): _____	<input type="checkbox"/> Yes <input type="checkbox"/> No	_____

4. Observations / Corrective Actions

Description	Action Taken / Recommended	Date / Time Completed
_____	_____	_____

5. Photos

_Insert photos below (document visible dust plumes, controls in place, or any observed deficiencies.)

Inspector Signature: Isaac Sandoval Date: 2/13/26

AIR QUALITY / DUST CONTROL INSPECTION FORM

Project / Site Name: Harlan Switch Station

Date: 2/14/26

Inspector: Isaac Sandoval

Time: 0900

1. Weather Conditions

Parameter	Observation
Temperature (°F)	See attached weather report
Wind Speed (mph)	See attached weather report
Wind Direction	See attached weather report
Humidity (%)	See attached weather report

Conditions: Calm Breezy Windy Gusty Other: _____

2. Dust-Producing Activities Observed

Activity	Active Today?	Notes / Area
Grading / Excavation	<input checked="" type="checkbox"/> Yes <input type="checkbox"/> No	_____
Scraping / Stockpiling	<input checked="" type="checkbox"/> Yes <input type="checkbox"/> No	_____
Loading / Hauling	<input type="checkbox"/> Yes <input checked="" type="checkbox"/> No	_____
Soil Compaction / Rolling	<input checked="" type="checkbox"/> Yes <input type="checkbox"/> No	_____
Trenching / Backfill	<input checked="" type="checkbox"/> Yes <input type="checkbox"/> No	_____
Vehicle Travel on Unpaved Roads	<input checked="" type="checkbox"/> Yes <input type="checkbox"/> No	_____
Material Handling / Crushing / Screening	<input checked="" type="checkbox"/> Yes <input type="checkbox"/> No	_____
Other Dust Source(s): _____	<input type="checkbox"/> Yes <input checked="" type="checkbox"/> No	_____

3. Best Management Practices (BMPs) Implemented

BMP / Control Measure	In Use Today	Comments / Location
Water Truck / Water Tower Application	<input checked="" type="checkbox"/> Yes <input type="checkbox"/> No	_____
Wind Breaks / Fencing	<input type="checkbox"/> Yes <input checked="" type="checkbox"/> No	_____
Gravel Pads / Track-Out Control	<input checked="" type="checkbox"/> Yes <input checked="" type="checkbox"/> No	_____
Stabilized Surfaces (Soil Binder, Mulch, etc.)	<input type="checkbox"/> Yes <input checked="" type="checkbox"/> No	_____
Reduced Vehicle Speeds (<15 mph)	<input checked="" type="checkbox"/> Yes <input type="checkbox"/> No	_____

Ceased Work Due to High Winds	<input type="checkbox"/> Yes <input type="checkbox"/> No	_____
Sweeping / Vacuuming Paved Areas	<input type="checkbox"/> Yes <input type="checkbox"/> No	_____
Covering of Haul Loads	<input type="checkbox"/> Yes <input type="checkbox"/> No	_____
Other Control(s): _____	<input type="checkbox"/> Yes <input type="checkbox"/> No	_____

4. Observations / Corrective Actions

Description	Action Taken / Recommended	Date / Time Completed
_____	_____	_____

5. Photos

_Insert photos below (document visible dust plumes, controls in place, or any observed deficiencies.)

Inspector Signature: Isaac Sandoval Date: 2/14/26

AIR QUALITY / DUST CONTROL INSPECTION FORM

Project / Site Name: Harlan Switch Station

Date: 2/18/26

Inspector: Isaac Sandoval

Time: 0900

1. Weather Conditions

Parameter	Observation
Temperature (°F)	See attached weather report
Wind Speed (mph)	See attached weather report
Wind Direction	See attached weather report
Humidity (%)	See attached weather report

Conditions: Calm Breezy Windy Gusty Other: _____

2. Dust-Producing Activities Observed

Activity	Active Today?	Notes / Area
Grading / Excavation	<input checked="" type="checkbox"/> Yes <input type="checkbox"/> No	_____
Scraping / Stockpiling	<input checked="" type="checkbox"/> Yes <input type="checkbox"/> No	_____
Loading / Hauling	<input type="checkbox"/> Yes <input checked="" type="checkbox"/> No	_____
Soil Compaction / Rolling	<input checked="" type="checkbox"/> Yes <input type="checkbox"/> No	_____
Trenching / Backfill	<input checked="" type="checkbox"/> Yes <input type="checkbox"/> No	_____
Vehicle Travel on Unpaved Roads	<input checked="" type="checkbox"/> Yes <input type="checkbox"/> No	_____
Material Handling / Crushing / Screening	<input checked="" type="checkbox"/> Yes <input type="checkbox"/> No	_____
Other Dust Source(s): _____	<input type="checkbox"/> Yes <input checked="" type="checkbox"/> No	_____

3. Best Management Practices (BMPs) Implemented

BMP / Control Measure	In Use Today	Comments / Location
Water Truck / Water Tower Application	<input checked="" type="checkbox"/> Yes <input type="checkbox"/> No	_____
Wind Breaks / Fencing	<input type="checkbox"/> Yes <input checked="" type="checkbox"/> No	_____
Gravel Pads / Track-Out Control	<input checked="" type="checkbox"/> Yes <input checked="" type="checkbox"/> No	_____
Stabilized Surfaces (Soil Binder, Mulch, etc.)	<input type="checkbox"/> Yes <input checked="" type="checkbox"/> No	_____
Reduced Vehicle Speeds (<15 mph)	<input checked="" type="checkbox"/> Yes <input type="checkbox"/> No	_____

Ceased Work Due to High Winds	<input type="checkbox"/> Yes <input type="checkbox"/> No	_____
Sweeping / Vacuuming Paved Areas	<input type="checkbox"/> Yes <input type="checkbox"/> No	_____
Covering of Haul Loads	<input type="checkbox"/> Yes <input type="checkbox"/> No	_____
Other Control(s): _____	<input type="checkbox"/> Yes <input type="checkbox"/> No	_____

4. Observations / Corrective Actions

Description	Action Taken / Recommended	Date / Time Completed
_____	_____	_____

5. Photos

_Insert photos below (document visible dust plumes, controls in place, or any observed deficiencies.)

Inspector Signature: Isaac Sandoval Date: 2/18/26

W

270

NW

300

330

N

0

☀ 318°NW (T) ● 36°25'40"N, 120°24'35"W ±45ft ▲ 584ft



18 Feb 2026, 08:48:21

SW

240

W

270

NW

300

330

☉ 288°W (T) ☉ 36°25'40"N, 120°24'35"W ±13ft ▲ 583ft



18 Feb 2026, 08:48:15

AIR QUALITY / DUST CONTROL INSPECTION FORM

Project / Site Name: Harlan Switch Station

Date: 2/19/26

Inspector: Isaac Sandoval

Time: 0900

1. Weather Conditions

Parameter	Observation
Temperature (°F)	See attached weather report
Wind Speed (mph)	See attached weather report
Wind Direction	See attached weather report
Humidity (%)	See attached weather report

Conditions: Calm Breezy Windy Gusty Other: _____

2. Dust-Producing Activities Observed

Activity	Active Today?	Notes / Area
Grading / Excavation	<input type="checkbox"/> Yes <input checked="" type="checkbox"/> No	_____
Scraping / Stockpiling	<input type="checkbox"/> Yes <input checked="" type="checkbox"/> No	_____
Loading / Hauling	<input type="checkbox"/> Yes <input checked="" type="checkbox"/> No	_____
Soil Compaction / Rolling	<input type="checkbox"/> Yes <input checked="" type="checkbox"/> No	_____
Trenching / Backfill	<input type="checkbox"/> Yes <input checked="" type="checkbox"/> No	_____
Vehicle Travel on Unpaved Roads	<input checked="" type="checkbox"/> Yes <input type="checkbox"/> No	_____
Material Handling / Crushing / Screening	<input type="checkbox"/> Yes <input checked="" type="checkbox"/> No	_____
Other Dust Source(s): _____	<input type="checkbox"/> Yes <input checked="" type="checkbox"/> No	_____

3. Best Management Practices (BMPs) Implemented

BMP / Control Measure	In Use Today	Comments / Location
Water Truck / Water Tower Application	<input checked="" type="checkbox"/> Yes <input checked="" type="checkbox"/> No	_____
Wind Breaks / Fencing	<input type="checkbox"/> Yes <input checked="" type="checkbox"/> No	_____
Gravel Pads / Track-Out Control	<input checked="" type="checkbox"/> Yes <input checked="" type="checkbox"/> No	_____
Stabilized Surfaces (Soil Binder, Mulch, etc.)	<input type="checkbox"/> Yes <input checked="" type="checkbox"/> No	_____
Reduced Vehicle Speeds (<15 mph)	<input checked="" type="checkbox"/> Yes <input type="checkbox"/> No	_____

Ceased Work Due to High Winds	<input type="checkbox"/> Yes <input type="checkbox"/> No	_____
Sweeping / Vacuuming Paved Areas	<input type="checkbox"/> Yes <input type="checkbox"/> No	_____
Covering of Haul Loads	<input type="checkbox"/> Yes <input type="checkbox"/> No	_____
Other Control(s): _____	<input type="checkbox"/> Yes <input type="checkbox"/> No	_____

4. Observations / Corrective Actions

Description	Action Taken / Recommended	Date / Time Completed
_____	_____	_____

5. Photos

_Insert photos below (document visible dust plumes, controls in place, or any observed deficiencies.)

Inspector Signature: Isaac Sandoval Date: 2/19/26

AIR QUALITY / DUST CONTROL INSPECTION FORM

Project / Site Name: Harlan Switch Station

Date: 2/20/26

Inspector: Julian Robertson

Time: 0900

1. Weather Conditions

Parameter	Observation
Temperature (°F)	See attached weather report
Wind Speed (mph)	See attached weather report
Wind Direction	See attached weather report
Humidity (%)	See attached weather report

Conditions: Calm Breezy Windy Gusty Other: _____

2. Dust-Producing Activities Observed

Activity	Active Today?	Notes / Area
Grading / Excavation	<input type="checkbox"/> Yes <input checked="" type="checkbox"/> No	_____
Scraping / Stockpiling	<input type="checkbox"/> Yes <input checked="" type="checkbox"/> No	_____
Loading / Hauling	<input type="checkbox"/> Yes <input checked="" type="checkbox"/> No	_____
Soil Compaction / Rolling	<input type="checkbox"/> Yes <input checked="" type="checkbox"/> No	_____
Trenching / Backfill	<input type="checkbox"/> Yes <input checked="" type="checkbox"/> No	_____
Vehicle Travel on Unpaved Roads	<input checked="" type="checkbox"/> Yes <input type="checkbox"/> No	_____
Material Handling / Crushing / Screening	<input type="checkbox"/> Yes <input checked="" type="checkbox"/> No	_____
Other Dust Source(s): _____	<input type="checkbox"/> Yes <input checked="" type="checkbox"/> No	_____

3. Best Management Practices (BMPs) Implemented

BMP / Control Measure	In Use Today	Comments / Location
Water Truck / Water Tower Application	<input checked="" type="checkbox"/> Yes <input checked="" type="checkbox"/> No	_____
Wind Breaks / Fencing	<input type="checkbox"/> Yes <input checked="" type="checkbox"/> No	_____
Gravel Pads / Track-Out Control	<input checked="" type="checkbox"/> Yes <input checked="" type="checkbox"/> No	_____
Stabilized Surfaces (Soil Binder, Mulch, etc.)	<input type="checkbox"/> Yes <input checked="" type="checkbox"/> No	_____
Reduced Vehicle Speeds (<15 mph)	<input checked="" type="checkbox"/> Yes <input type="checkbox"/> No	_____

Ceased Work Due to High Winds	<input type="checkbox"/> Yes <input type="checkbox"/> No	_____
Sweeping / Vacuuming Paved Areas	<input type="checkbox"/> Yes <input type="checkbox"/> No	_____
Covering of Haul Loads	<input type="checkbox"/> Yes <input type="checkbox"/> No	_____
Other Control(s): _____	<input type="checkbox"/> Yes <input type="checkbox"/> No	_____

4. Observations / Corrective Actions

Description	Action Taken / Recommended	Date / Time Completed
_____	_____	_____

5. Photos

_Insert photos below (document visible dust plumes, controls in place, or any observed deficiencies.)

Inspector Signature: Julian Robertson Isaac Sandoval Date: 2/20/26

AIR QUALITY / DUST CONTROL INSPECTION FORM

Project / Site Name: Harlan Switch Station

Date: 2/21/26

Inspector: Julian Robertson

Time: 0900

1. Weather Conditions

Parameter	Observation
Temperature (°F)	See attached weather report
Wind Speed (mph)	See attached weather report
Wind Direction	See attached weather report
Humidity (%)	See attached weather report

Conditions: Calm Breezy Windy Gusty Other: _____

2. Dust-Producing Activities Observed

Activity	Active Today?	Notes / Area
Grading / Excavation	<input type="checkbox"/> Yes <input checked="" type="checkbox"/> No	_____
Scraping / Stockpiling	<input type="checkbox"/> Yes <input checked="" type="checkbox"/> No	_____
Loading / Hauling	<input type="checkbox"/> Yes <input checked="" type="checkbox"/> No	_____
Soil Compaction / Rolling	<input type="checkbox"/> Yes <input checked="" type="checkbox"/> No	_____
Trenching / Backfill	<input type="checkbox"/> Yes <input checked="" type="checkbox"/> No	_____
Vehicle Travel on Unpaved Roads	<input checked="" type="checkbox"/> Yes <input type="checkbox"/> No	_____
Material Handling / Crushing / Screening	<input type="checkbox"/> Yes <input checked="" type="checkbox"/> No	_____
Other Dust Source(s): _____	<input type="checkbox"/> Yes <input checked="" type="checkbox"/> No	_____

3. Best Management Practices (BMPs) Implemented

BMP / Control Measure	In Use Today	Comments / Location
Water Truck / Water Tower Application	<input checked="" type="checkbox"/> Yes <input checked="" type="checkbox"/> No	_____
Wind Breaks / Fencing	<input type="checkbox"/> Yes <input checked="" type="checkbox"/> No	_____
Gravel Pads / Track-Out Control	<input checked="" type="checkbox"/> Yes <input checked="" type="checkbox"/> No	_____
Stabilized Surfaces (Soil Binder, Mulch, etc.)	<input type="checkbox"/> Yes <input checked="" type="checkbox"/> No	_____
Reduced Vehicle Speeds (<15 mph)	<input checked="" type="checkbox"/> Yes <input type="checkbox"/> No	_____

Ceased Work Due to High Winds	<input type="checkbox"/> Yes <input type="checkbox"/> No	_____
Sweeping / Vacuuming Paved Areas	<input type="checkbox"/> Yes <input type="checkbox"/> No	_____
Covering of Haul Loads	<input type="checkbox"/> Yes <input type="checkbox"/> No	_____
Other Control(s): _____	<input type="checkbox"/> Yes <input type="checkbox"/> No	_____

4. Observations / Corrective Actions

Description	Action Taken / Recommended	Date / Time Completed
_____	_____	_____

5. Photos

_Insert photos below (document visible dust plumes, controls in place, or any observed deficiencies.)

Inspector Signature: Julian Robertson Isaac Sandoval Date: 2/21/26

AIR QUALITY / DUST CONTROL INSPECTION FORM

Project / Site Name: Harlan Switch Station

Date: 2/23/26

Inspector: Isaac Sandoval

Time: 0900

1. Weather Conditions

Parameter	Observation
Temperature (°F)	See attached weather report
Wind Speed (mph)	See attached weather report
Wind Direction	See attached weather report
Humidity (%)	See attached weather report

Conditions: Calm Breezy Windy Gusty Other: _____

2. Dust-Producing Activities Observed

Activity	Active Today?	Notes / Area
Grading / Excavation	<input type="checkbox"/> Yes <input checked="" type="checkbox"/> No	_____
Scraping / Stockpiling	<input type="checkbox"/> Yes <input checked="" type="checkbox"/> No	_____
Loading / Hauling	<input type="checkbox"/> Yes <input checked="" type="checkbox"/> No	_____
Soil Compaction / Rolling	<input type="checkbox"/> Yes <input checked="" type="checkbox"/> No	_____
Trenching / Backfill	<input type="checkbox"/> Yes <input checked="" type="checkbox"/> No	_____
Vehicle Travel on Unpaved Roads	<input checked="" type="checkbox"/> Yes <input type="checkbox"/> No	_____
Material Handling / Crushing / Screening	<input type="checkbox"/> Yes <input checked="" type="checkbox"/> No	_____
Other Dust Source(s): _____	<input type="checkbox"/> Yes <input checked="" type="checkbox"/> No	_____

3. Best Management Practices (BMPs) Implemented

BMP / Control Measure	In Use Today	Comments / Location
Water Truck / Water Tower Application	<input checked="" type="checkbox"/> Yes <input checked="" type="checkbox"/> No	_____
Wind Breaks / Fencing	<input type="checkbox"/> Yes <input checked="" type="checkbox"/> No	_____
Gravel Pads / Track-Out Control	<input checked="" type="checkbox"/> Yes <input checked="" type="checkbox"/> No	_____
Stabilized Surfaces (Soil Binder, Mulch, etc.)	<input type="checkbox"/> Yes <input checked="" type="checkbox"/> No	_____
Reduced Vehicle Speeds (<15 mph)	<input checked="" type="checkbox"/> Yes <input type="checkbox"/> No	_____

Ceased Work Due to High Winds	<input type="checkbox"/> Yes <input type="checkbox"/> No	_____
Sweeping / Vacuuming Paved Areas	<input type="checkbox"/> Yes <input type="checkbox"/> No	_____
Covering of Haul Loads	<input type="checkbox"/> Yes <input type="checkbox"/> No	_____
Other Control(s): _____	<input type="checkbox"/> Yes <input type="checkbox"/> No	_____

4. Observations / Corrective Actions

Description	Action Taken / Recommended	Date / Time Completed
_____	_____	_____

5. Photos

_Insert photos below (document visible dust plumes, controls in place, or any observed deficiencies.)

Inspector Signature: Isaac Sandoval Date: 2/23/26

AIR QUALITY / DUST CONTROL INSPECTION FORM

Project / Site Name: Harlan Switch Station

Date: 2/24/26

Inspector: Isaac Sandoval

Time: 0900

1. Weather Conditions

Parameter	Observation
Temperature (°F)	See attached weather report
Wind Speed (mph)	See attached weather report
Wind Direction	See attached weather report
Humidity (%)	See attached weather report

Conditions: Calm Breezy Windy Gusty Other: _____

2. Dust-Producing Activities Observed

Activity	Active Today?	Notes / Area
Grading / Excavation	<input type="checkbox"/> Yes <input checked="" type="checkbox"/> No	_____
Scraping / Stockpiling	<input type="checkbox"/> Yes <input checked="" type="checkbox"/> No	_____
Loading / Hauling	<input type="checkbox"/> Yes <input checked="" type="checkbox"/> No	_____
Soil Compaction / Rolling	<input type="checkbox"/> Yes <input checked="" type="checkbox"/> No	_____
Trenching / Backfill	<input type="checkbox"/> Yes <input checked="" type="checkbox"/> No	_____
Vehicle Travel on Unpaved Roads	<input checked="" type="checkbox"/> Yes <input type="checkbox"/> No	_____
Material Handling / Crushing / Screening	<input type="checkbox"/> Yes <input checked="" type="checkbox"/> No	_____
Other Dust Source(s): _____	<input type="checkbox"/> Yes <input checked="" type="checkbox"/> No	_____

3. Best Management Practices (BMPs) Implemented

BMP / Control Measure	In Use Today	Comments / Location
Water Truck / Water Tower Application	<input checked="" type="checkbox"/> Yes <input checked="" type="checkbox"/> No	_____
Wind Breaks / Fencing	<input type="checkbox"/> Yes <input checked="" type="checkbox"/> No	_____
Gravel Pads / Track-Out Control	<input checked="" type="checkbox"/> Yes <input checked="" type="checkbox"/> No	_____
Stabilized Surfaces (Soil Binder, Mulch, etc.)	<input type="checkbox"/> Yes <input checked="" type="checkbox"/> No	_____
Reduced Vehicle Speeds (<15 mph)	<input checked="" type="checkbox"/> Yes <input type="checkbox"/> No	_____

Ceased Work Due to High Winds	<input type="checkbox"/> Yes <input type="checkbox"/> No	_____
Sweeping / Vacuuming Paved Areas	<input type="checkbox"/> Yes <input type="checkbox"/> No	_____
Covering of Haul Loads	<input type="checkbox"/> Yes <input type="checkbox"/> No	_____
Other Control(s): _____	<input type="checkbox"/> Yes <input type="checkbox"/> No	_____

4. Observations / Corrective Actions

Description	Action Taken / Recommended	Date / Time Completed
_____	_____	_____

5. Photos

_Insert photos below (document visible dust plumes, controls in place, or any observed deficiencies.)

Inspector Signature: Isaac Sandoval Date: 2/24/26

AIR QUALITY / DUST CONTROL INSPECTION FORM

Project / Site Name: Harlan Switch Station

Date: 2/25/26

Inspector: Isaac Sandoval

Time: 0900

1. Weather Conditions

Parameter	Observation
Temperature (°F)	See attached weather report
Wind Speed (mph)	See attached weather report
Wind Direction	See attached weather report
Humidity (%)	See attached weather report

Conditions: Calm Breezy Windy Gusty Other: _____

2. Dust-Producing Activities Observed

Activity	Active Today?	Notes / Area
Grading / Excavation	<input checked="" type="checkbox"/> Yes <input type="checkbox"/> No	_____
Scraping / Stockpiling	<input checked="" type="checkbox"/> Yes <input type="checkbox"/> No	_____
Loading / Hauling	<input checked="" type="checkbox"/> Yes <input type="checkbox"/> No	_____
Soil Compaction / Rolling	<input checked="" type="checkbox"/> Yes <input type="checkbox"/> No	_____
Trenching / Backfill	<input type="checkbox"/> Yes <input checked="" type="checkbox"/> No	_____
Vehicle Travel on Unpaved Roads	<input checked="" type="checkbox"/> Yes <input type="checkbox"/> No	_____
Material Handling / Crushing / Screening	<input type="checkbox"/> Yes <input checked="" type="checkbox"/> No	_____
Other Dust Source(s): _____	<input type="checkbox"/> Yes <input checked="" type="checkbox"/> No	_____

3. Best Management Practices (BMPs) Implemented

BMP / Control Measure	In Use Today	Comments / Location
Water Truck / Water Tower Application	<input checked="" type="checkbox"/> Yes <input type="checkbox"/> No	_____
Wind Breaks / Fencing	<input type="checkbox"/> Yes <input checked="" type="checkbox"/> No	_____
Gravel Pads / Track-Out Control	<input checked="" type="checkbox"/> Yes <input checked="" type="checkbox"/> No	_____
Stabilized Surfaces (Soil Binder, Mulch, etc.)	<input type="checkbox"/> Yes <input checked="" type="checkbox"/> No	_____
Reduced Vehicle Speeds (<15 mph)	<input checked="" type="checkbox"/> Yes <input type="checkbox"/> No	_____

Ceased Work Due to High Winds	<input type="checkbox"/> Yes <input type="checkbox"/> No	_____
Sweeping / Vacuuming Paved Areas	<input type="checkbox"/> Yes <input type="checkbox"/> No	_____
Covering of Haul Loads	<input type="checkbox"/> Yes <input type="checkbox"/> No	_____
Other Control(s): _____	<input type="checkbox"/> Yes <input type="checkbox"/> No	_____

4. Observations / Corrective Actions

Description	Action Taken / Recommended	Date / Time Completed
_____	_____	_____

5. Photos

_Insert photos below (document visible dust plumes, controls in place, or any observed deficiencies.)

Inspector Signature: Isaac Sandoval Date: 2/25/26

AIR QUALITY / DUST CONTROL INSPECTION FORM

Project / Site Name: Harlan Switch Station

Date: 2/26/26

Inspector: Isaac Sandoval

Time: 0900

1. Weather Conditions

Parameter	Observation
Temperature (°F)	See attached weather report
Wind Speed (mph)	See attached weather report
Wind Direction	See attached weather report
Humidity (%)	See attached weather report

Conditions: Calm Breezy Windy Gusty Other: _____

2. Dust-Producing Activities Observed

Activity	Active Today?	Notes / Area
Grading / Excavation	<input checked="" type="checkbox"/> Yes <input type="checkbox"/> No	_____
Scraping / Stockpiling	<input checked="" type="checkbox"/> Yes <input type="checkbox"/> No	_____
Loading / Hauling	<input type="checkbox"/> Yes <input checked="" type="checkbox"/> No	_____
Soil Compaction / Rolling	<input checked="" type="checkbox"/> Yes <input type="checkbox"/> No	_____
Trenching / Backfill	<input checked="" type="checkbox"/> Yes <input type="checkbox"/> No	_____
Vehicle Travel on Unpaved Roads	<input checked="" type="checkbox"/> Yes <input type="checkbox"/> No	_____
Material Handling / Crushing / Screening	<input type="checkbox"/> Yes <input checked="" type="checkbox"/> No	_____
Other Dust Source(s): _____	<input type="checkbox"/> Yes <input checked="" type="checkbox"/> No	_____

3. Best Management Practices (BMPs) Implemented

BMP / Control Measure	In Use Today	Comments / Location
Water Truck / Water Tower Application	<input checked="" type="checkbox"/> Yes <input type="checkbox"/> No	_____
Wind Breaks / Fencing	<input type="checkbox"/> Yes <input checked="" type="checkbox"/> No	_____
Gravel Pads / Track-Out Control	<input checked="" type="checkbox"/> Yes <input type="checkbox"/> No	_____
Stabilized Surfaces (Soil Binder, Mulch, etc.)	<input type="checkbox"/> Yes <input checked="" type="checkbox"/> No	_____
Reduced Vehicle Speeds (<15 mph)	<input checked="" type="checkbox"/> Yes <input type="checkbox"/> No	_____

Ceased Work Due to High Winds	<input type="checkbox"/> Yes <input type="checkbox"/> No	_____
Sweeping / Vacuuming Paved Areas	<input type="checkbox"/> Yes <input type="checkbox"/> No	_____
Covering of Haul Loads	<input type="checkbox"/> Yes <input type="checkbox"/> No	_____
Other Control(s): _____	<input type="checkbox"/> Yes <input type="checkbox"/> No	_____

4. Observations / Corrective Actions

Description	Action Taken / Recommended	Date / Time Completed
_____	_____	_____

5. Photos

_Insert photos below (document visible dust plumes, controls in place, or any observed deficiencies.)

Inspector Signature: Isaac Sandoval Date: 2/26/26

AIR QUALITY / DUST CONTROL INSPECTION FORM

Project / Site Name: Harlan Switch Station

Date: 2/27/26

Inspector: Isaac Sandoval

Time: 0900

1. Weather Conditions

Parameter	Observation
Temperature (°F)	See attached weather report
Wind Speed (mph)	See attached weather report
Wind Direction	See attached weather report
Humidity (%)	See attached weather report

Conditions: Calm Breezy Windy Gusty Other: _____

2. Dust-Producing Activities Observed

Activity	Active Today?	Notes / Area
Grading / Excavation	<input checked="" type="checkbox"/> Yes <input type="checkbox"/> No	_____
Scraping / Stockpiling	<input checked="" type="checkbox"/> Yes <input type="checkbox"/> No	_____
Loading / Hauling	<input type="checkbox"/> Yes <input checked="" type="checkbox"/> No	_____
Soil Compaction / Rolling	<input checked="" type="checkbox"/> Yes <input type="checkbox"/> No	_____
Trenching / Backfill	<input checked="" type="checkbox"/> Yes <input type="checkbox"/> No	_____
Vehicle Travel on Unpaved Roads	<input checked="" type="checkbox"/> Yes <input type="checkbox"/> No	_____
Material Handling / Crushing / Screening	<input type="checkbox"/> Yes <input checked="" type="checkbox"/> No	_____
Other Dust Source(s): _____	<input type="checkbox"/> Yes <input checked="" type="checkbox"/> No	_____

3. Best Management Practices (BMPs) Implemented

BMP / Control Measure	In Use Today	Comments / Location
Water Truck / Water Tower Application	<input checked="" type="checkbox"/> Yes <input type="checkbox"/> No	_____
Wind Breaks / Fencing	<input type="checkbox"/> Yes <input checked="" type="checkbox"/> No	_____
Gravel Pads / Track-Out Control	<input checked="" type="checkbox"/> Yes <input checked="" type="checkbox"/> No	_____
Stabilized Surfaces (Soil Binder, Mulch, etc.)	<input type="checkbox"/> Yes <input checked="" type="checkbox"/> No	_____
Reduced Vehicle Speeds (<15 mph)	<input checked="" type="checkbox"/> Yes <input type="checkbox"/> No	_____

Ceased Work Due to High Winds	<input type="checkbox"/> Yes <input type="checkbox"/> No	_____
Sweeping / Vacuuming Paved Areas	<input type="checkbox"/> Yes <input type="checkbox"/> No	_____
Covering of Haul Loads	<input type="checkbox"/> Yes <input type="checkbox"/> No	_____
Other Control(s): _____	<input type="checkbox"/> Yes <input type="checkbox"/> No	_____

4. Observations / Corrective Actions

Description	Action Taken / Recommended	Date / Time Completed
_____	_____	_____

5. Photos

_Insert photos below (document visible dust plumes, controls in place, or any observed deficiencies.)

Inspector Signature: Isaac Sandoval Date: 2/27/26

SWITCH-GHG-01

1. AQSC-05: SUMMARY OF ACTIONS TAKEN TO MAINTAIN COMPLIANCE WITH THIS CONDITION

To reduce greenhouse gas emissions associated with construction activities, the project team has implemented a suite of operational controls and workforce practices aimed at minimizing fuel consumption and unnecessary equipment use. Workers are encouraged to carpool whenever feasible, with carpooling opportunities discussed during morning safety briefings and supported by strategically organized parking and staging areas that streamline ride-sharing logistics.

The project enforces a strict no-idling policy in accordance with California Title 13, Section 2485, which prohibits idling beyond five minutes. Crews are routinely reminded of this requirement and of the project's common-sense vehicle-use expectations, both during daily briefings and in pre-construction safety meetings. Construction equipment is staged efficiently throughout the site to reduce idle time during mobilization and sequencing of work. Additionally, all construction equipment is maintained per PG&E standards, ensuring optimal engine performance and reducing avoidable fuel burn.

As part of the project's greenhouse gas mitigation approach, a detailed equipment emissions log is being maintained. This log documents equipment make, model, usage category, and run time for each reporting period. Maintaining an accurate emissions dataset is essential for tracking fuel use, evaluating opportunities for efficiency improvements, and ensuring transparent reporting to the California Energy Commission (CEC). It also supports statewide carbon-reduction initiatives by enabling data-driven verification that construction activities remain consistent with California's greenhouse gas reduction targets under AB 32, SB 32, and CEC Conditions of Certification related to air quality and GHG performance.

Collectively, these measures reflect the project's proactive commitment to minimizing GHG emissions through responsible equipment operation, regulatory compliance, and continuous monitoring that aligns with the State of California's long-term climate and emissions-reduction goals.

SWITCH-GHG-01

2. AQSC-05: MONTHLY EQUIPMENT INVENTORY & RUN TIME

EMISSIONS & DBA LOG				
EMISSIONS DETAILS				
NAME OF EQUIPMENT	MAKE/MODEL	TOTAL HOURS 02.2026	ASSOCIATED TASK(S)	HORSEPOWER
Motor grader - YA7458	CAT - 160M	152	SITE GRADING	213
Motor grader - UH3Y84	John Deere - 872G	133	SITE GRADING	300
Scraper - LP8X36	CAT - 627G	152	GRADING	290
Scraper - LF4E58	CAT - 627G	152	GRADING	407
Scraper - NG7N78	CAT - 637R	142.5	GRADING	290
Scraper - RA3U57	CAT - 637R	150.5	GRADING	290
Paddle Wheel - 9SC106	CAT - 623H	142.5	GRADING	407
Water Truck - 2216	FREIGHTLINER - M2106	133	DUST SUPPRESSION	360
Water Truck - 2172	FREIGHTLINER - M2106	152	DUST SUPPRESSION	360
Water Truck - AY4L43	CAT - SK8SC	142.5	DUST SUPPRESSION	400
Water Truck - 10335191		28.5	DUST SUPPRESSION	360
Compactor - LB6X99	CAT - 815F2	95	GRADING	232
Dozer - YP3U33	CAT - D5	142.5	VARIOUS	170
Tractor - 11157	Jon Deere - 370 8RT	146.5	GRADING	100
Loader - YM6M43	John Deere - 744	22	GRADING	316
Skid Steer - KD8M73	JOHN DEERE - 333G	47.5	VARIOUS	96.6
Skid Steer - JK3U34	Case - TR310B	28.5	OFF SITE	74
UTV - 10442354	Kubota - X1140	60	TRAVEL	25
UTV - 10442287	Kubota - X1140	15	OFF SITE	25
UTV - 10442300	Kubota - X1140	52	TRAVEL	25
Dump Truck - 10335298	Kenworth - T270	66.5	HAULING	300
Dump Truck - 2225	FREIGHTLINER - M2106	66.5	HAULING	360
Rock Truck - WS3P73	John Deere - 460	0	HAULING	481
Excavator - XJ3X96	John Deere - 210G	9.5	EXCAVATION	159
Excavator - SW3N39	Link Belt - 245x4	57	EXCAVATION	316
Drill Rig - 2154	CAT - 330F	65	EXCAVATION	242
Mini Ex - 582	John Deere - 35P	10	EXCAVATION	23
Mini Ex - 2223	Hitachi - 35U	0	EXCAVATION	24
Forklift - RK5D38	SKYTRAK - 10042	100	LIFTING	110
Generator - 11089669	Wacker Neuson - G25	186.5	GENERATOR	32

SWITCH-GHG-01

3. AQSC-05: MONTHLY GHG-01 BEST PRACTICES REPORT

Switchyard Project – Construction Compliance Monitoring Form

Date: 02/23/26

Inspector / Supervisor: Isaac Sandoval

Project Phase: Civil Work

Weather / Conditions: Sunny

1. Carpooling & Commute Efficiency

Compliance Item	Observation / Notes	Yes	No	N/A
Workers encouraged to carpool where feasible		<input checked="" type="checkbox"/>	<input type="checkbox"/>	<input type="checkbox"/>
Carpool opportunities discussed in morning / safety briefings		<input checked="" type="checkbox"/>	<input type="checkbox"/>	<input type="checkbox"/>
Parking / staging areas support carpooling logistics		<input checked="" type="checkbox"/>	<input type="checkbox"/>	<input type="checkbox"/>

2. Vehicle Idling Minimization

Compliance Item	Observation / Notes	Yes	No	N/A
No idling beyond 5 minutes (Cal. Code Regs., Title 13 §2485)		<input checked="" type="checkbox"/>	<input type="checkbox"/>	<input type="checkbox"/>
Crews reminded of "common sense" vehicle use policy		<input checked="" type="checkbox"/>	<input type="checkbox"/>	<input type="checkbox"/>
Idle reduction policy discussed in preconstruction / safety meetings		<input checked="" type="checkbox"/>	<input type="checkbox"/>	<input type="checkbox"/>
Equipment staged efficiently to minimize idling		<input checked="" type="checkbox"/>	<input type="checkbox"/>	<input type="checkbox"/>



3. Equipment Maintenance & Emissions

Compliance Item	Observation / Notes	Yes	No	N/A
Construction equipment maintained per PG&E standards		<input checked="" type="checkbox"/>	<input type="checkbox"/>	<input type="checkbox"/>
Low-emission or electric equipment used where feasible		<input type="checkbox"/>	<input type="checkbox"/>	<input checked="" type="checkbox"/>
Portable diesel engines ≥50 hp registered under CARB PERP		<input type="checkbox"/>	<input type="checkbox"/>	<input checked="" type="checkbox"/>

4. Welding, Cutting, and Fuel Efficiency

Compliance Item	Observation / Notes	Yes	No	N/A
Mechanical/compression methods used in lieu of welding/cutting when practical		<input type="checkbox"/>	<input type="checkbox"/>	<input checked="" type="checkbox"/>
Use of natural gas-powered vehicles encouraged / implemented		<input type="checkbox"/>	<input type="checkbox"/>	<input checked="" type="checkbox"/>

Comments / Follow-Up:

Inspector Signature: Isaac Sandoval

Date: 02/23/26

WATER-06

1. SUMMARY OF MONTHLY WATER USE

February Water Consumption

Date	Day	Start Meter	End Meter	Total Acre Feet	Total Gallons
2/1/2026	Sunday				
2/2/2026	Monday	363.874	364.028	0.154	50188.6
2/3/2026	Tuesday	364.028	364.421	0.393	128078.7
2/4/2026	Wednesday	364.421	364.62	0.199	64854.1
2/5/2026	Thursday	364.62	364.821	0.201	65505.9
2/6/2026	Friday	364.821	364.99	0.169	55077.1
2/7/2026	Saturday	364.99	365.122	0.132	43018.8
2/8/2026	Sunday				
2/9/2026	Monday	365.122	365.407	0.285	92881.5
2/10/2026	Tuesday	365.407	365.615	0.208	67787.2
2/11/2026	Wednesday	365.615	365.886	0.271	88318.9
2/12/2026	Thursday	365.886	366.091	0.205	66809.5
2/13/2026	Friday	366.091	366.371	0.28	91252
2/14/2026	Saturday	366.371	366.497	0.126	41063.4
2/15/2026	Sunday				
2/16/2026	Monday	0	0	0	0
2/17/2026	Tuesday	0	0	0	0
2/18/2026	Wednesday	0	0	0	0
2/19/2026	Thursday	0	0	0	0
2/20/2026	Friday	0	0	0	0
2/21/2026	Saturday	0	0	0	0
2/22/2026	Sunday				
2/23/2026	Monday	0	0	0	0
2/24/2026	Tuesday	366.497	366.612	0.115	37478.5
2/25/2026	Wednesday	366.612	366.845	0.233	75934.7
2/26/2026	Thursday	366.845	367.126	0.281	91577.9
2/27/2026	Friday	0		0	0
2/28/2026	Saturday				
Monthly Total				3.252	1,059,826.80

WORKER-SAFETY-03

1. MONTHLY SAFETY INSPECTION

Monthly Safety Compliance Inspection Form





Project: Harlan Switch Station Location: 21055 S. Derrick Ave, Cantua Creek, CA

Month/Year: February / 2026 Inspection Date: 2/13/26

Inspected By (Construction Safety Supervisor): Isaac Sandoval

Title: Assistant Project Manager Signature: Isaac Sandoval

1. Occupational Safety & Health Program



Criteria	Compliance (✓ / ✗ / N.A.)	Comments / Corrective Actions
Safety policies and procedures are current, posted, and communicated to all personnel		
Daily tailgate and toolbox safety meetings documented		
Job Hazard Analyses (JHAs) updated for current work activities		
Emergency contact list and response plan posted on site		
First aid kits, fire extinguishers, and eyewash stations inspected and accessible		

2. Regulatory Compliance (Cal/OSHA & Federal)





Criteria	Compliance (✓ / ✗ / N.A.)	Comments / Corrective Actions
Project safety program complies with Cal/OSHA		



2. MONTHLY SAFETY INSPECTION

Title 8, Subchapter 4 (Construction Safety Orders)		
Electrical safety protocols per 29 CFR 1926 Subpart K and NFPA 70E		
Battery Energy Storage System (BESS) measures per manufacturer and Cal/OSHA GISO §5189		
PPE issued, used, and maintained per 8 CCR §3380-§3385		
Confined space, lockout/tagout, and hot work procedures in effect		





3. Training & Worker Safety

Criteria	Compliance (✓ / ✗ / N.A.)	Comments / Corrective Actions
All workers and supervisors completed site-specific safety orientation		
Cal/OSHA required training completed (Fall Protection, Heat Illness, Valley Fever, Silica)		
Documentation of safety training maintained onsite		
New employees/subcontractors briefed on hazards before starting work		







3. MONTHLY SAFETY INSPECTION

4. Incident & Emergency Reporting

Criteria	Compliance (✓ / ✗ / N.A.)	Comments / Corrective Actions
Accident and incident investigations completed within 24 hours of event		
Emergency response reports submitted to CPM as required		
Near-miss events documented and reviewed for corrective measures		
Emergency drills conducted and documented (fire, medical, evacuation)		

5. Construction Fire Protection & Prevention Program

Criteria	Compliance (✓ / ✗ / N.A.)	Comments / Corrective Actions
Applicable standards and publications identified		
Fire map includes layout, ingress/egress, drainage, grading		
Fire map identifies potential ignition sources during construction phases		
Fire map shows evacuation areas/muster points		
Construction fire protection systems identified (water		

4. MONTHLY SAFETY INSPECTION

systems, gaseous systems, extinguishers)	✓	
Construction detection and alarm systems described	✓	
List of all major fire hazards completed	✓	
Procedures for controlling flammable/combustible waste accumulation implemented	✓	
Maintenance procedures for heat-producing equipment safeguards implemented	✓	
Project personnel responsible for fuel-source hazard control identified	✓	

6. Summary and Corrective Actions

Overall Compliance Status (circle one): Satisfactory Minor Corrections Needed
Non-Compliant

Summary of Findings: Site is well kept and is following all safety regulations

Corrective Actions / Responsible Party / Completion Date: _____

Supervisor Certification

I certify that this monthly safety compliance inspection was performed in accordance with Cal/OSHA and federal safety regulations, and that all noted deficiencies will be corrected promptly.

Signature: Isaac Sandoval Date: 2/13/26



WORKER-SAFETY-03

1. TRAINING SIGN-IN SHEETS

Meeting Agenda Log

The following topics were discussed at the meeting:

- | | YES |
|---|-------------------------------------|
| 1. Valley Fever Prevention and Response | <input checked="" type="checkbox"/> |
| 2. Emergency Response and Evacuation Procedures | <input checked="" type="checkbox"/> |
| 3. Noise Pollution Training and Awareness | <input checked="" type="checkbox"/> |
| 4. Waste Management Best Practices | <input checked="" type="checkbox"/> |

I certify that these topics were covered in detail and format required by associated Conditions of Compliance and health and safety plans.

TRAINER SIGNATURE

DATE

 02/09/26

Attendance Log:

EMPLOYEE SIGNATURE

DATE



1. TRAINING SIGN-IN SHEETS

I have read and understand this plan and I agree to adhere to all safety precautions and procedures to complete this job safely.		
Name (Print)	Signature	Date
Juan Manzo	Juan Manzo	9-2-2026
Mark Santiago	Mark	02/09/2026
Robert Ponce	Rob P	2-9-26
Matthew Perez	Matthew	2-9-26
Joseluis Madrigal	Joseluis	2-9-26
Jesus M Diaz	Jesus	2-9-26
Stephan Escobedo	Stephan	2-9-26
Abhijeet Singh	Abhijeet	2/9/26
FERNANDO MORALES	Fernando	2/9/26



WORKER-SAFETY-03

2. NOISE-02: NOISE EXPOSURE LOG & MONITORING

The work performed onsite thus far has not required personnel to work for extended periods of time outside of equipment cabs and/or nearby running equipment with a standing decibel average of 85 dBA or greater.

3. WORKER-SAFETY-11: RESPIRATOR TRAINING & MONITORING

Conditions onsite have yet to reach thresholds maintained in the Harlan Switching Station Valley Fever Prevention Plan which would require mandatory respirator training, monitoring, and buddy system implementation.

4. WORKER-SAFETY-11: VALLEY FEVER SYMPTOMS AND/OR CASE REPORTING

Dashiell and its subcontractors have not encountered any suspected Valley Fever or personnel exhibiting conducive symptoms.

WORKER-SAFETY-03

5. SWITCH-HAZ-02: MONTHLY FIRE EXTINGUISHER INSPECTION

Fire Extinguisher Monthly Visual Inspection Log

Regulatory References:

- OSHA 29 CFR 1910.157(e)(2): Portable fire extinguishers must be visually inspected monthly by the employer.
- California Code of Regulations, Title 8, §6151(e)(2): Mirrors federal OSHA; requires monthly visual inspections and annual maintenance by a certified technician.
- California Fire Code (CFC) §906.2: Portable extinguishers must be maintained, inspected, and tested per NFPA 10.

Project / Facility Information

Project / Facility Name	Harland Switch Station
Location / Area	Fuel Tanks
Extinguisher ID / Tag No.	9392
Type / Rating (e.g., ABC, CO ₂ , K)	ABC
Capacity (lb)	20lb
Mounting Location / Identifier	Flagged Post

Inspection Checklist (Monthly Visual Inspection)

Inspector shall initial or check "OK" or "Deficiency" for each month.

Month	Pressuree Gauge in Green	Pin & Seal Intact	No Visible Damage / Corrosion	Label Legible	Accessible & Unobstructed	Inspection Initials / Signature	Deficiency Noted (Y/N) / Comments
January	OK	OK	OK	OK	OK	OK	OK
February	OK	OK	OK	OK	OK	OK	OK
March							
April							
May							
June							
July							



WORKER-SAFETY-03

August							
September							
October							
November	OK	OK	OK	OK	OK	OK	OK
December	OK	OK	OK	OK	OK	OK	OK

Instructions

1. Inspect each extinguisher monthly for:
 - Correct pressure (needle in green zone)
 - Secure tamper seal and pin
 - No physical damage, corrosion, leakage, or clogged nozzle
 - Clear labeling and legible instructions
 - Unobstructed access and visible signage
2. Initial and date upon completion.
3. Note any deficiencies and immediately report to site safety officer or maintenance lead.
4. Maintain this log on site for at least one year per OSHA and CFC §107.6 recordkeeping requirements.

